

# INSTALLATION AND INSTRUCTIONAL MANUAL

## PV SERIES

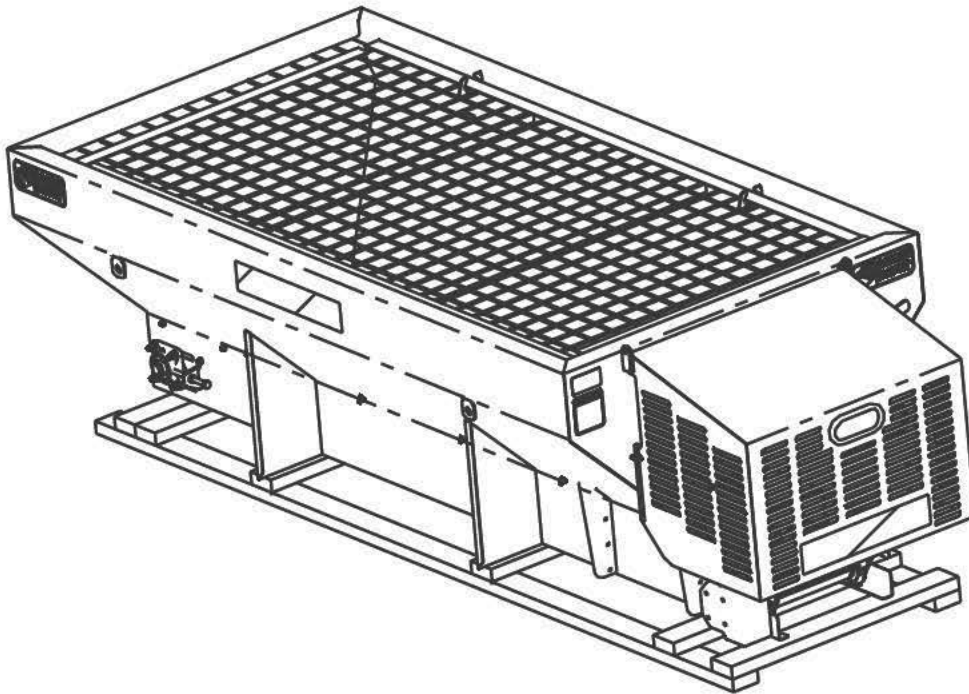

MODELS LISTED IN THIS BOOKLET  
GAS-DRIVEN (HONDA AND BRIGGS & STRATTON)  
HYDRAULIC, ELECTRIC

# INSTALLATION AND INSTRUCTIONAL MANUAL

## PV SERIES

# Contents

## INSTRUCTIONAL INFORMATION

SAFETY.....	3-4
SPREADER INSTALLATION AND ASSEMBLY INSTRUCTIONS.....	5-8
WIRELESS INSTRUCTION.....	9-13
DUAL CONTROL FLOW VALVE AND HYDRAULIC SPECIFICATION...	14-15
SPREADER OPERATION (GAS DRIVEN, HYDRAULIC, ELECTRIC).....	16-17
MAINTENANCE.....	18-19

## PARTS LISTING

GAS ENGINE MODELS (BRIGGS & STRATTON, HONDA).....	20-33
HYDRAULIC MODEL.....	34-42
ELECTRIC DUAL MOTOR MODEL.....	43-59
PARTS TABLE (multi-conditional parts).....	60-61
GEARBOX.....	62-63
SPINNER ASSEMBLIES (SHORT, INTER., EXT, ).....	64-69

## RECORDS AND WARRANTY INFORMATION

NAMEPLATE INFORMATION.....	70
WARRANTY.....	71

# INSTALLATION AND INSTRUCTIONAL MANUAL

## PV SERIES

### THE BEST SAFETY DEVICE IS A CAREFUL OPERATOR SAFETY ALERT SYMBOL



THIS SYMBOL MEANS ATTENTION!  
BECOME ALERT!  
YOUR SAFETY IS INVOLVED!  
PLEASE READ AND UNDERSTAND COMPLETELY BEFORE DO-  
ING!

### SAFE EQUIPMENT INSTALLERS and OPERATORS:



TURN OFF ALL POWER BEFORE PERFORMING ANY SERVICE OPERATIONS

- FOLLOW RECOMMENDED OPERATING PROCEDURES.
- KEEP EQUIPMENT IN SAFE OPERATING CONDITION AT ALL TIMES.
- RECOGNIZE AND AVOID HAZARDS WHILE OPERATING, SERVICING AND MAINTAINING EQUIPMENT.



NOTICE: INSTRUCTIONAL MATERIAL AND PARTS LISTS INCLUDED IN THIS MANUAL ARE SUBJECT TO CHANGE WITHOUT NOTICE.

# INSTALLATION AND INSTRUCTIONAL MANUAL

## PV SERIES



### **WARNING**

**USE SAFETY GLASSES OR OTHER FACE PROTECTION AGAINST POSSIBLE BATTERY EXPLOSION. DO NOT SMOKE AND AVOID OTHER SOURCES OF IGNITION.**



### **WARNING**

Never operate machine with engine shroud in the upright position. Never climb into hopper while the engine is operating or capable of being operated.

**SERIOUS INJURY or DEATH MIGHT OCCUR.**

**NOTE: Read and fully understand the owners manual supplied by the engine manufacturer before operating this equipment. Not doing so, endangers your safety and the warranty of the engine.**

# INSTALLATION AND INSTRUCTIONAL MANUAL

## PV SERIES

### ENGINE COVER PROP ROD INSTRUCTIONS



## WARNING

To prevent injury extreme caution must be used when opening, closing, or working under or near the engine cover. To prevent the engine cover from falling the prop rod must be fully engaged into the proper hole. Never operate or transport the spreader with the engine cover open.

Some maintenance procedures may require the engine cover to be completely removed from the spreader to allow full access to the gasoline engine or other components. The engine cover must be reinstalled and in the closed position before starting engine or operating spreader.

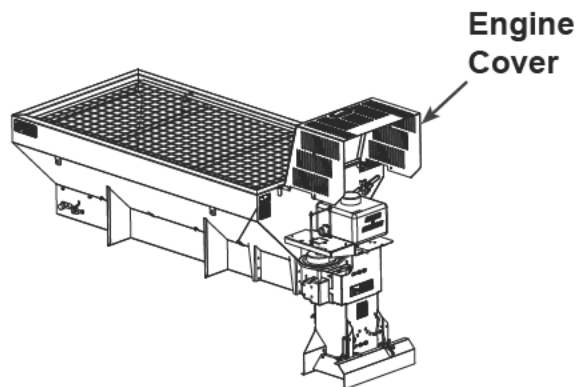

1. Raise engine cover.

2. Locate the prop rod and remove it from the plastic retainer allowing the prop rod to swing down.

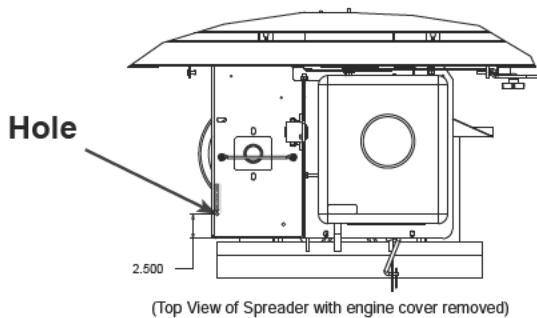

3. Locate the hole on the spreader marked “insert prop rod here” and slowly lower the engine cover until the prop rod fully engages in to this hole.

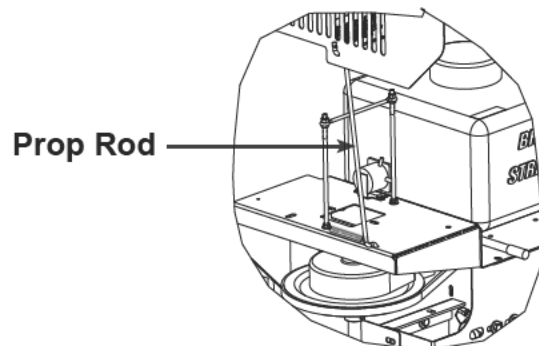

4. Carefully release the engine cover while ensuring it is being solidly supported by the prop rod.

# INSTALLATION AND INSTRUCTIONAL MANUAL

## PV SERIES

### INSTALLATION INSTRUCTIONS CENTER HIGH MOUNT STOP LAMP (CHMSL)

#### ELECTRICAL CONNECTIONS FOR AUXILIARY CHMSL:



#### WARNING

FEDERAL MOTOR VEHICLE SAFETY STANDARDS REQUIRE ALL TRUCKS, BUSES AND MULTIPURPOSE PASSENGER VEHICLES MANUFACTURED ON OR AFTER 5/1/1993, WITH A GROSS VEHICLE WEIGHT RATING (GVWR) OF 10,000 LBS. OR LESS AND OVERALL WIDTH LESS THAN 80" BE EQUIPPED WITH A CENTER HIGH MOUNT STOP LAMP.

#### NOTE:

If the original equipment CHMSL is obscured, an auxiliary CHMSL must be installed to bring the vehicle back into compliance with Federal Regulations.

1. Use high quality butt connectors and shrink wrap on all electrical splice connections. Wire should be routed and secured to protect against abrasion, sharp edges, and excessive movement. It is highly recommended that wiring be placed in convoluted tubing and secured with tie wraps
2. When drilling holes, any bare metal should be coated with a rust preventative; use appropriate size grommets and seal hole with appropriate sealant.
3. Allow for normal movement/twisting between cab and chassis/pickup box when routing wires.
4. When spreader is removed from the truck, the OEM CHMSL must be reconnected.

**IMPROPER CONNECTIONS COULD RESULT IN A VARIETY OF PROBLEMS AFFECTING CRITICAL SYSTEMS SUCH AS BRAKING, ELECTRICAL AND EMISSION! DON'T GUESS!**

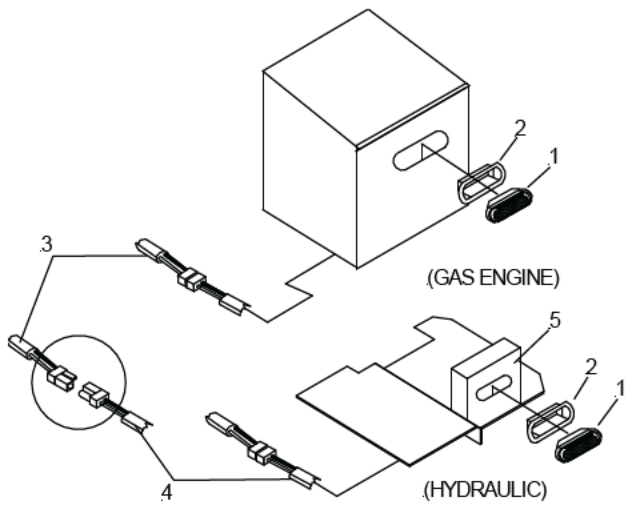

#### WARNING!

CONSULT THE TRUCK MANUFACTURER FOR AN APPROVED METHOD OF CONNECTING AN AUXILIARY CHMSL TO A PARTICULAR TRUCK WHICH IS TO CARRY THE SPREADER. METHODS VARY WITH TRUCK MODELS, OPTIONAL EQUIPMENT AND YEARS OF MANUFACTURER.

<u>Item</u>	<u>Part Number</u>	<u>Qty.</u>	<u>Description</u>
1	04605-153-00	1	Lamp, Stop
2	04605-154-00	1	Grommet, Mounting
3	04605-155-00	1	Cable, Light Power (Hopper)
4	04616-075-00	1	Cable, Stop Lamp Power (Truck)
5	00119-878-00	1	Forming, Rear Stop Light Bracket
	00119-878-01		CS (Hydraulic units only)
			Stainless steel bracket.



# INSTALLATION AND INSTRUCTIONAL MANUAL

## PV SERIES

### INSTALLATION AND ASSEMBLY INSTRUCTIONS



#### CAUTION!

**READ ALL OF THE INSTALLATION INSTRUCTIONS BEFORE STARTING.**

#### INSTALLATION INSTRUCTIONS:

The PV Series Spreader can be mounted and stored as a single unit. The PV Series Spreader will mount on most medium or heavy-duty pickup trucks as well as 1 ton trucks (with optional extended spinner).



#### WARNING!

**THE SPREADER UNIT MUST BE SECURELY FASTENED TO THE VEHICLE. FAILURE TO PROPERLY RESTRAIN THE UNIT COULD PERMIT THE UNIT TO BREAK FREE FROM THE TRUCK AND CREATE THE POTENTIAL FOR A LIFE THREATENING ACCIDENT.**

#### DO NOT OVERLOAD THE VEHICLE

It is quite possible to overload the vehicle by improperly mounting or overloading the spreader. This could result in dangerous stability and braking problems. Always consult and follow the vehicle manufacturer's recommendations before attempting these instructions.



#### WARNING!

**BEFORE BEGINNING ANY INSTALLATION ON THIS UNIT, DISCONNECT THE SPREADER AND VEHICLE NEGATIVE BATTERY CABLES.**



#### CAUTION!

**BEFORE STARTING, VERIFY THAT THIS MOUNTING METHOD IS ACCEPTABLE TO THE VEHICLE MANUFACTURER.**

1. Place the spreader in the rear of the truck with the engine/motor to the rear of the truck. Center the spreader(side to side) in the truck.

2. Attach or lower spinner assembly.



#### CAUTION!

**ENSURE THE SPREADER CANNOT TIP WHEN THE SPINNER ASSEMBLY IS ATTACHED.**

3. Position the spreader in the truck bed, just short of making contact with the rear most part of the truck bed, bumper, pintle hook etc. Bolt the unit to the truck using a minimum of four (4) 1/2" Grade 5 bolts and corresponding washers and locknuts. The spreader is designed to sit flat on the bed of the truck, supported by the longitudinal sides.

**DO NOT SUPPORT THE SPREADER BY THE BODY JACKS ALONE! UNIT IS NOT DESIGNED FOR CHASSIS MOUNT APPLICATIONS!**



#### CAUTION!

**DO NOT SUPPORT THE SPREADER BY THE BODY JACKS ALONE! UNIT IS NOT DESIGNED FOR CHASSIS MOUNT APPLICATIONS.!**

5. Attach the hold down at each corner of the hopper as shown. Locate and drill four .531(17/32") diameter holes for eyebolts in the truck bed. Straps must be positioned at opposing angles so that the spreader cannot slide forward or rearward. Assemble ratchet/strap to eye bolts. Tighten hold downs evenly. Do not overtighten, damage will result to the spreader or the truck.

**Note: If vehicle is equipped with sufficient tie downs, they may be used in place of eyebolts.**

# INSTALLATION AND INSTRUCTIONAL MANUAL

## PV SERIES

### OPTIONAL HOLD-DOWN KIT Part No. 62562 (00002-306-00)

ITEM	PART NUMBER		QTY.	DESCRIPTION
1		04068-038-00	4	Ratchet/Strap
2		04048-504-02	4	Bolt, 1/2" Eye
3		04003-804-06	4	Locknut, 1/2-13 Esna ZP
4		04003-801-11	4	Nut, 1/2-13 Hex ZP
5		04004-002-16	8	Flatwasher, 3/4"

### INSTALLATION INSTRUCTIONS

#### CAUTION

#### READ ALL THE INSTALLATION INSTRUCTIONS BEFORE STARTING

**Before starting, verify that this mounting is acceptable to the vehicle manufacturer.**

Attach the hold down at each corner of hopper as shown. Locate and drill four .531 (17/32") diameter holes for eye-bolts in the truck bed (position may vary from that shown). Straps must be positioned at opposing angles so that spreader cannot slide forward or rearward. Mount eye-bolts as shown, with locknuts and flatwashers on the bottom side. Assemble ratchet/strap to eye-bolts. Tighten hold downs evenly. Do not over tighten damage will result to the spreader or the truck.

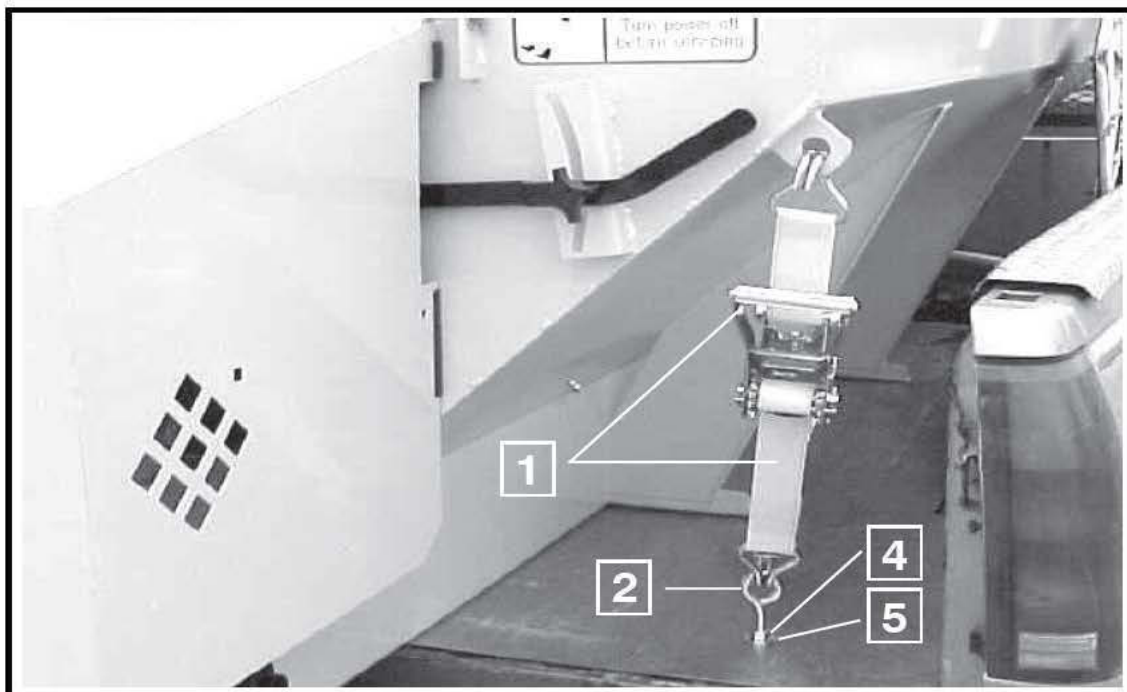



# INSTALLATION AND INSTRUCTIONAL MANUAL

## PV SERIES

### SPREADER OPERATION

#### Standard Wireless Throttle Control Button Functions (Sequence of Operations)



- A. ON/Off System power activated (ready to start). Spreader engine not running. Spreader conveyor is not engaged.

B. START (Engine Only)

1. Open fuel shut off valve on engine. CHOKE (Cold engine.) Hold down for 5 seconds to move the throttle actuator to the choke position.

**NOTE: Choking a warm engine may not be necessary.**

2. START Hold down button until engine starts.
3. TURTLE Decreases throttle speed - adjust as engine warms up. Will stop the choke function.
- RABBIT Increases throttle speed.

C. TO ENGAGE SPREADER CONVEYOR

1. CONVEYOR Push CONVEYOR switch only after you are sure no one is in the hopper or near the spinner!

D. TO CONTROL CONVEYOR SPEED

1. RABBIT Hold RABBIT to increase speed.

**Note** **DO NOT** hold switch in **HI** position after the desired RPM is achieved or you will choke and/or stall the engine.

2. TURTLE Hold TURTLE to decrease speed.

E. TO DISENGAGE SPREADER CONVEYOR

1. CONVEYOR Push conveyor button.

- F. TO TURN ENGINE OFF (With or without conveyor running).

1. TURTLE Push throttle slow button to reduce setting to idle (this prevents engine flooding and hard starting).
2. STOP Push STOP button and hold 5 seconds.

**NOTE: OFF can be pushed at anytime during spreader operation to cut power to the unit; however, you should normally use steps under F above.**

- G. Do not attempt to start the engine with the conveyor engaged.

- H. Close fuel shut off valve on engine if unit is to be transported while not running.



#### **WARNING!**

1. As with all power equipment, safety is the number one concern.
2. Do not operate this equipment until you fully understand how it functions.
3. Before starting engine, be sure that no one is near the rear of the unit and that no one is inside the unit!
4. Do not start the engine or engage the conveyor (which is interconnected to the spinner) until everyone is clear from moving parts and flying material from the spinner.

# INSTALLATION AND INSTRUCTIONAL MANUAL

## PV SERIES

### Swenson Spreader Standard Wireless Controller

#### For use with Gas Engine packages

The wireless controller is a compact unit with two parts. One part is the **Base Unit (Receiver)** and the other part is the **Transmitter (Hand Held Controller)**. The Transmitter is used to send a corresponding signal to the Base Unit to act as a remote switching device.

#### Set-up and Operation

The Swenson Wireless Controller comes factory programmed. That means matching the Base Unit to the Transmitter has been done by Swenson Spreader. This gives a matched (1 of 16 million combinations @ 418MHz) interface between the Transmitter and Base Unit. See Figures 1 & 2 for Transmitter button assignments. On the 8 button Swenson Spreader Transmitter, all (8) buttons are used when programming. When programming is completed, only (5) buttons are functional (Buttons #1, #3, #4, #5, & #6) (see Fig. 1).

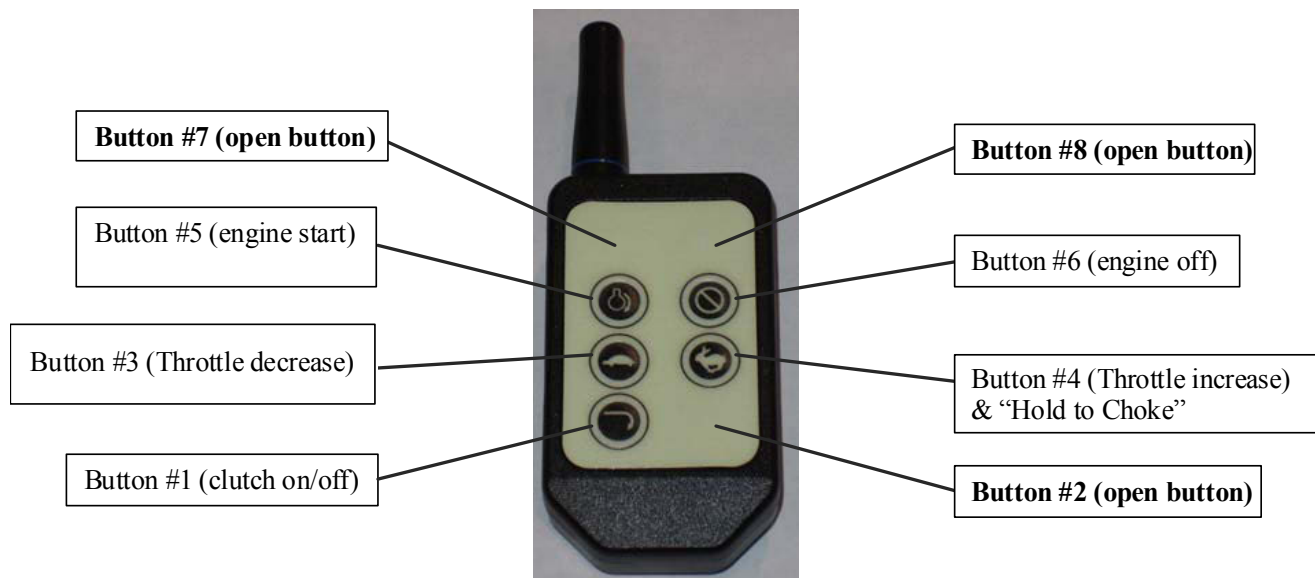

**Fig. 1: Transmitter Front Button Assignments**



**Fig. 2: Transmitter Back Button Assignments**

# INSTALLATION AND INSTRUCTIONAL MANUAL

## PV SERIES

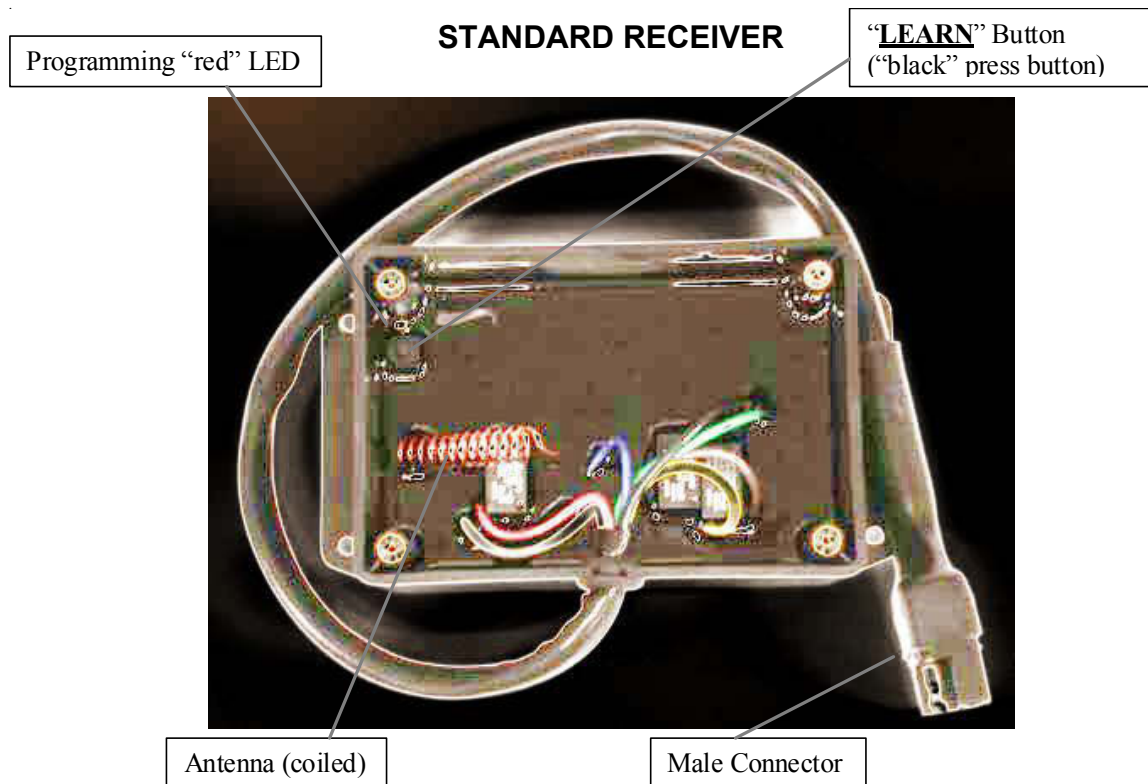

Fig. 3: Base Unit layout (Figure shown without Base Unit Cover)

### **Programming/Reprogramming the Transmitter and the Base Unit:**

Tools needed: A small "phillips" screwdriver and a small diameter pin (paper clip).

Instructions to program Transmitter and Base Unit:

1. Remove (4) screws and cover on Base Unit.
2. Power-up the Base Unit. Connect a 12V power source to the spreader 12V battery terminals and plug the engine wire harness to the Base Unit wire harness (see Male Connector in Fig. 3). **DO NOT DISCONNECT THE BATTERY TERMINALS** from the 12V source when engine is running.
3. On the backside of the Transmitter depress the "**ADD**" button (see Fig. 2) using a small pin or paper clip – You will see a "blue" LED start to blink (for approximately 15-17 seconds).
4. On the front side of the Transmitter press all (8) buttons (see Fig. 1). There is no certain order to press the buttons. Firmly press each button, separately. Perform this step before the 15-17 seconds are up (before "blue" LED stops blinking). The Transmitter is now programmed and has created its own 1 in 16 million address. Once the "blue" LED stops blinking, this step is completed.
5. On the Base Unit (see Fig. 3) press the black "**LEARN**" button. The "red" LED will start to blink (for approximately 15-17 seconds).
6. On the front side of the Transmitter you only need to press Button #1 (clutch on/off), once. Perform this step before the 15-17 seconds are up (before "red" LED stops blinking). The base unit has now recognized the Transmitters unique 1 in 16 million address. Once the "red" LED stops blinking, this step is completed.
7. Verify the (5) functional buttons (Buttons #1, #3, #4, #5, & #6) on the Transmitter are working with the Spreader Unit by pressing each button, individually (the Base Unit "red" LED will flash when a Transmitter button is pressed). If Transmitter buttons are not working, repeat steps 3 – 8 or see the Trouble shooting directions.
8. When Transmitter buttons are functioning properly, re-assemble the Cover on the Base Unit with the (4) screws. Your Swenson Wireless Controller is now ready to use!

# INSTALLATION AND INSTRUCTIONAL MANUAL

## PV SERIES

### Transmitter Battery Replacement

The Transmitter uses a standard CR2032 lithium button cell battery. In normal use it will provide 1 to 2 years of operation. To replace the Transmitter battery, gently press and slide the battery cover off. Remove the battery by sliding (NOT lifting) it out from underneath the retainer (see Fig. 4). Observe the battery polarity when replacing (“+” showing face up).

Notes:

1. If the battery loses power or is removed the Transmitter and Base Unit may need to be reprogrammed (see reprogramming Transmitter and Base Unit instructions). Check Transmitter functional buttons to verify if reprogramming is necessary.
2. When removing lithium battery, please use caution to slide not lift the battery from the controller! If excess force is used to remove the battery (example: lifting the battery with a small screw driver) – the solder connections from the battery clip to the circuit board could be pried loose. This action is not covered under warranty.

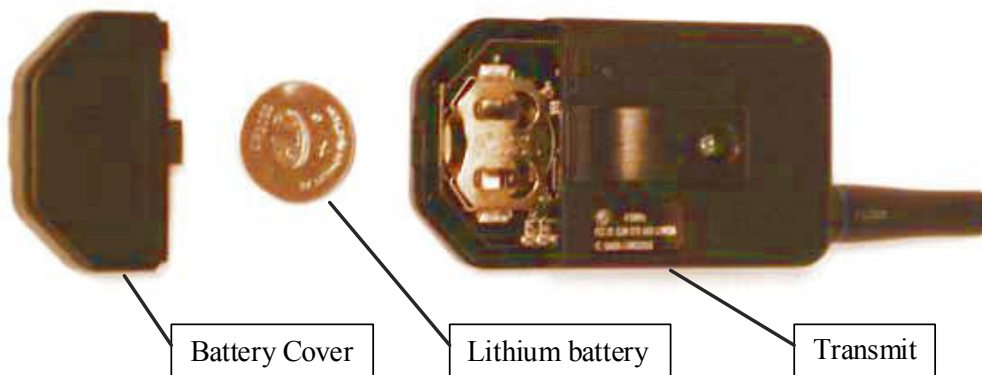

**Fig. 4: Back of Transmitter with back cover and battery removed**

### Other Considerations

1. **Powering off the engine will not automatically power off the Clutch** (engagement of conveyor/spinner). If clutch remains engaged, after engine is turned off, it could lead to a slow electrical drain on the 12V battery. (Gas engine models only)
2. **If an unregulated voltage** (example: sparking the battery cable terminal to the 12V battery post.) **is sent to the Base Unit it could erase the Base Unit programming.** The remote may show signs of no longer working with the Base Unit. Reprogramming will be required. When 14Amps are supplied the Base Unit circuit board is designed to shut off. See additional trouble shooting comments.
3. **Only one transmitter at a time can be activated within a reception area.** Only one carrier of a particular frequency may occupy the same airspace at a given time. This means that if two transmitters are activated in the same area at the same time the signals will interfere and the decoder on the receiver will not see a valid transmission and the wireless controller will not function.
4. **Multiple Transmitters** can be programmed to (1) Base Unit.
5. To verify the Base Unit is receiving a signal from the Transmitter. Press a button on the Transmitter - “red” LED on the Base Unit will light-up.
6. Swenson Spreader, LLC has no control over the intended usage of this product. Because of that Swenson Spreader, LLC offers no written or expressed liability as to how this product is used. Swenson Spreader, LLC recommends that these units are intended for OFF ROAD USE ONLY!

# INSTALLATION AND INSTRUCTIONAL MANUAL

## PV SERIES

### **TROUBLE SHOOTING**

1. **To verify the Transmitter and Base Unit are working together:** Once the base unit has power the “red” LED will come on when the Transmitter buttons are depressed (Cover of Base Unit will need to be removed to see “red” LED). If the “red” LED does not come on, the Base Unit is NOT getting a signal from the Transmitter.

*Possible Solutions:*

- A. Reprogramming the Transmitter and Base Unit might be required.
- B. Base Unit might not be functioning properly (see Base Unit trouble shooting below).
- C. Transmitter might not be functioning properly. (see Transmitter trouble shooting below).

2. **Base Unit Programming Lose:** If an unregulated voltage (spark) is sent to the Base Unit from a power source the Base Unit could lose its programming. The voltage spike will not damage the Base Unit or Transmitter. Unregulated voltage could generate from the following:
  - Connecting battery cables to a 12V battery source.
  - Jump starting the 12V battery.(Gas engine models only)
  - Charging the 12V battery.
  - Pull-starting the engine.(Gas engine models only)

*Possible Solutions:*

- A. Reprogramming the Transmitter and Base Unit may be required.
- B. Base Unit might be damaged, a new Base Unit & Transmitter will need to be ordered.

3. **Base Unit does not function properly:** (example: “red” LED will not light up when “**LEARN**” button is depressed on Base Unit).

*Possible Solutions:*

- A. Check/verify voltage of 12V is being supplied by the 12V battery. Lower voltages than 12V will not allow the Base Unit to function properly.
- B. Confirm all wires on engine wire harness are secure and properly connected.
- C. Base Unit could be damaged, a new Base Unit & Transmitter will need to be ordered.

4. **Transmitter does not have power:** (example: “blue” LED will not light up when “**ADD**” button is depressed on Transmitter).

*Possible Solutions:*

- A. Verify tool diameter (example: paperclip) to depress Transmitter “**ADD**” button is small enough to enter the “**ADD**” button hole.
- B. Verify the lithium button cell battery polarity is correct (“+” will be facing up).
- C. If the Transmitter is 1-2 years old, check the lithium battery voltage with a meter or replace the battery as needed (CR2032 lithium button cell battery).
- D. Transmitter could be damaged, a new Transmitter will need to be ordered.

5. **General troubleshooting:**

- A. Try to Program/reprogram the Transmitter and Base Unit.
- B. Verify the Ground wires (all wires) are secure.
- C. Check connections to the components that the unit is trying to operate using a voltmeter.

### **WARNING**

1. **Disconnecting 12V Battery Cables/Terminals:**
  - A. DO NOT DISCONNECT THE BATTERY (CABLES/TERMINALS) WHEN THE ENGINE/MOTOR IS RUNNING. This could disable or permanently damage the Base Unit.

For further technical assistance please contact Swenson Spreader, LLC at (888) 825-7323 or visit us at [www.swensonspreader.com](http://www.swensonspreader.com) to download updated Wireless Controller Instructions.

# INSTALLATION AND INSTRUCTIONAL MANUAL

## PV SERIES

### SINGLE FLOW CONTROL VALVE

61190  
(04105-306-00)

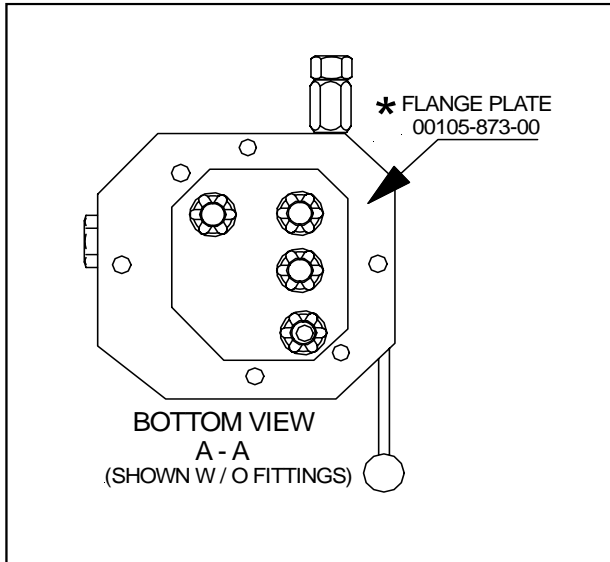

### **DUAL FLOW VALVE/STAND INSTALLATION INSTRUCTIONS**

1. **IMPORTANT:** A pipe joint sealant compatible with hydraulic oil must be applied to all screw fittings. (Teflon Tape Sealant Is Not Recommended)
2. Hose ends connected to flow valve must be of the "swivel" type.
3. **CAUTION:** Over tightening of the fittings in flow valve may cause damage to valve body.
4. Approximately 8" of hose slack must be realized between the flow valve and valve stand after the flow valve has been completely plumbed. If this condition does not exist after the plumbing has been completed, removal of valve will require hoses to be removed at opposite end of valve.
5. Assembly of valve on stand:

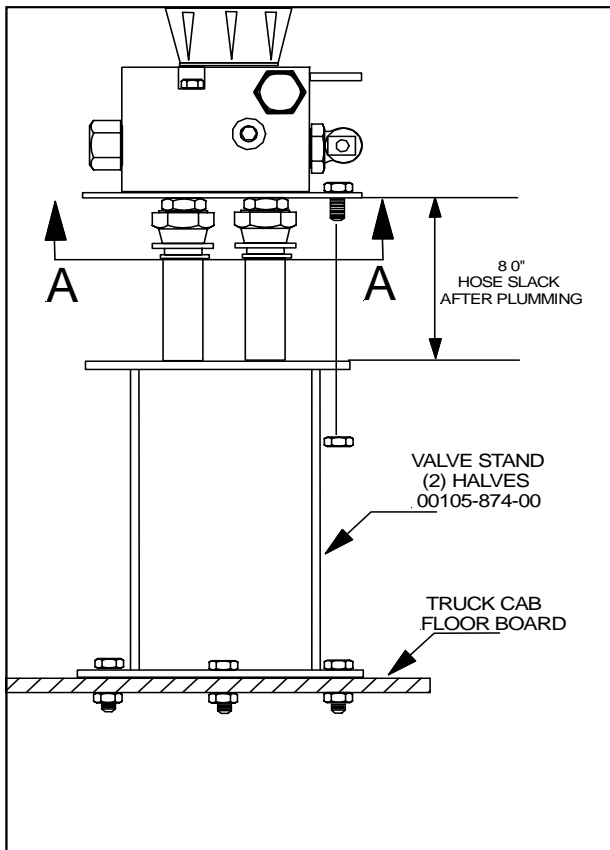

- a. Cut a 5" x 5" square opening in floor board of truck where the valve stand is to be located.
- b. Bolt valve stand halves together forming a "box" over the 5" x 5" square opening. NOTE: When bolting valve stand halves in place, make sure holes in flanges align with holes in flange plate."\*\*"
- c. Bolt flange plate to VALVE (Use (2) 1/4" x 3" bolts, lockwashers, etc.)
- d. Insert hoses through floor opening and valve stand and connect appropriate hoses (see instructions #1 thru #4) to flow valve.
- e. Bolt flange plate to valve stand flanges.



# INSTALLATION AND INSTRUCTIONAL MANUAL

## PV SERIES

### HYDRAULICS



#### WARNING

**LEAKING HIGH PRESSURE FLUIDS CAN INJECT THEMSELVES UNDER THE SKIN OF PERSONS NEAR A LEAK, CREATING GRAVE MEDICAL RISKS. TAKE CARE TO AVOID EXPOSURE TO HIGH PRESSURE FLUIDS.**

1. Hydraulic components should be kept as clean as possible during assembly operations.
2. Galvanized pipe and pipe fittings must not be used because flaking or galvanizing material can cause damage to major hydraulic components.
3. A pipe joint sealant, compatible with hydraulic oil, must be applied to all screwed fittings. (Teflon tape is not recommended.)
4. Hose should be protected where severe wear may be caused by vibration or sliding movement.
5. Long runs of hose should be supported by tie wiring or clamping.
6. Pressure and return hoses, connected to hydraulic motors, may be reversed for proper motor rotation. Spinner rotates in a clockwise direction when looking down from top.
7. Use hose manufacturer's recommendations for fitting re-useable hose ends.
8. Hydraulic pumps must be mounted so shaft rotates in direction of arrow.
9. Locate reservoir as close to pump as possible. It may be installed on truck frame or truck box.
10. Hydraulic return line filter is screwed directly onto reservoir with cartridge down. Oil must flow through filter in direction of arrow on filter.
11. Install the quick connect couplings so that when disconnected, there is a male and female on the truck as well as on the spreader. This way, hoses will always be hooked up properly. and hose ends can be coupled together when spreader is in storage to prevent system contamination.
12. See page 13 for valve assembly
13. Operate hydraulic system for several minutes to warm up. Check all connections for leaks.
14. After running, refill reservoir to three fourths full.

#### CONTROL AND HYDRAULIC SYSTEM SPECIFICATIONS

- \* Hydraulic Oil ..... Good Grade of MS10W Hydraulic Oil Which has wear, oxidation and foam inhibitors.
- \* Oil Filter ..... 10 Micron Element Return Line Filter.
- \* Relief Valve Setting ..... 1500 PSI
- \* Oil Flow ..... 0 - 10 GPM

# INSTALLATION AND INSTRUCTIONAL MANUAL

## PV SERIES

### SPREADER OPERATION

- A. Start the engine and engage the clutch. The amount of material spread, depends on engine speed and gate opening. Decreasing RPM and/or gate height will decrease amount spread; the inverse holds true also. Notice that the electric clutch can be engaged or disengaged at any time and at any engine RPM. However, since engagement time and torque is almost instantaneous, to prevent premature spinner chain failure and chain tension loss, it is recommended that the electric clutch be engaged at the lowest possible RPM without stalling the engine.

**If the truck is to be driven for an extended period of time while the spreader is not operating, it is RECOMMENDED to turn off the gas at the carburetor inlet to prevent the carburetor from over filling with fuel.**

Before loading the spreader the first time, start and stop the conveyor several times to break in the clutch.



### WARNING

**ALWAYS STAND AT A SAFE DISTANCE AWAY FROM THE SPINNER WHILE OPERATING  
ALWAYS WEAR EYE PROTECTION WHEN OUTSIDE OF THE TRUCK CAB WHILE  
SPREADER IS RUNNING.**

- B. Spread pattern depends on baffle settings and spinner RPM. Maximum spreader width is 30 ft.
1. Speeding up or slowing down the engine will increase or decrease spread pattern width.
  2. Internal baffle adjustments will move the spread pattern to the right or left.
  3. External baffle adjustments will block spreading to the right or left side.

DESIRED SPREAD PATTERN	BAFFLE SETTING	
	INTERNAL	EXTERNAL
CENTERED BEHIND TRUCK	BOTH DOWN	ALL THREE UP
BEHIND TRUCK AND LEFT	RH - DOWN LH - UP	RH - DOWN LH - UP
BEHIND TRUCK AND RIGHT	RH - UP LH - DOWN	RH - UP LH - DOWN
WINDROW BEHIND TRUCK	RH - DOWN LH - DOWN	ALL - DOWN

4. External Baffles can be lowered to an intermediate position to baffle down the particles that may otherwise leave the spinner at a high trajectory.

# INSTALLATION AND INSTRUCTIONAL MANUAL

## PV SERIES

### SPREADER OPERATION

- A. Start the engine and engage the clutch. The amount of material spread, depends on engine speed and gate opening. Decreasing RPM and/or gate height will decrease amount spread; the inverse holds true also. Notice that the electric clutch can be engaged or disengaged at any time and at any engine RPM. However, since engagement time and torque is almost instantaneous, to prevent premature spinner chain failure and chain tension loss, it is recommended that the electric clutch be engaged at the lowest possible RPM without stalling the engine.

**If the truck is to be driven for an extended period of time while the spreader is not operating, it is RECOMMENDED to turn off the gas at the carburetor inlet to prevent the carburetor from over filling with fuel.**

Before loading the spreader the first time, start and stop the conveyor several times to break in the clutch.



### WARNING

**ALWAYS STAND AT A SAFE DISTANCE AWAY FROM THE SPINNER WHILE OPERATING  
ALWAYS WEAR EYE PROTECTION WHEN OUTSIDE OF THE TRUCK CAB WHILE  
SPREADER IS RUNNING.**

# INSTALLATION AND INSTRUCTIONAL MANUAL

## PV SERIES

### MAINTENANCE



### WARNING

To prevent injury extreme caution must be used when opening, closing, or working under or near the engine cover. To prevent the engine cover from falling the prop rod must be fully engaged into the proper hole. Never operate or transport the spreader with the engine cover open.

Some maintenance procedures may require the engine cover to be completely removed from the spreader to allow full access to the gasoline engine or other components. The engine cover must be reinstalled and in the closed position before starting engine or operating spreader.

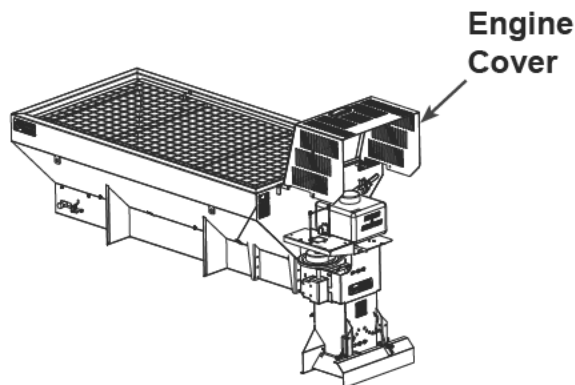

1. Raise engine cover.

2. Locate the prop rod and remove it from the plastic retainer allowing the prop rod to swing down.

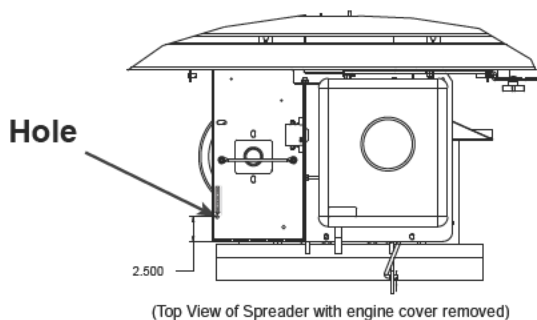

(Top View of Spreader with engine cover removed)

3. Locate the hole on the spreader marked “insert prop rod here” and slowly lower the engine cover until the prop rod fully engages in to this hole.

**INSERT PROP ROD HERE**

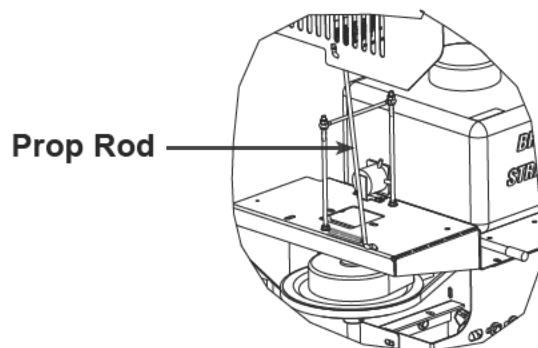

4. Carefully release the engine cover while ensuring it is being solidly supported by the prop rod.

# INSTALLATION AND INSTRUCTIONAL MANUAL

## PV SERIES

### MAINTENANCE



### WARNING

**DO NOT ATTEMPT TO LIFT THE SPREADER BY THE CENTER LIFT OR CORNER LIFT HOOKS WITH MATERIAL IN THE SPREADER.**

**BEFORE BEGINNING ANY MAINTENANCE ON SPREADER, DISCONNECT SPREADER BATTERY LEADS.**

1. Grease idler bearings on idler shaft takeup assembly, outboard bearing on gearbox output shaft, and lower spinner bearing every ten hours of operation.
2. Grease input shaft bearing on gearbox every fifty hours of operation. **CAUTION!** Over greasing may cause seal damage. The gearbox must be filled to oil level plug with SAE 90 gear type lubricant. Keep breather plug clean.
3. Drag chain slack on V-boxes should be checked periodically and taken up if distance between center line of rear sprocket and point where chain contacts lower flange on longitudinal is less than eight (8) inches. **CAUTION!** Over tightening conveyor chain can cause serious drive train problems. Above distance must not exceed 20 inches.
4. If the spreader is equipped with a gasoline engine, it should be maintained per engine manufacturer's instruction. (Instructions and parts book is enclosed.)
5. V-belt tension must be maintained. The v-belt can be tightened by loosening engine hold-down bolts and sliding engine as required. **CAUTION!** Over tightening of v-belt may damage gearbox.
6. Roller chain tension must be maintained. It is adjusted by loosening the spinner mounting bearings and sliding the bearings. Make sure the spinner shaft is straight up and down before retightening. Oil chain often and at end of season.
7. When the box is not in use, it should be washed out. If the box is put in storage, all surfaces should be oiled or painted after washing.
8. For HYDRAULIC SPREADERS, maintain oil level three fourths (3/4) full in reservoir with clean high grade non-foaming hydraulic oil; recommended viscosity 100-200 SSU. Operating temperature should be limited to 180°F. Replace filter cartridge No. 62382 (04104 005 00) at least twice a year.
9. If chain becomes stuck or "froze" to the floor to the point where the clutch cannot pull the load, never attempt to free chain using a pipe wrench or any other tool on the output shaft. The gearbox is designed to accept torque from input shaft only. Trying to turn output shaft will strip the gears, thus voiding the warranty.
10. To minimize problems and extend the life of the Electric Clutch, the following is highly recommended.
  - a. Before starting unit, make sure the drag chain is free (not stuck or "froze" to the floor). If the drag chain is stuck, this can cause the clutch to burnup.
  - b. After the using season is over, remove clutch from unit, and clean thoroughly.
  - c. After cleaning, coat both mating surfaces of the clutch with oil or light weight grease.

**NOTE:** The Oil or Grease must be removed prior to the next using season.

# INSTALLATION AND INSTRUCTIONAL MANUAL

## PV SERIES

### STANDARD PV MODEL

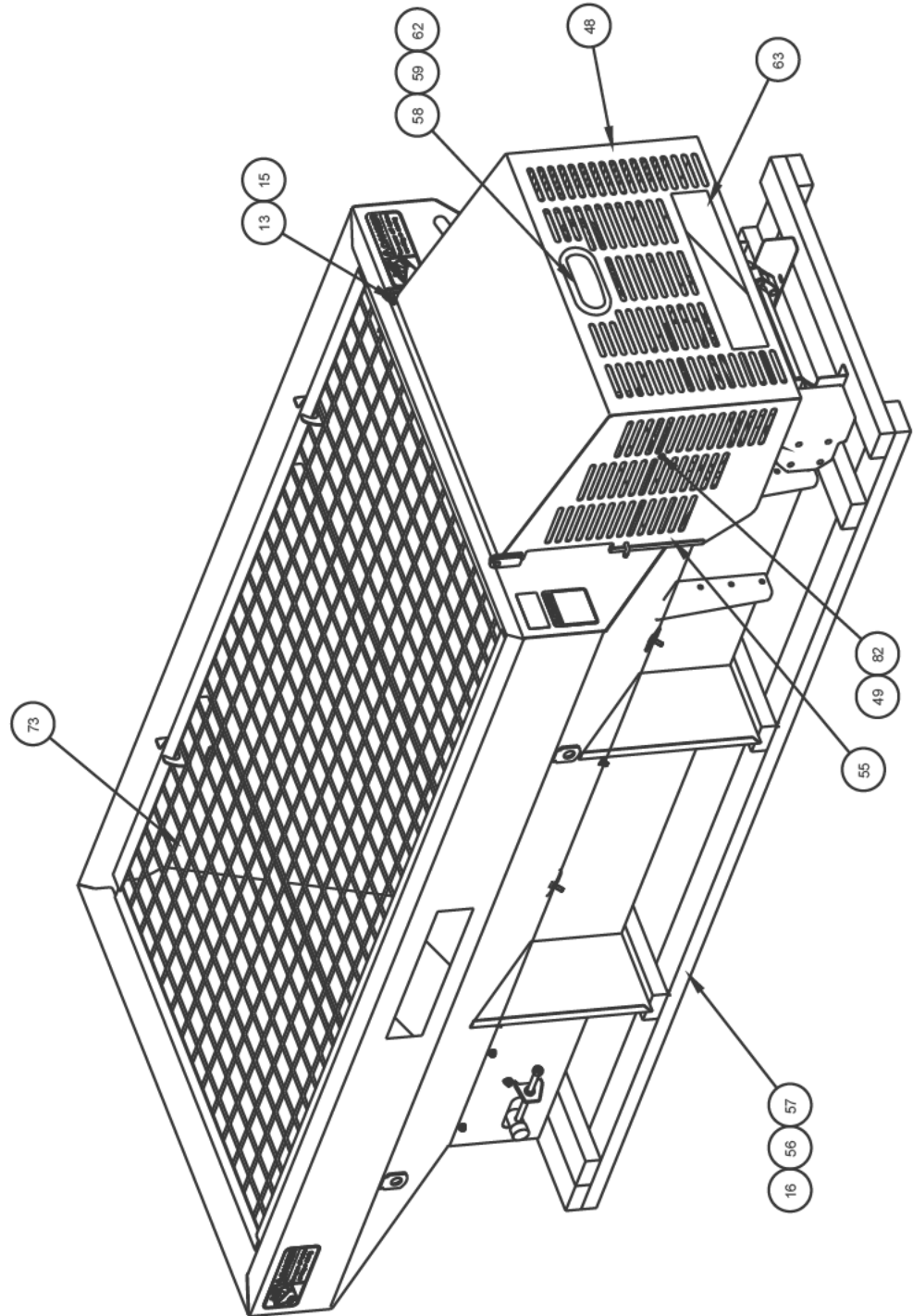



# INSTALLATION AND INSTRUCTIONAL MANUAL

## PV SERIES

### STANDARD PV MODEL

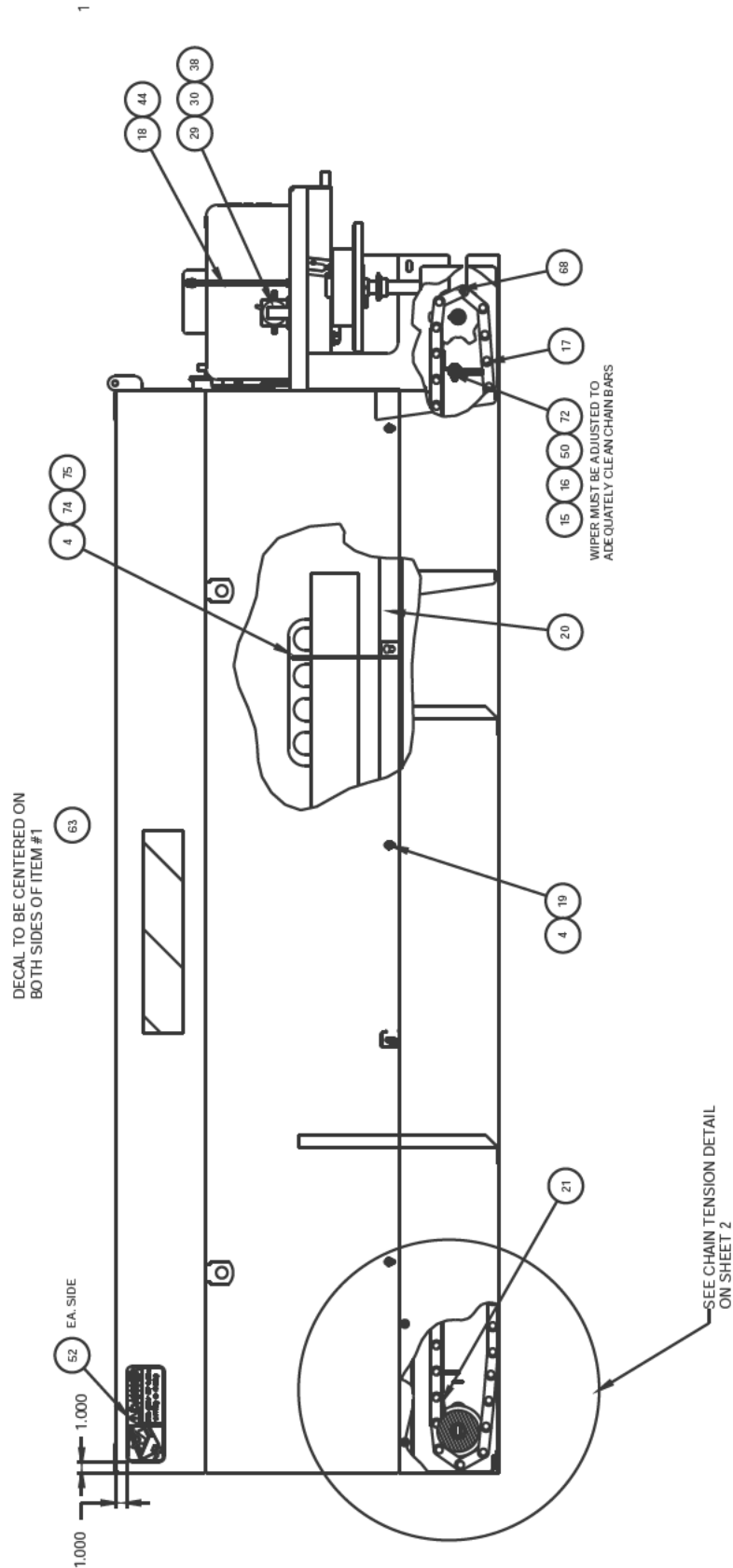



# INSTALLATION AND INSTRUCTIONAL MANUAL

## PV SERIES

### STANDARD PV MODEL

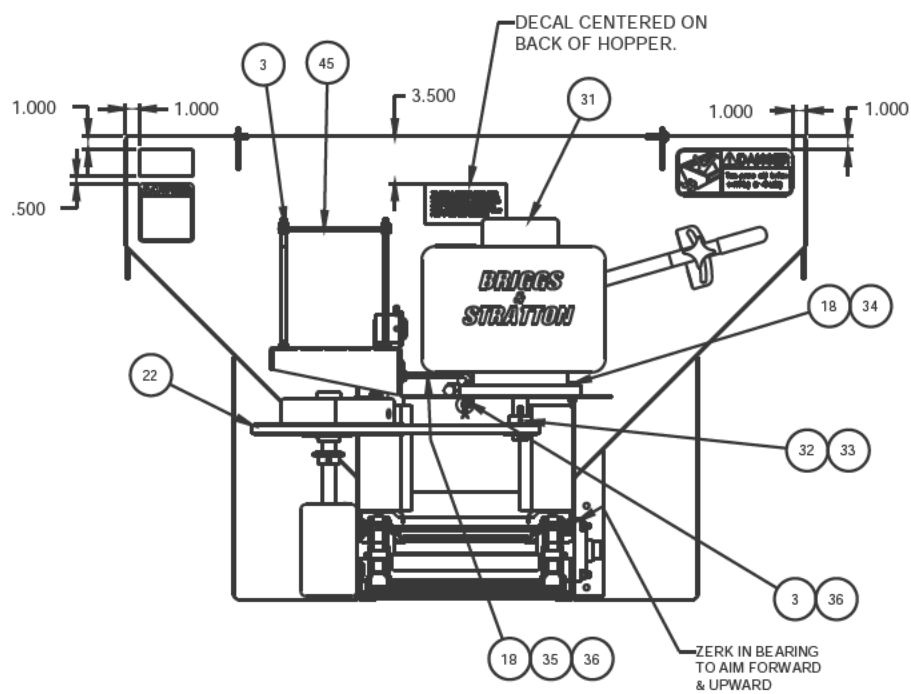

# INSTALLATION AND INSTRUCTIONAL MANUAL

## PV SERIES

### STANDARD PV MODEL

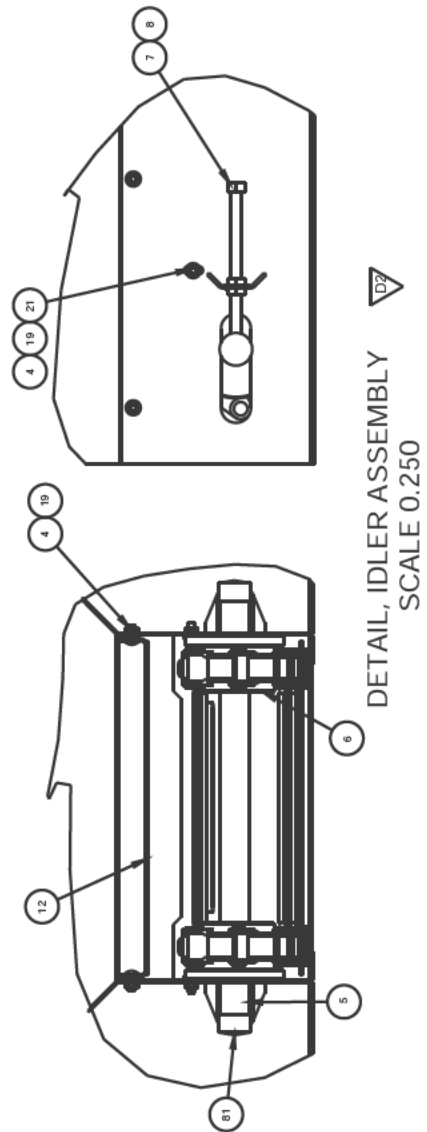

# INSTALLATION AND INSTRUCTIONAL MANUAL

## PV SERIES

### STANDARD PV MODEL

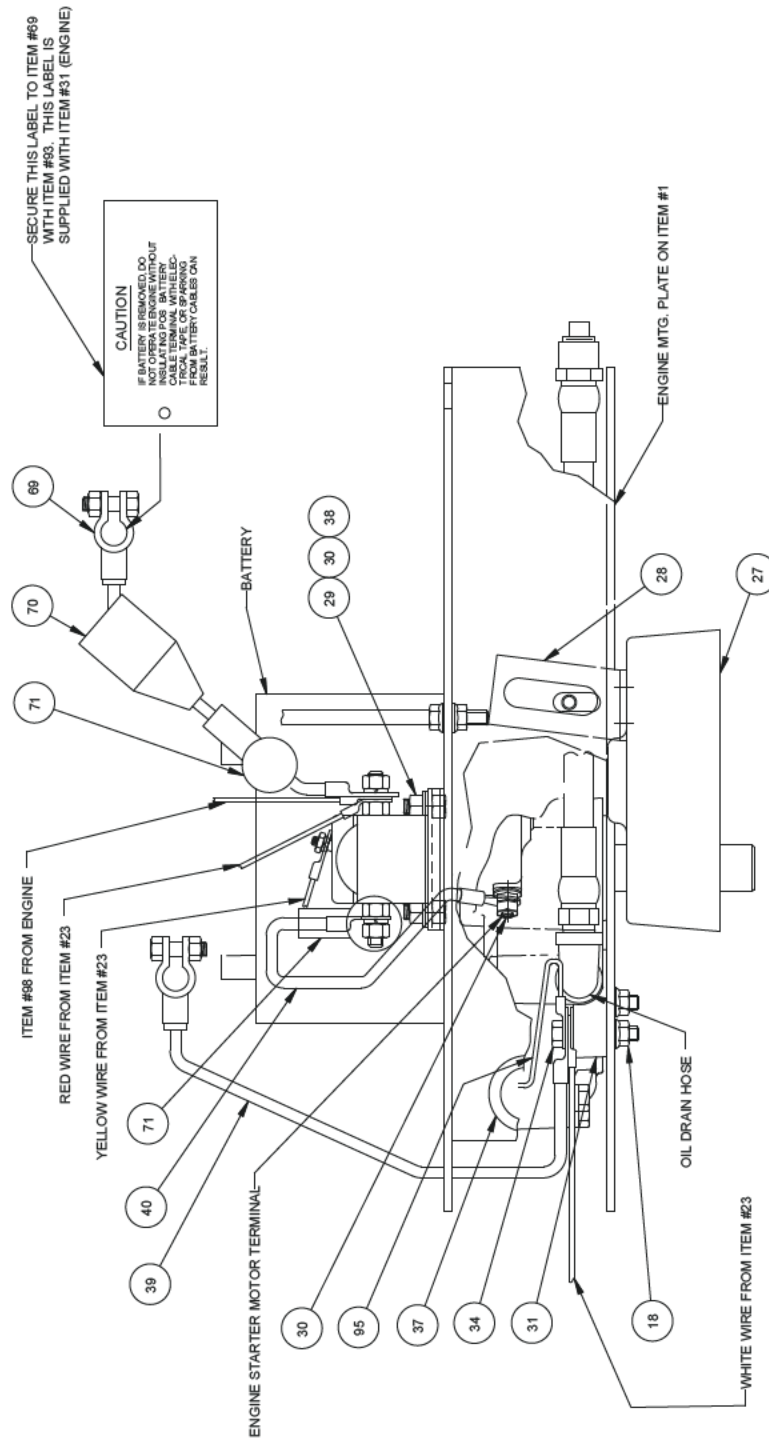

### DETAIL, WIRING ASSEMBLY

# INSTALLATION AND INSTRUCTIONAL MANUAL

## PV SERIES

### STANDARD PV MODEL

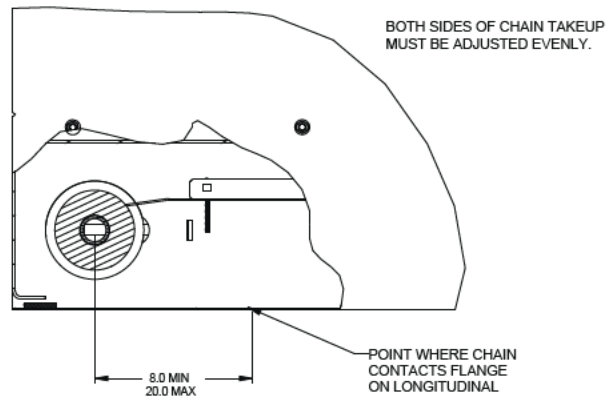

DETAIL, CHAIN TENSION  
SCALE 0.250

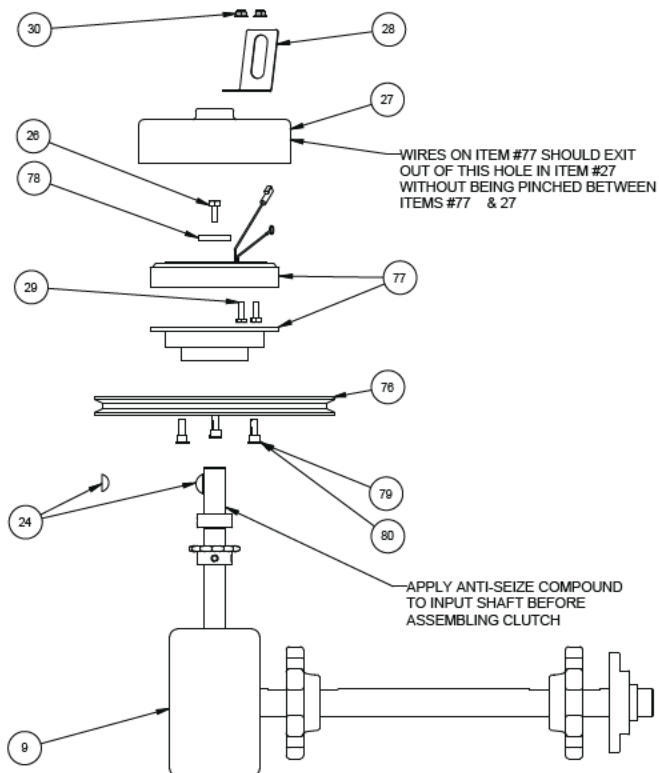

DETAIL, CLUTCH ASSEMBLY  
SCALE 0.250



# INSTALLATION AND INSTRUCTIONAL MANUAL

## PV SERIES

### STANDARD PV MODEL

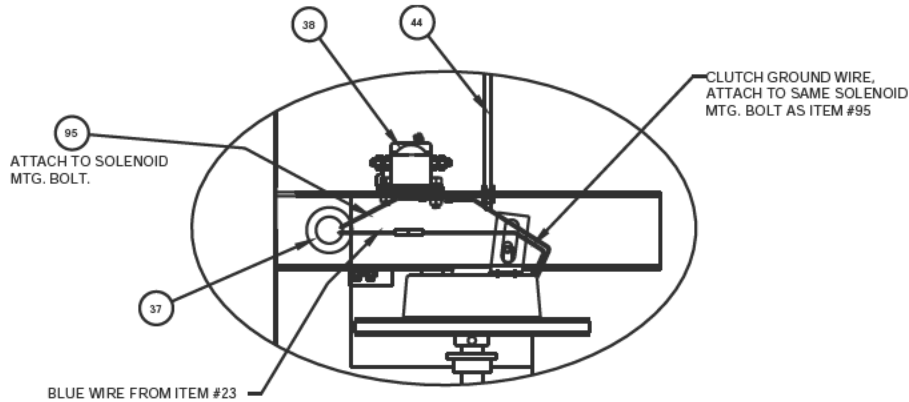

DETAIL,  
CLUTCH WIRING  
SCALE 0.500

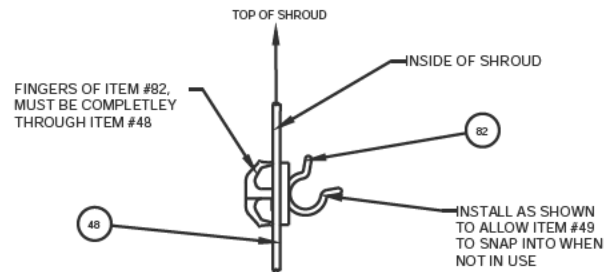

DETAIL, PROP ROD  
CLAMP ASSEMBLY  
SCALE 1.125

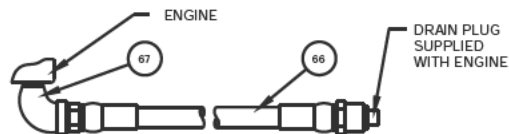

DETAIL, DRAIN  
HOSE ASSEMBLY  
SCALE 0.250

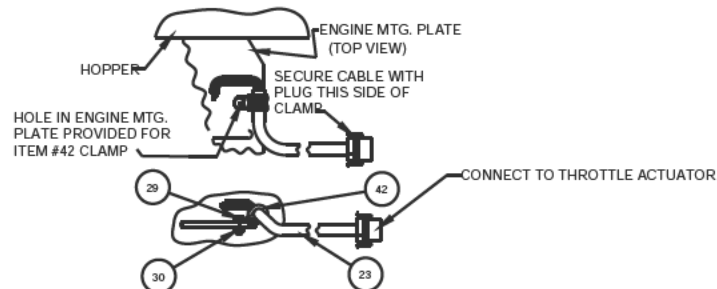

DETAIL,  
CABLE CLAMP

# INSTALLATION AND INSTRUCTIONAL MANUAL

## PV SERIES

### STANDARD PV MODEL

ITEM	PART NUMBER	DESCRIPTION	QTY
31	04145-075-00	ENGINE, 10.5 HP B & S W / VR	1
	00115-778-00	ENGINE, HONDA W/DECALS	
30	04003-806-05	NUT, 1/4-20 SER FLANGE	5
	04003-806-15	NUT, 1/4-20 SER FLANGE ss	
29	04003-001-02	BOLT, 1/4-20 X 3/4 HH	5
	04003-001-11	BOLT, 1/4-20 X 3/4 HH ss	
28	00104-822-00	RETAINER, CLUTCH	1
	00104-822-01	RETAINER, CLUTCH s3	
27	04622-008-00	COVER, CLUTCH	1
26	04003-002-02	BOLT, 5/16-18 X 3/4 HH	1
	04003-002-23	BOLT, 5/16-18 X 3/4 HH ss	
25	00122-073-01	A, WIRELESS REMOTE PV	1
24	04009-001-01	KEY, WOODRUFF 1/4 X 7/8	1
23	04616-120-00	CABLE, SPREADER CONTROL	1
22	04071-016-00	V-BELT, BX-48	1
21	See Parts Table pg 58-59	FORM, FLOOR PV	1
20	See Parts Table pg 58-59	CHAINSHIELD, PV	2
19	04003-032-05	BOLT, 5/16-18 X 3/4 CA	14
	04003-032-06	BOLT, 5/16-18 X 3/4 CA ss	
18	04003-806-01	NUT, 5/16-18 SER FLANGE	10
	04003-806-14	NUT, 5/16-18 SER FLANGE ss	
17	See Parts Table pg 58-59	WELD, DRAG CHAIN	1
16	04003-806-02	NUT, 3/8-16 SER FLANGE	9
	04003-806-12	NUT, 3/8-16 SER FLANGE ss	
15	04003-003-04	BOLT, 3/8-16 X 1 1/4 HH	6
	04003-003-26	BOLT, 3/8-16 X 1 1/4 HH ss	
14	04004-002-20	FLATWASHER, 3/8"SS	2
13	04003-804-02	LOCKNUT, 3/8-16 NYLON	3
	04003-804-08	LOCKNUT, 3/8-16 NYLON ss	
12	00119-590-01	FORMING, GUARD, CONVEYOR, PV	1
11	04004-001-09	LOCKWASHER, 1/2" MED SPLIT	4
	04004-001-16	LOCKWASHER, 1/2" MED SPLIT ss	
10	04003-005-14	BOLT, 1/2-13 X 3/4	4
	04003-005-56	BOLT, 1/2-13 X 3/4 ss	
9	00118-337-00	SUB-ASSEMBLY GEARBOX	1
8	04003-802-05	NUT, 1/2-13 HEX JAM	4
	04003-802-09	NUT, 1/2-13 HEX JAM ss	
7	00115-124-00	WELD, TAKE UP BOLT	2
6	00122-369-00	ROLLER, POLY	2
5	00122-366-00	SHAFT, IDLER	1
4	04003-806-13	NUT, 5/16-18 SER FLANGE SS	13
3	04003-804-01	LOCKNUT, 5/16-18 NYLON	3
	04003-804-29	LOCKNUT, 5/16-18 NYLON ss	
2	04049-045-00	DECAL, CAUTION	1
1	See Parts Table pg 58-59	WELD, PV 50" HOPPER	1

# INSTALLATION AND INSTRUCTIONAL MANUAL

## PV SERIES

### STANDARD PV MODEL

ITEM	PART NUMBER	DESCRIPTION	QTY
61	00118-312-00	FORM, HANDLE FEEDGATE	1
	00118-312-01	FORM, HANDLE FEEDGATE s3	
	00118-312-02	FORM, HANDLE FEEDGATE s2	
60	04540-003-00	OIL, 5W30 MOTOR	SEE ENGINE MANUAL
59	04605-154-00	GROMMET, MTG	1
58	04605-155-00	CABLE, LIGHT POWER	1
57	04003-033-14	BOLT, 3/8-16 X 4" CA	4
55	04093-021-00	TRIM, VINYL	2
54	04049-165-00	DECAL, SERIAL NUMBER (Swenson)	1
53	04049-199-00	DECAL, GASOLINE ONLY	1
52	04049-182-00	DECAL, DANGER	3
51	04010-016-01	PIN, 1/8" X 1" COTTER SS	1
50	04004-002-08	FLATWASHER, 3/8"	2
	04004-002-20	FLATWASHER, 3/8" SS	
49	00112-734-00	ROD, PROP	1
48	00119-587-01	WELD, SHROUD 14G PV	1
	00119-587-02	WELD, SHROUD 14G PV S2	
	00119-587-03	WELD, SHROUD 14G PV S3	
47	04624-001-01	KNOB, HAND	1
46	00110-819-00	WELD, FEEDGATE 7G	1
	00110-819-01	WELD, FEEDGATE 7G S3	
	00110-819-02	WELD, FEEDGATE 7G S2	
45	04604-017-00	DOWN, HOLD	1
44	00104-802-00	ROD, BATTERY	2
43	00104-963-01	P, INSTR MANUAL PV	1
42	04607-027-00	CLAMP, CUSHIONED 1/2"	1
41	04003-033-04	BOLT, 3/8-16 X 1 1/4 CA	1
	04003-033-26	BOLT, 3/8-16 X 1 1/4 CA SS	
40	04616-067-02	CABLE, STARTER, 9", 6GA. RED	1
39	04604-004-00	CABLE, BATTERY BLACK	1
38	04145-005-00	SOLENOID, GROUNDED	1
37	04093-022-00	GROMMET 7/8 X 1 5/8"	1
36	04004-002-07	FLATWASHER, 5/16	2
	04004-002-25	FLATWASHER, 5/16 SS	
35	04048-518-01	BOLT, L	1
34	04003-002-06	BOLT, 5/16-18 X 1 1/2 HH	3
	04003-002-25	BOLT, 5/16-18 X 1 1/2 HH SS	
33	04070-021-00	PULLEY, DRIVER	1
32	04031-007-00	KEY, 1/4" SQ X 1"	1

# INSTALLATION AND INSTRUCTIONAL MANUAL

## PV SERIES

### STANDARD PV MODEL

ITEM	PART NUMBER	DESCRIPTION	QTY
99	04111-052-00	COVER, FEEDGATE HANDLE	1
98	04616-119-00	HARNESS, B & S W / CAPACITOR	1
97	00122-181-01	A, LIFT REAR FORKLIFT PV	1
95	04616-101-00	ASSY, GROUND WIRE	1
94	See Parts Table pg 58-59	P, ASSY SPNR 14 GA	1
93	04607-013-00	TIE, NYLON 5 1/2" STD	5
92	00107-662-00	INSTR. PACKAGE B & S	1
	00115-191-00	INSTR. PACKAGE HONDA	
91	04003-804-28	LOCKNUT, 8-32 NYLON SS	3
90	04004-002-59	FLATWASHER, #8	3
89	04003-069-01	SCREW, 8-32 X 3/4" SS	3
88	00117-257-00	BRACKET, ACTUATOR	1
87	00117-256-00	LINKAGE, THROTTLE	1
86	04150-044-01	ACTUATOR, 12V	1
85	04003-127-01	SCREW, 10-32 X 5/16 PPH ZP	2
84	04049-362-00	DECAL, FUEL SHUT OFF	1
83	04049-357-00	DECAL, ENGINE WARRANTY	1
82	04607-028-00	CLAMP, PROP ROD	1
81	04111-053-00	CAP, IDLER	2
80	04003-081-04	5/16 X 5/8 SH CAP	3
79	04004-001-06	LOCKWASHER, 5/16 MED SPLIT	3
	04004-001-20	LOCKWASHER, 5/16 MED SPLIT ss	
78	00108-771-00	WASHER, CLUTCH RET	1
77	04138-017-00	CLUTCH, ELECTRIC	1
76	04070-020-00	PULLEY, DRIVEN	1
75	04003-032-04	BOLT, 5/16 X 1 CA SS	4
74	See Parts Table pg 58-59	WELD, INV. VEE	1
73	See Parts Table pg 58-59	WELD, SCREEN	1
72	04076-100-00	WIPER, CHAIN	1
71	04067-033-00	BOOT, ALT CABLE	3
70	04067-032-00	BOOT, BATT CABLE	1
69	04604-004-01	CABLE, BATTERY RED	1
68	04045-022-00	PIN, CONNECTOR W/ COTTER PIN	2
67	04110-006-18	ELBOW, 3/8" 90 DEG	1
66	04120-078-01	HOSE, 3/8" X 13"	1
65	00101-636-00	BAR, PIVOT	1
	00101-636-01	BAR, PIVOT s3	
	00101-636-02	BAR, PIVOT s2	
64	04003-033-12	BOLT, 3/8-16 X 3/4 CA SS	1
63	04049-002-02	DECAL, LOGO (Swenson)	3
62	04605-153-00	LAMP, STOP CHM	1

# INSTALLATION AND INSTRUCTIONAL MANUAL

## PV SERIES

### STANDARD PV MODEL

ITEMS NOT SHOWN

ITEM	PART NUMBER	DESCRIPTION	QTY
25	00122-073-01	A, WIRELESS REMOTE PV	1
43	00104-963-01	P, INSTR MANUAL PV	1
53	04049-199-00	DECAL, GASOLINE ONLY	1
60	04540-003-00	OIL, 5W30 MOTOR	SEE ENGINE MANUAL
84	04049-362-00	DECAL, FUEL SHUT OFF	1
92	00107-662-00	INSTR. PACKAGE B &S	1
ns	00115-191-00	INSTR. PACKAGE HONDA	1
94	See Parts Table pg 58-59	P, ASSY SPNR 14 GA	1

# INSTALLATION AND INSTRUCTIONAL MANUAL

## PV SERIES

### DETAIL, WIRING & THROTTLE ASSEMBLY

Briggs & Stratton Actuator

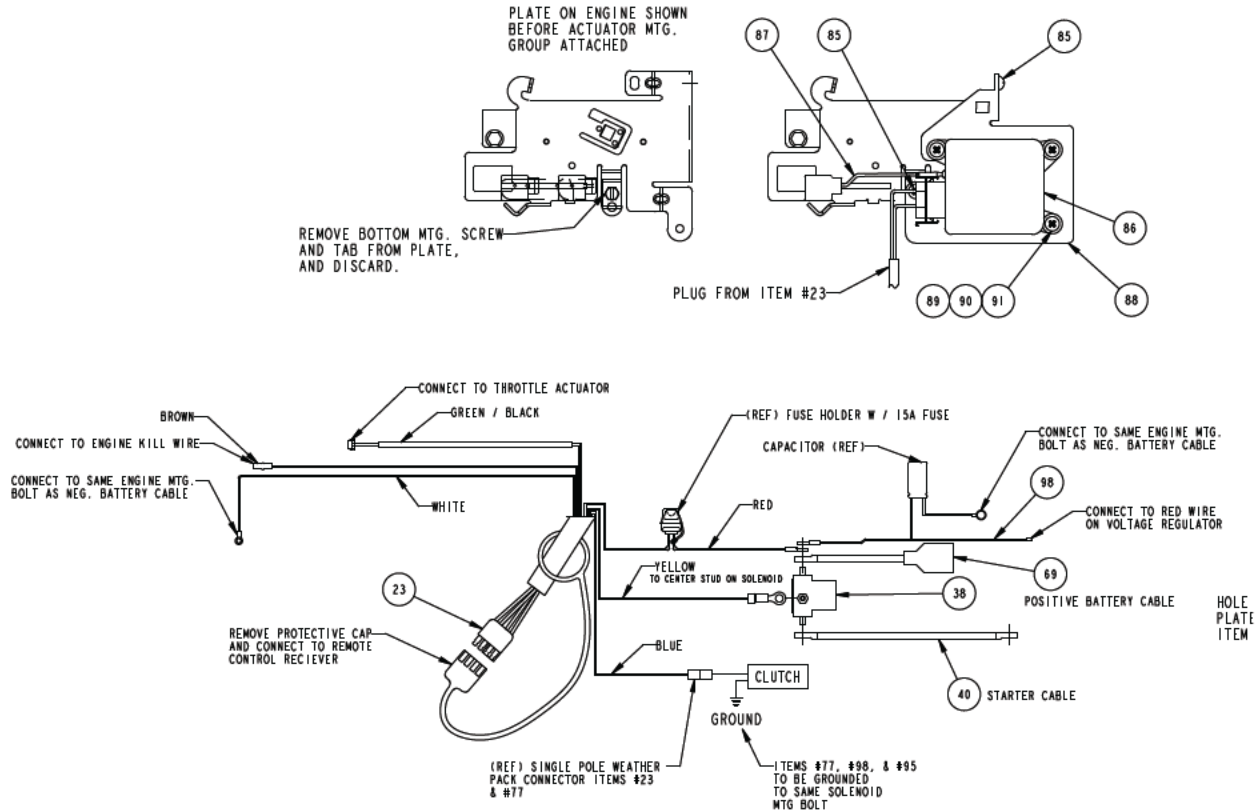

ITEM	PART NUMBER	DESCRIPTION	QTY.
1	00117-410-00	LINKAGE,THROTTLE	1
2	04003-127-01	SCREW,#10-32x5/16"PPH MACHINE	2
3	04150-044-01	ASSEMBLY,ACTUATOR	1
4	04003-069-01	SCREW,#8-32X3/4"PHILRDSS	3
5	04003-804-28	LOCKNUT,#8-32NYLINSSS	3
6	00117-411-00	BRACKET,ACTUATOR,	1
7	04616-119-00	HARNES,B&SW/CAPACITOR	1
8	04604-004-01	CABLE,BATTERY-RED	1
9	04067-032-00	BOOT,BATTERYCABLESTRAIGHT	1
10	04616-033-00	BOOT,ALT.CABLE	1
11	04067-067-06	CABLE,STARTER14"6GARED	1
12	04067-033-00	BOOT,ALT.CABLE	1
13	04616-120-00	CABLE,CONTROLSREADER	1
14	04146-005-00	SOLENOID,GROUNDED	1



# INSTALLATION AND INSTRUCTIONAL MANUAL

## PV SERIES

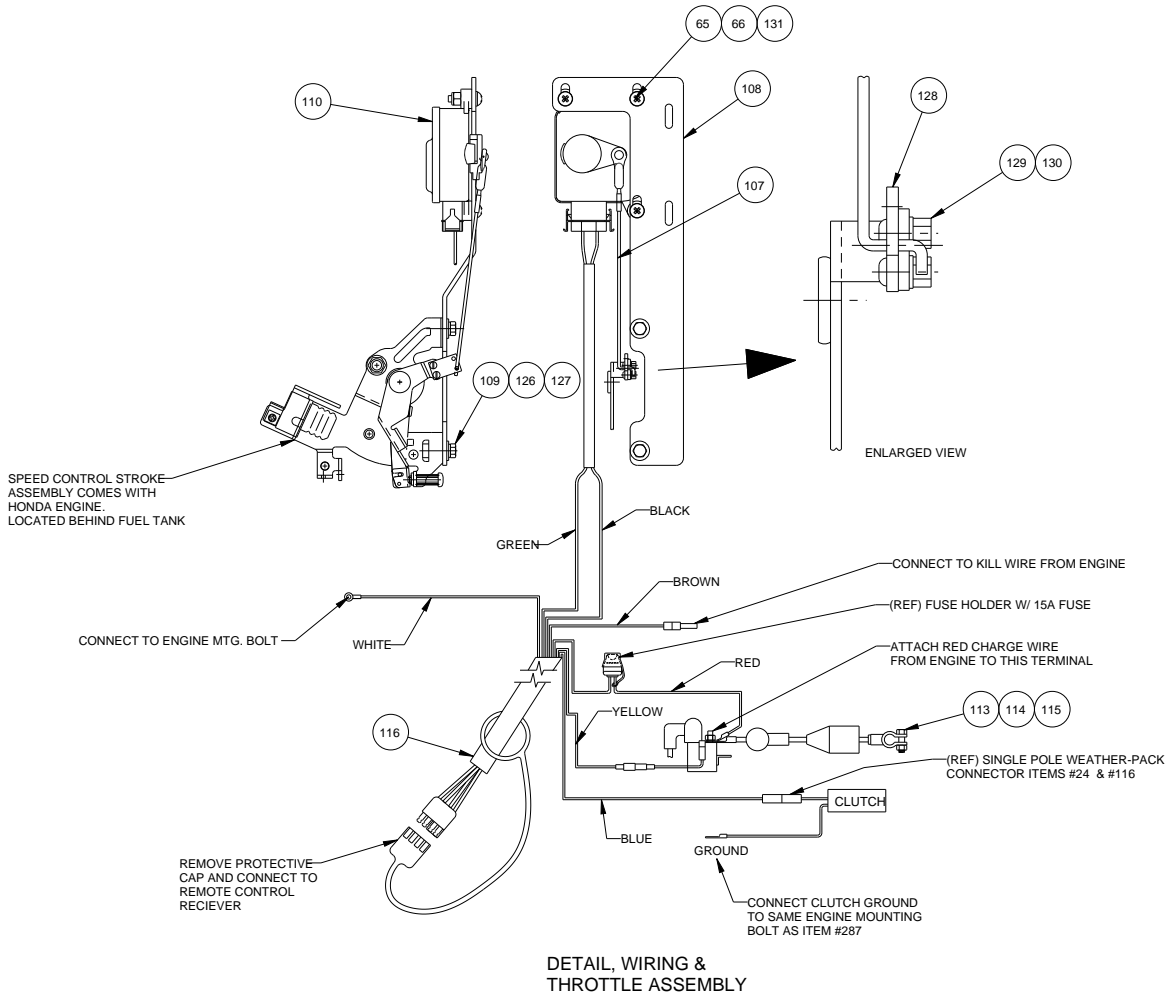

ITEM	PART NUMBER	DESCRIPTION	QTY.
1	04003-069-01	SCREW, #8-32 X 3/4" PHIL RD SS	3
2	04003-804-28	LOCKNUT, #8-32 NYL INS SS	3
3	04004-029-55	FLATWASHER,	3
4	04150-044-01	ASSEMBLY, ACTUATOR	1
5	00117-610-00	LEVER, EXTENSION	1
6	04003-816-01	LOCKNUT 2-56 NYLON SS	1
7	04003-128-01	SCREW, 2-56 X 3/8" SS	1
8	00117-410-00	LINKAGE, THROTTLE	1
9	04003-186-02	BOLT, M5-25 SS	1
10	04004-001-23	LOCKWASHER, #10 SS	2
11	04004-002-53	FLATWASHER, #10 SS	1
12	04616-120-00	CABLE, CONTROL SPREADER	1
13	04604-004-01	CABLE, BATTERY - RED	1
14	04067-032-00	BOOT, BATTERY CABLE STRAIGHT	1
15	04616-033-00	BOOT, ALT. CABLE	1
16	00117-411-00	BRACKET, ACTUATOR	1

# INSTALLATION AND INSTRUCTIONAL MANUAL

## PV SERIES

### HYDRAULIC PV MODEL

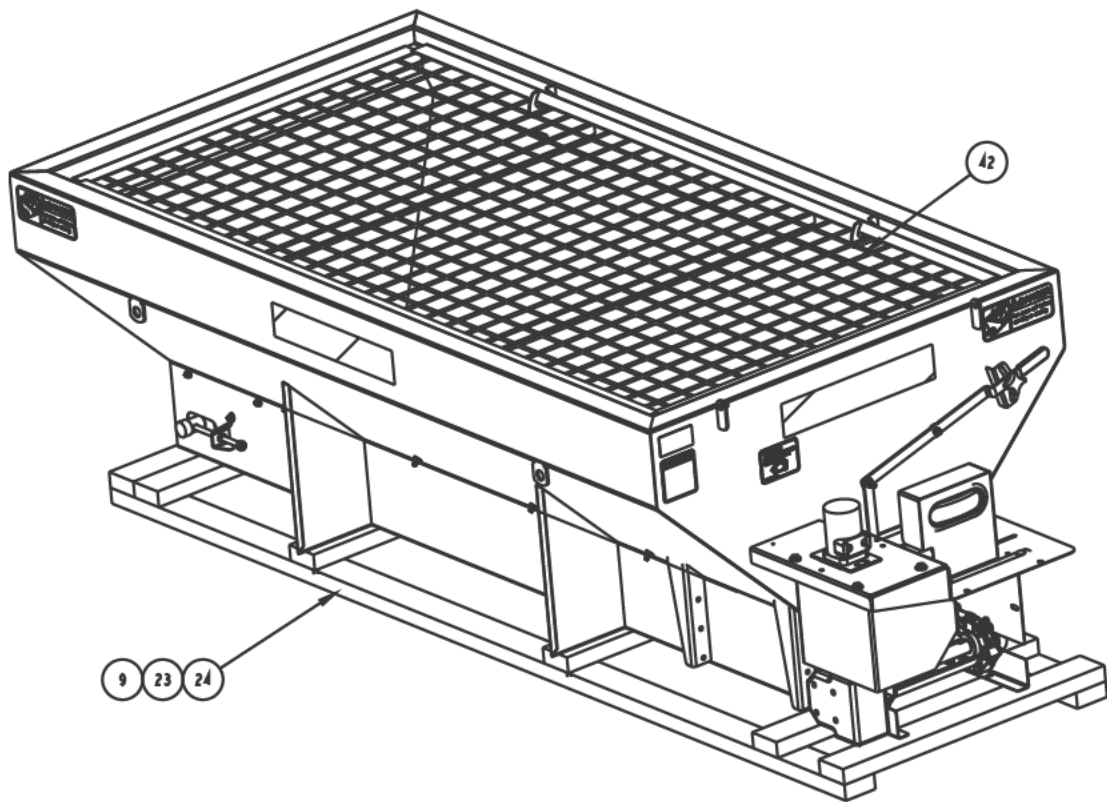

# INSTALLATION AND INSTRUCTIONAL MANUAL

## PV SERIES

### HYDRAULIC PV MODEL

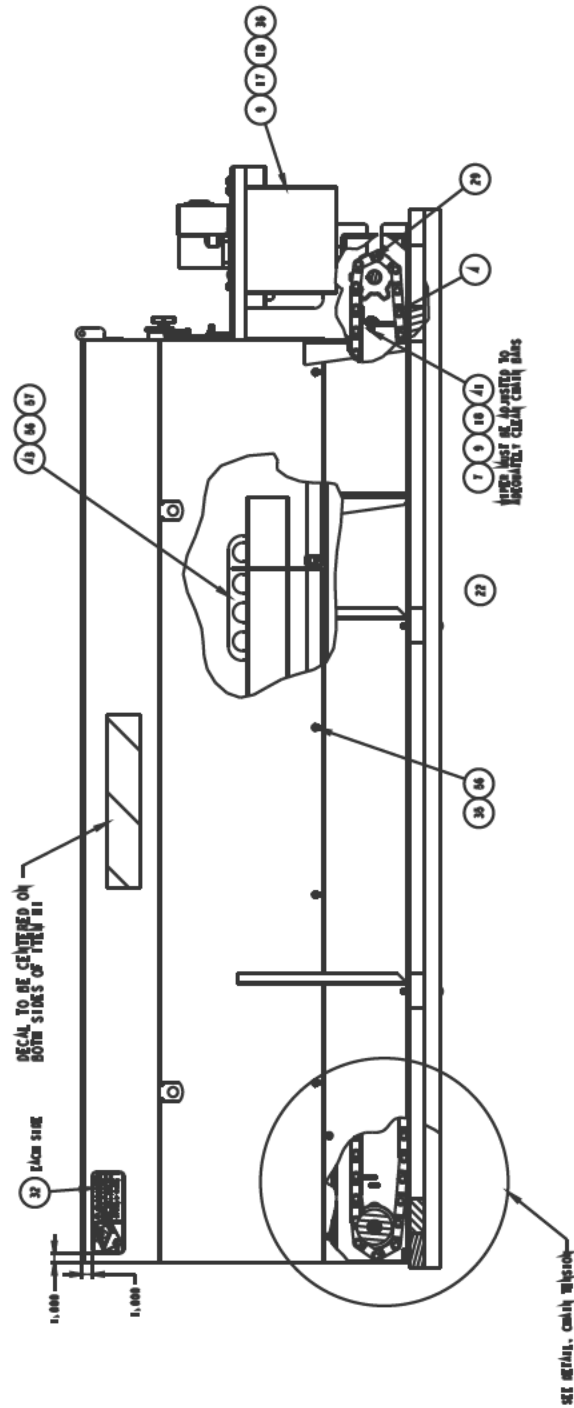

# INSTALLATION AND INSTRUCTIONAL MANUAL

## PV SERIES

### HYDRAULIC PV MODEL

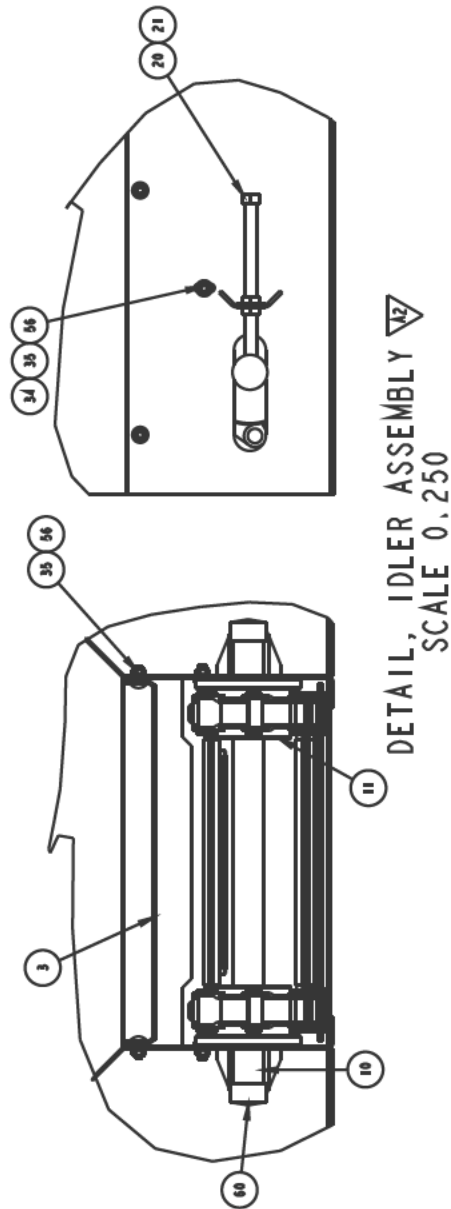

# INSTALLATION AND INSTRUCTIONAL MANUAL

## PV SERIES

### HYDRAULIC PV MODEL

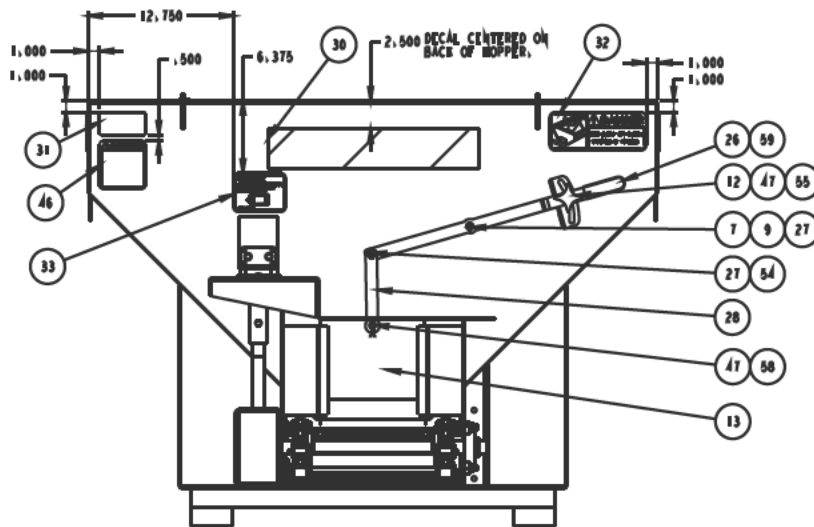
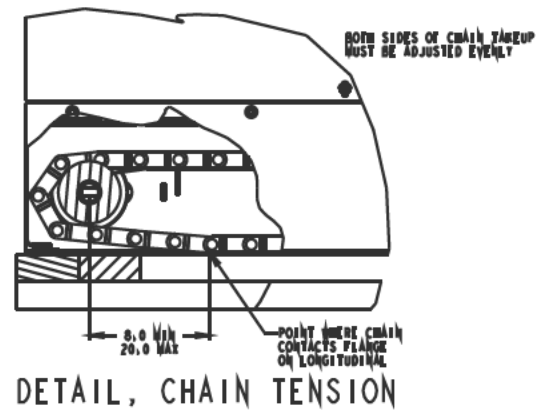

DETAIL, FEEDGATE,  
HANDLE ASSEMBLY  
& DECALS

# INSTALLATION AND INSTRUCTIONAL MANUAL

## PV SERIES

### HYDRAULIC PV MODEL

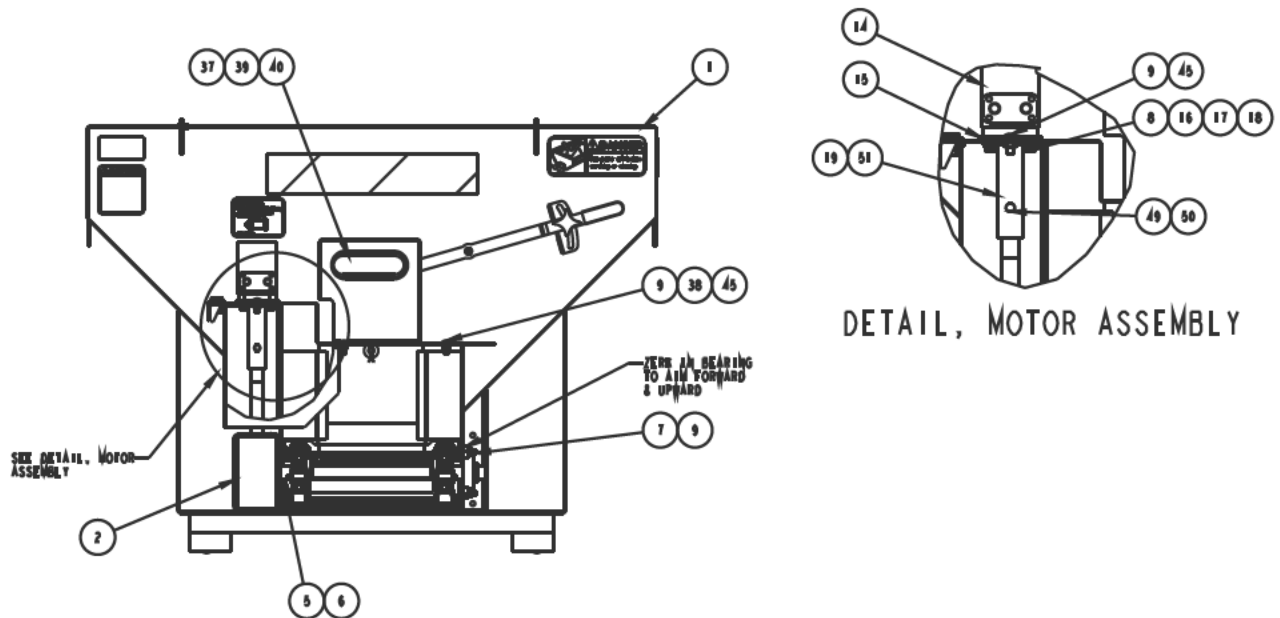

# INSTALLATION AND INSTRUCTIONAL MANUAL

## PV SERIES

### HYDRAULIC PV MODEL

ITEM	PART NUMBER	DESCRIPTION	QTY
27	04003-804-02	LOCKNUT, 3/8" NYLON	2
26	00118-312-00	FORM, FEEDGATE HANDLE	1
	00118-312-01	FORM, FEEDGATE, HANDLE S3	
25	00104-963-01	P, INSTR. MANUAL PV	1
24	04003-033-14	BOLT, 3/8" X 4" CA	4
22	See Parts Table pg 58-59	CHAINSHIELD, PV	2
21	04003-802-05	NUT, 1/2" HEX JAM	4
	04003-802-09	NUT, 1/2" HEX JAM SS	
20	00115-124-00	WELD, TAKEUP BOLT	2
19	00105-302-00	COUPLING, SHAFT	1
18	04004-002-08	FLATWASHER, 3/8"	10
	04004-002-20	FLATWASHER 3/8" SS	
17	04003-003-03	BOLT, 3/8" X 1"	7
	04003-003-20	BOLT, 3/8" X 1" SS	
16	04008-001-00	BUSHING	4
	04008-007-00	BUSHING SS	
15	06011-000-00	PLATE, MOTOR MTG.	1
	06011-000-01	PLATE, MOTOR MTG. S3	
	06011-000-02	PLATE, MOTOR MTGT. S2	
14	04101-035-00	MOTOR, HYDRAULIC	1
13	00110-819-00	WELD, FEEDGATE	1
	00110-819-01	WELD, FEEDGATE, S3	
	00110-819-02	WELD, FEEDGATE, S2	
12	04624-001-01	KNOB, HAND	1
11	00122-369-00	ROLLER, POLY	2
10	00122-366-00	SHAFT, IDLER	1
9	04003-806-02	NUT, 3/8" FLANGE	16
	04003-806-12	NUT, 3/8" FLANGE SS	
8	04004-001-07	LOCKWASHER, 3/8"	4
	04004-001-14	LOCKWASHER, 3/8" SS	
7	04003-003-04	BOLT, 3/8" X 1 1/4"	5
	04003-003-14	BOLT, 3/8" X 1 1/4" SS	
6	04004-001-09	LOCKWASHER, 1/2"	4
	04004-001-16	LOCKWASHER, 1/2" SS	
5	04003-005-14	BOLT, 1/2" X 3/4"	4
	04003-005-56	BOLT, 1/2" 3/4" SS	
4	See Parts Table pg 58-59	WELD, DRAG CHAIN	1
3	00119-590-01	FORM, GUARD, CONVEYOR, PV	
2	00118-337-01	SUB ASSEMBLY, GEARBOX	1
1	See Parts Table pg 58-59	WELD, HOPPER	1

# INSTALLATION AND INSTRUCTIONAL MANUAL

## PV SERIES

### HYDRAULIC PV MODEL

ITEM	PART NUMBER	DESCRIPTION	QTY
60	04111-053-00	IDLER COVER	2
59	04111-052-00	COVER, FEEDGATE HANDLE	1
58	04010-016-01	PIN, COTTER SS	1
57	04003-032-04	BOLT, 5/16" X 1" CA SS	4
56	04003-806-13	NUT, 5/16" FLANGE SS	18
55	04003-033-12	BOLT, 3/8" X 3/4" CA SS	1
54	04003-033-04	BOLT, 3/8" X 1 1/4" CA	1
	04003-033-05	BOLT, 3/8" X 1 1/4" CA SS	
53	00122-181-01	A, LIFT REAR FORKLIFT	1
51	04009-001-01	KEY, WOODRUFF	1
50	04003-804-01	LOCKNUT, 5/16" VINYL	1
49	04003-002-09	BOLT, 5/16" X 2"	1
48	SEE PARTS TABLE	P, ASSY, SPINNER HYD.	1
47	04004-002-20	FLATWASHER, 3/8" SS	2
46	04049-045-00	DECAL, CAUTION	1
45	04003-033-02	BOLT, 3/8" X 1" CA	4
	04003-033-20	BOLT, 3/8" X 1" CA SS	
44	00118-338-00	ASSY, IDLER	1
43	See Parts Table pg 58-59	WELD, INV VEE	1
42	See Parts Table pg 58-59	WELD, SCREEN	1
41	04076-100-00	WIPER, CHAIN	1
40	04605-154-00	GROMMET, MTG.	1
39	04605-153-00	LAMP, STOP	1
38	00111-339-03	WELD, STOP LAMP BRACKET	1
	00111-339-04	WELD, STOP LAMP BRACKET S3	
	00111-339-05	WELD, STOP LAMP BRACKET S2	
37	04605-155-00	CABLE, LIGHT POWER	1
36	00115-154-06	GUARD, SHAFT	1
	00115-154-05	GUARD, SHAFT S3	
	00115-154-04	GUARD, SHAFT S2	
35	04003-032-06	BOLT, 5/16" X 3/4" CA SS	16
34	See Parts Table pg 58-59	FORM, FLOOR PV	1
33	04049-195-00	DECAL, MOTOR	1
32	04049-182-00	DECAL, DANGER	3
31	04049-165-00	DECAL, SERIAL NUMBER (SWENSON)	1
30	04049-002-00	DECAL, LOGO, SWENSON	3
29	04045-022-00	PIN, CONNECTOR W/ COTTER PIN	2
28	00101-636-00	BAR, PIVOT	1
	00101-636-02	BAR, PIVOT SS	



# INSTALLATION AND INSTRUCTIONAL MANUAL

## PV SERIES

### HYDRAULIC PV MODEL

#### ITEMS NOT SHOWN

ITEMS	PART NUMBER	DESCRIPTION	QTY
48	See Parts Table pg 58-59	P, ASSY, SPINNER HYD.	1
		INSIDE UNIT FOR SHIPPING.	
53	00122-181-01	A, LIFT REAR FORKLIFT	1
25	00104-963-01	INSTR. MANUAL	1

# INSTALLATION AND INSTRUCTIONAL MANUAL

## PV SERIES

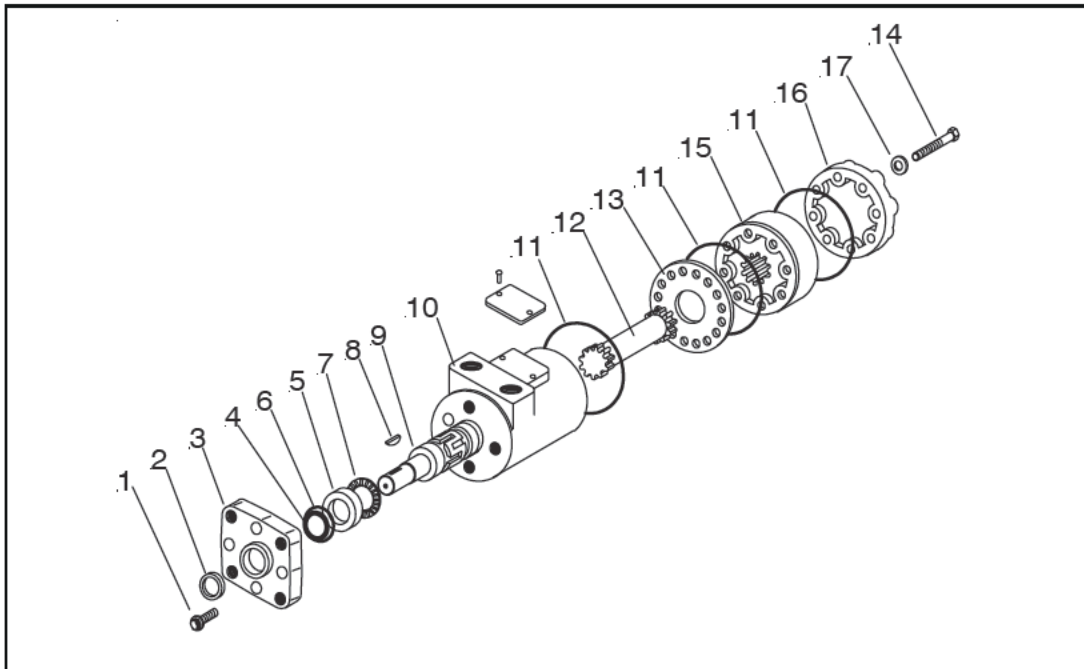

### PARTS LIST FOR HYDRAULIC MOTOR (04101-035-00)

#### PARTS LIST

ITEM	PART NUMBER		QTY.	DESCRIPTION
1		04101-035-01	4	Screw, 5/16" - 24 x 7/8"
2			1	Seal
3		04101-102-02	1	Flange, Mounting (4 Bolt)
4			—	Seal, O-Ring
5		04101 035 05	1	Race, Bearing
6			—	Seal, O-Ring
7		04101 035 07	1	Bearing, Thrust Needle
8		04009 002 02	1	Key, 1/4" x 1" Woodruff
9		04101 035 09	1	Shaft, Output
10		04101 035 10	1	Housing
11			—	Seal, O-Ring
12		04101 035 12	1	Drive (For 04101 035 00)
13		04101 035 13	1	Plate, Spacer
14		04101-035-14	4	Screw, 5/16" - 24 x 1 1/2" Cap
15				
		04101 035 15	1	Gerotor Set (For 04101 035 00)
16		04101 035 17	1	Cap, End
17		04101 035 18	7	Washer, Seal
		04101 035 21	1	Repaired Motor (for 04101 035 00)
		04101 102 09	1	<u>Seal Kit</u> (Char-Lynn)
		04101 035 98	1	Seal Kit (White)

# INSTALLATION AND INSTRUCTIONAL MANUAL

## PV SERIES

### ELECTRIC PV MODEL

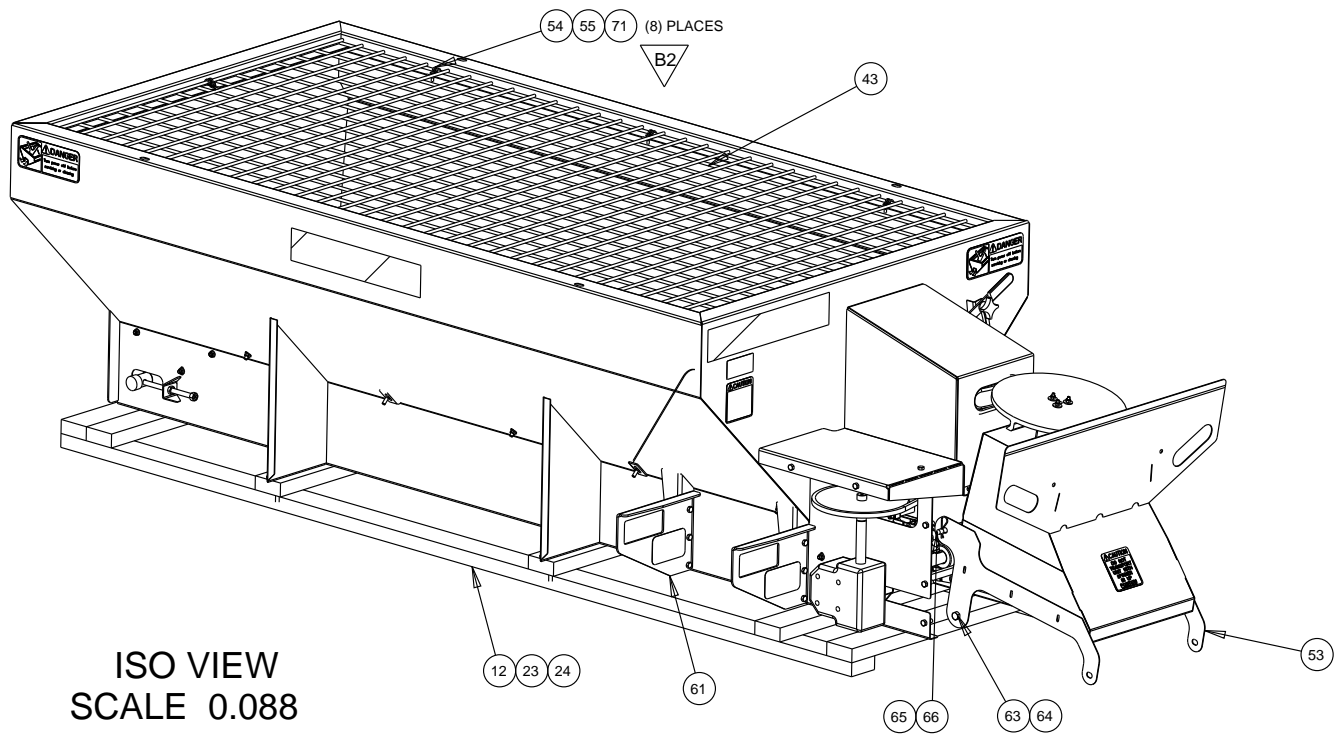

# INSTALLATION AND INSTRUCTIONAL MANUAL

## PV SERIES

### HYDRAULIC PV MODEL

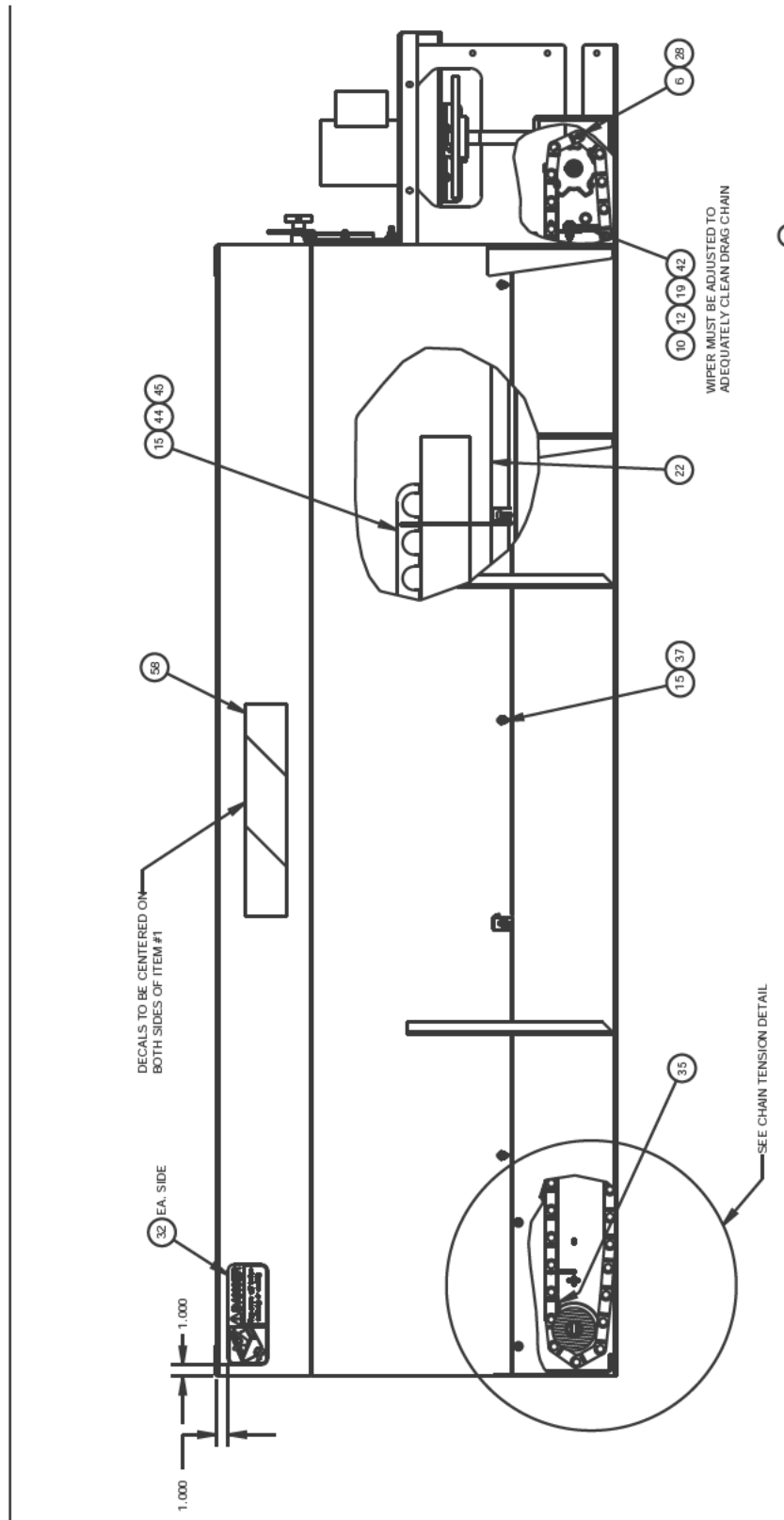

# INSTALLATION AND INSTRUCTIONAL MANUAL

## PV SERIES

### ELECTRIC PV MODEL

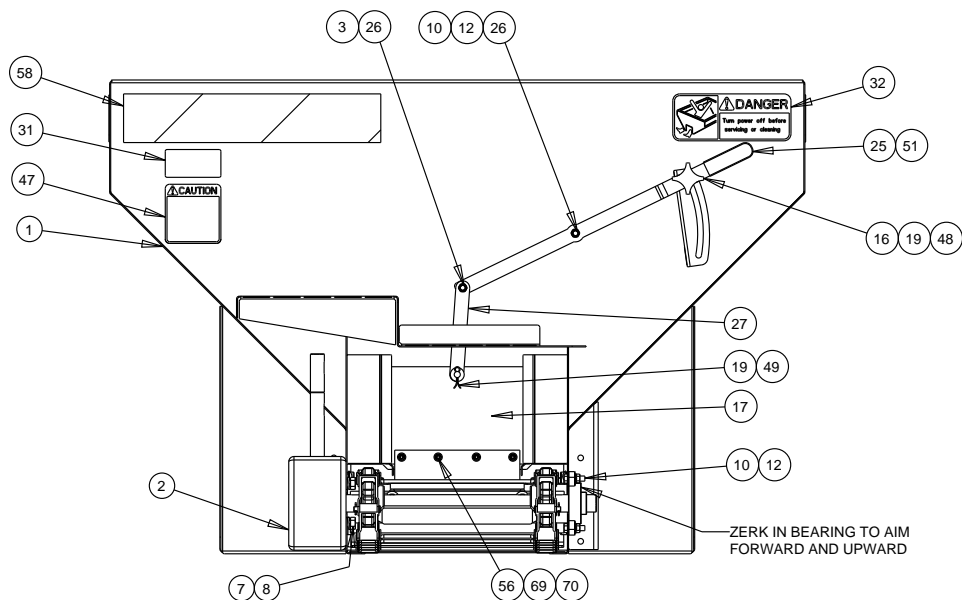
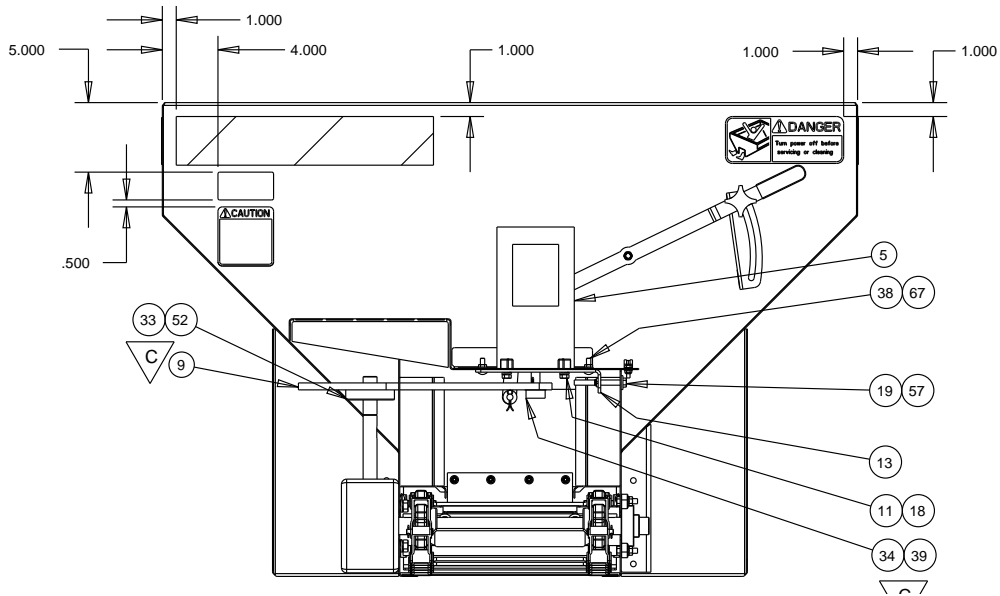

DETAIL, FEEDGATE  
HANDLE ASSEMBLY

# INSTALLATION AND INSTRUCTIONAL MANUAL

## PV SERIES

### ELECTRIC PV MODEL

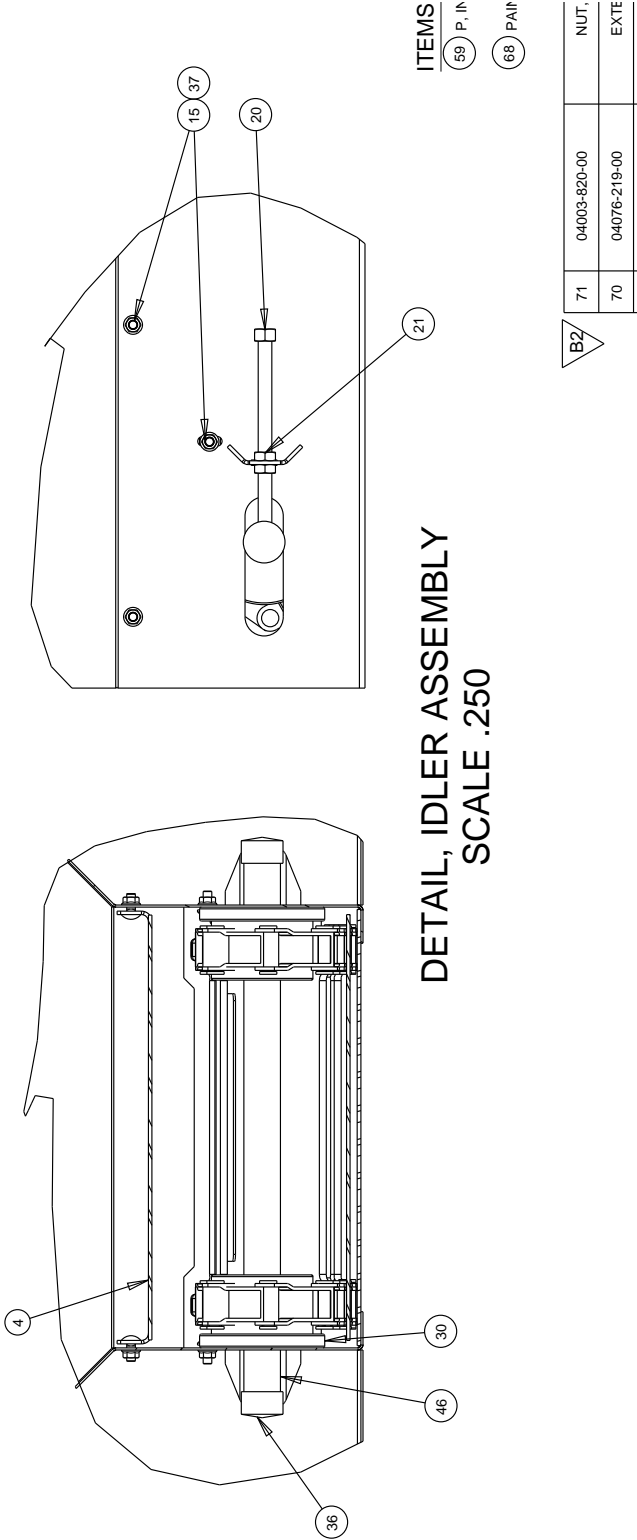

# INSTALLATION AND INSTRUCTIONAL MANUAL

## PV SERIES

### ELECTRIC PV MODEL

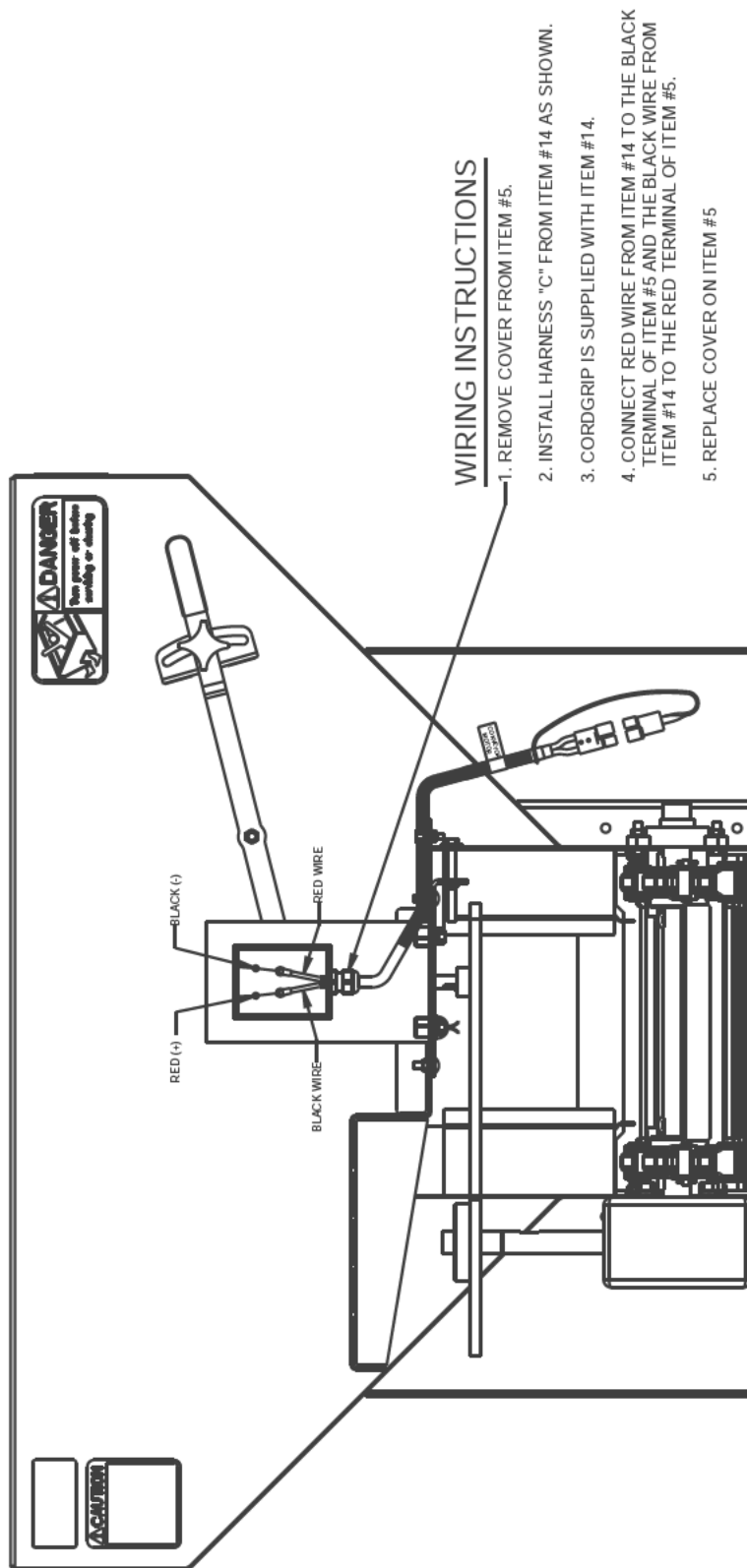

# INSTALLATION AND INSTRUCTIONAL MANUAL

## PV SERIES

### ELECTRIC PV MODEL

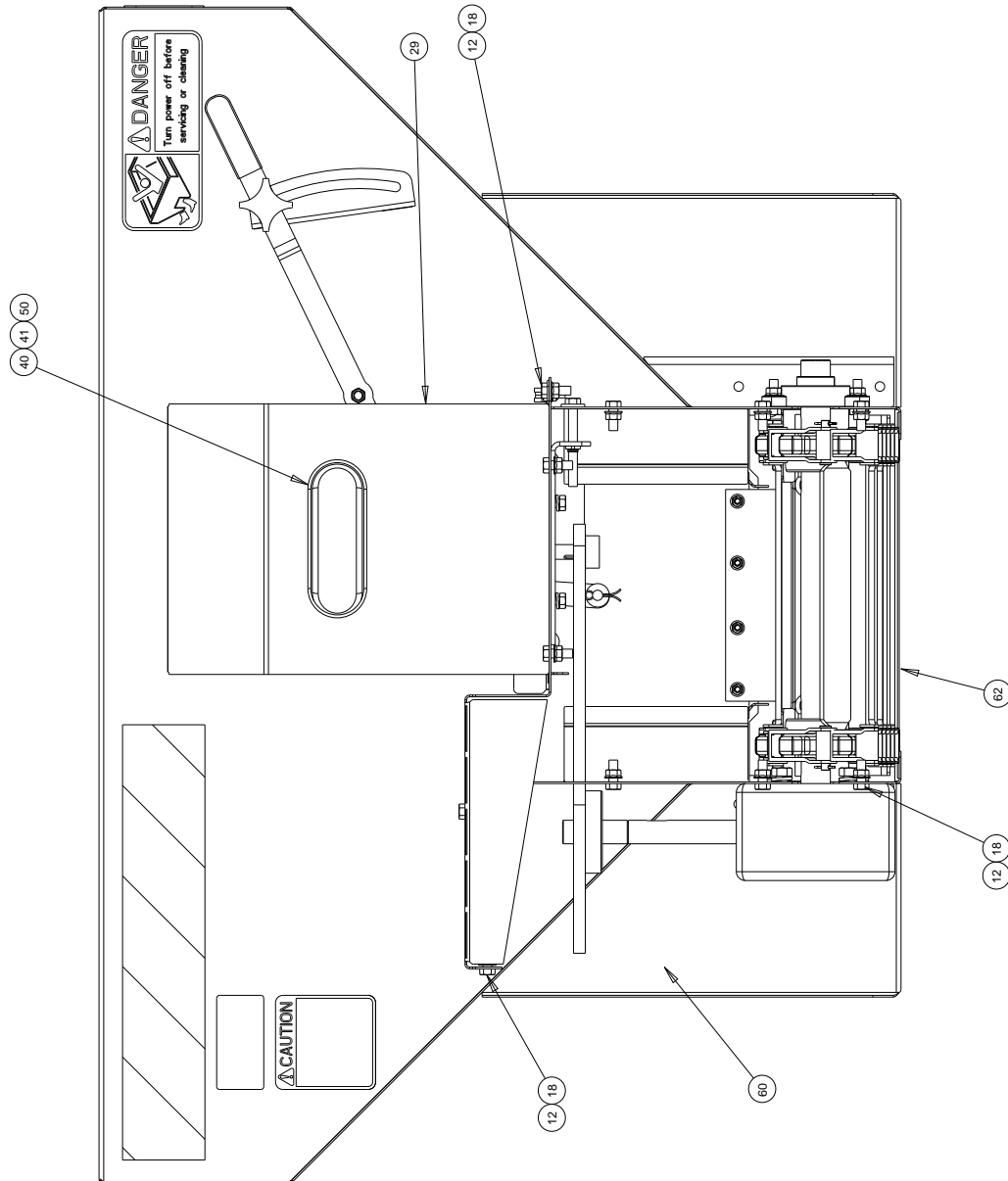

### DETAIL, COVERS ASSEMBLY



# INSTALLATION AND INSTRUCTIONAL MANUAL

## PV SERIES

ELECTRIC PV MODEL

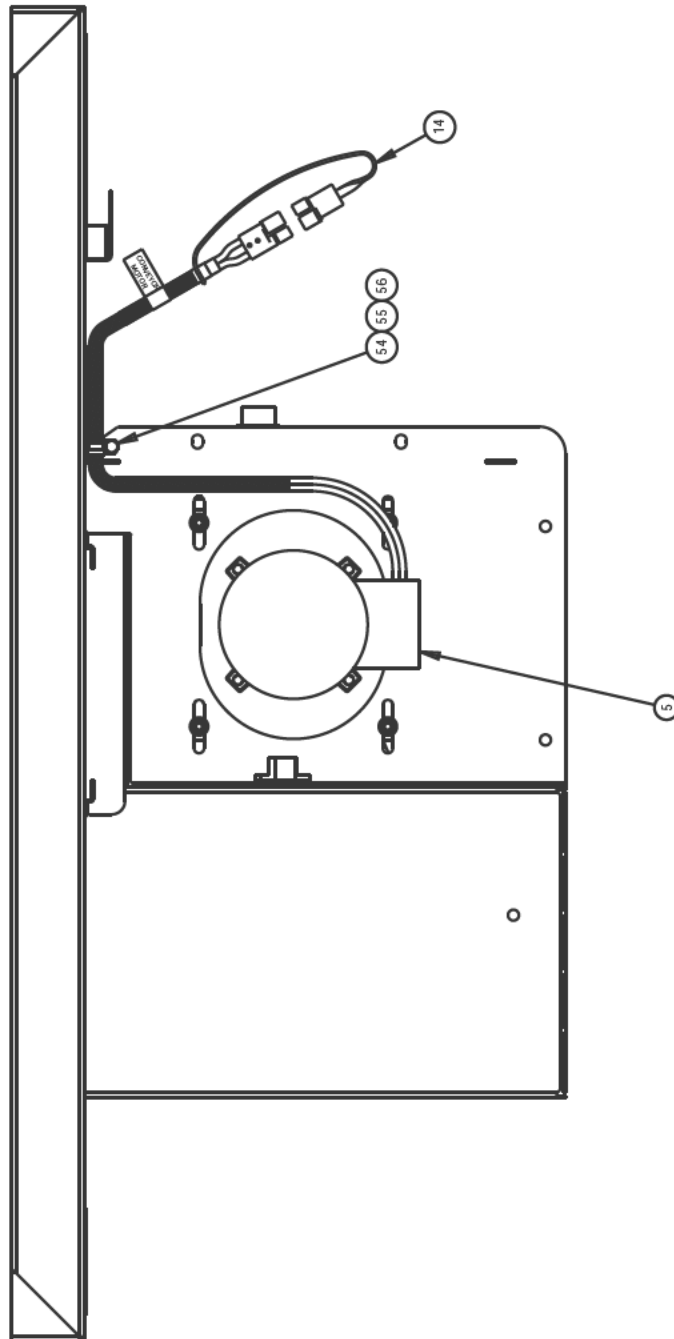

DETAIL, MOTOR WIRING

# INSTALLATION AND INSTRUCTIONAL MANUAL

## PV SERIES

### ELECTRIC PV MODEL

00002-534-13 P, Pv358 50 16g S2 Elec Dm

Item	Component	Description	Qty
1	00115-156-66	Weld, Pv358 50" Hop 16g S2 Dm	1
2	00118-337-01	Sub-Y, Gearbox	1
3	04003-033-05	Bolt, 3/8-16 X 1-1/4 Ca Ss	1
4	00119-590-01	Form, Guard, Conveyor, Pv	1
5	04150-050-00	Motor, 12v 1650rpm 60a 1/2 Hp	1
6	04043-016-00	Weld, Drag Chain, 8 Ft	1
7	04003-005-56	Bolt, 1/2-13 X 3/4 Tap Hh Ss	4
8	04004-001-16	Lockwasher, 1/2" Med Split Ss	4
9	04046-020-03	Chain, Roller #40-94 Pitch W/C	1
10	04003-003-26	Bolt, 3/8-16 X 1-1/4 Hh Ss	5
11	04004-001-14	Lockwasher, 3/8" Med Split Ss	4
12	04003-806-12	Nut, 3/8-16 Ser Flange Ss	22
13	00122-360-06	Weld, Adapter 10g S2	1
14	00123-208-00	P, Control Vbel Electric Dual	1
15	04003-806-13	Nut, 5/16-18 Ser Flange Ss	22
16	04624-001-01	Knob, Hand	1
17	00123-551-06	Weld, Feedgate 10g S2	1
18	04003-003-20	Bolt, 3/8-16 X 1 Hh Ss	17
19	04004-002-20	Flatwasher, 3/8" U.S.S. Ss	5
20	00115-124-00	Weld, Take Up	2
21	04003-802-09	Nut, 1/2-13 Hj Ss	4
22	00119-603-07	Chainshield, Pv 8' 16g S2	2
23	04553-008-02	Skid, Pv, 8 Ft	1
24	04003-033-14	Bolt, 3/8-16 X 4 Ca	4
25	00118-312-05	Form, Handle Feedgate 10g S2	1
26	04003-804-08	Locknut, 3/8-16 Nl Ss	2
27	00101-636-05	Bar, Pivot 10g S2	1
28	04045-022-00	Pin, Connector W/Cotter Pin	2
29	00123-443-06	Weld, Motor Cover 16g S2	1
30	00122-369-00	Roller, Poly	2
31	04049-165-00	Decal, Serial No.	1
32	04049-182-00	Decal, Danger (Conveyor)	3
33	04041-121-00	Sprocket, 40b60-1" Bore	1
34	04041-130-00	Sprocket, 40b-11 5/8" Bore	1

# INSTALLATION AND INSTRUCTIONAL MANUAL

## PV SERIES

### ELECTRIC PV MODEL

35	00122-054-06	Form, Floor 8' Pv 16g S2	1
36	04111-053-00	Cap, Idler	2
37	04003-032-06	Bolt, 5/16-18 X 3/4 Ca Ss	14
38	04003-806-xx	nut, 5/16" flange	4
39	04031-009-00	Key, 3/16" Sq. X 1"	1
40	04605-155-00	Cable, Light Power	1
41	04605-153-00	Lamp, Stop (Ctr Hgh Mt)	1
42	04076-100-00	Wiper, Chain	1
43	00123-306-08	Screen, Pv358 Welded .31x44x90	1
44	00119-891-00	Weld, Inverted Vee Cs	1
45	04003-032-04	Bolt, 5/16-18 X 1 Ca Ss	8
46	00122-366-00	Shaft, Idler	1
47	04049-045-00	Decal, Caution	1
48	04003-033-12	Bolt, 3/8-16 X 3/4 Ca Ss	1
49	04010-016-01	Pin, 1/8" X 1" Cotter Ss	1
50	04605-154-00	Grommet, Mtg	1
51	04111-052-00	Cover, Feedgate Handle	1
52	04009-001-01	Key, 1/4" X 7/8" Woodruff	1
53	00123-456-06	Y, Spinner Pv Su Elect 16g S2	1
54	04607-024-00	Clamp, Cushioned 3/8" Loop Ss	9
55	04003-001-11	Bolt, 1/4-20 X 3/4 Hh Ss	9
56	04003-806-15	Nut, 1/4-20 Ser Flange Ss	13
57	04003-003-63	Bolt, 3/8-16 X 3-1/2 Hh Ss	1
58	04049-002-00	Decal, Swenson-Black	3
59	00104-963-02	P, Instr. Manual Pv W/Adh.Bag	1
60	00123-441-06	Form, Sprocket Guard 16g S2	1
61	00122-181-01	A, Lift Rear Forklift Pv Cs	1
62	00123-442-06	Form, Rear Plate 10g S2	1
63	04003-005-23	Bolt, 1/2-13 X 1-1/4 Tap Hh Ss	2
64	04003-804-07	Locknut, 1/2-13 Nl Ss	2
65	00119-329-02	Rod, Spinner Mount,S3-Ehvp	1
66	04011-001-04	Keeper, Hairpin Large, Ss	1
67	04003-032-xx	Bolt, 5/16" x 1" Ca	4
69	04003-031-05	Bolt, 1/4-20 X 1 Ca Ss	4
70	04076-219-00	Extension, Feedgate	1

# INSTALLATION AND INSTRUCTIONAL MANUAL

## PV SERIES

### ELECTRIC PV MODEL

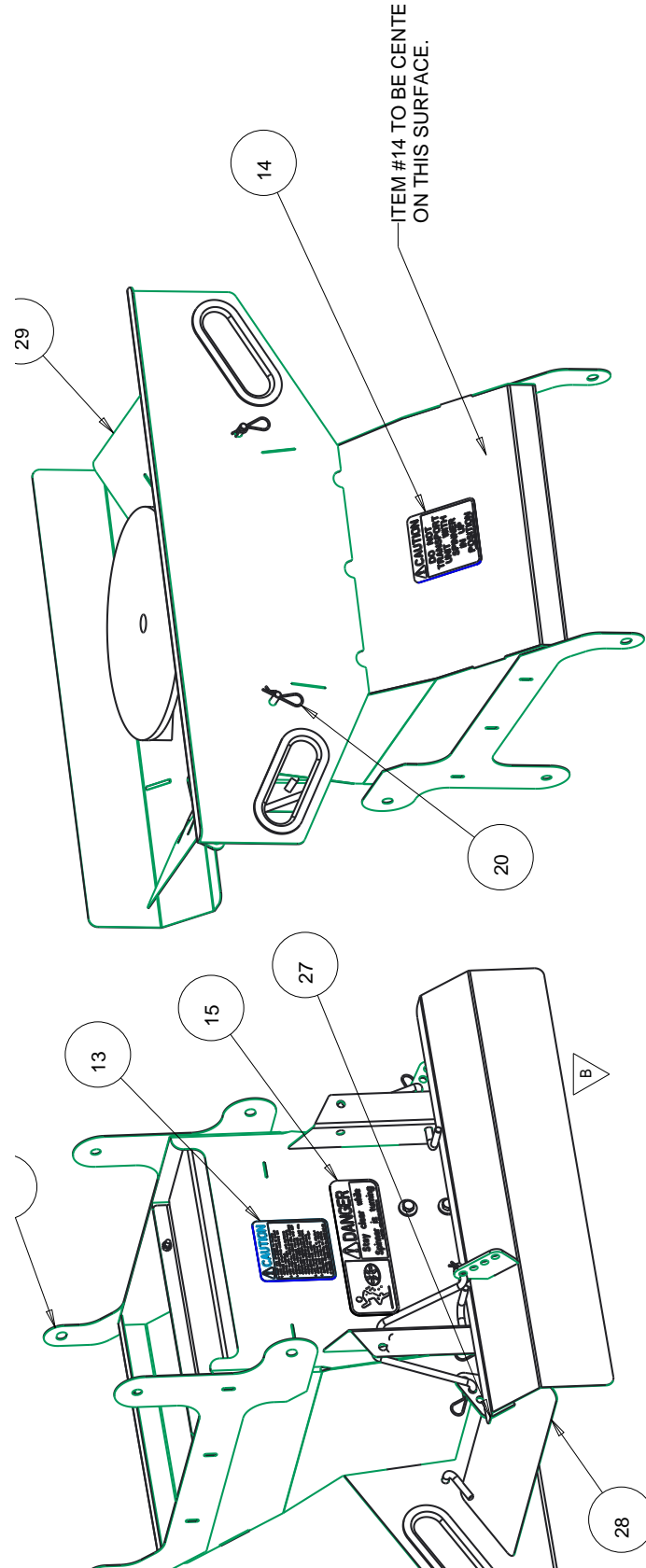

# INSTALLATION AND INSTRUCTIONAL MANUAL

## PV SERIES

### ELECTRIC PV MODEL

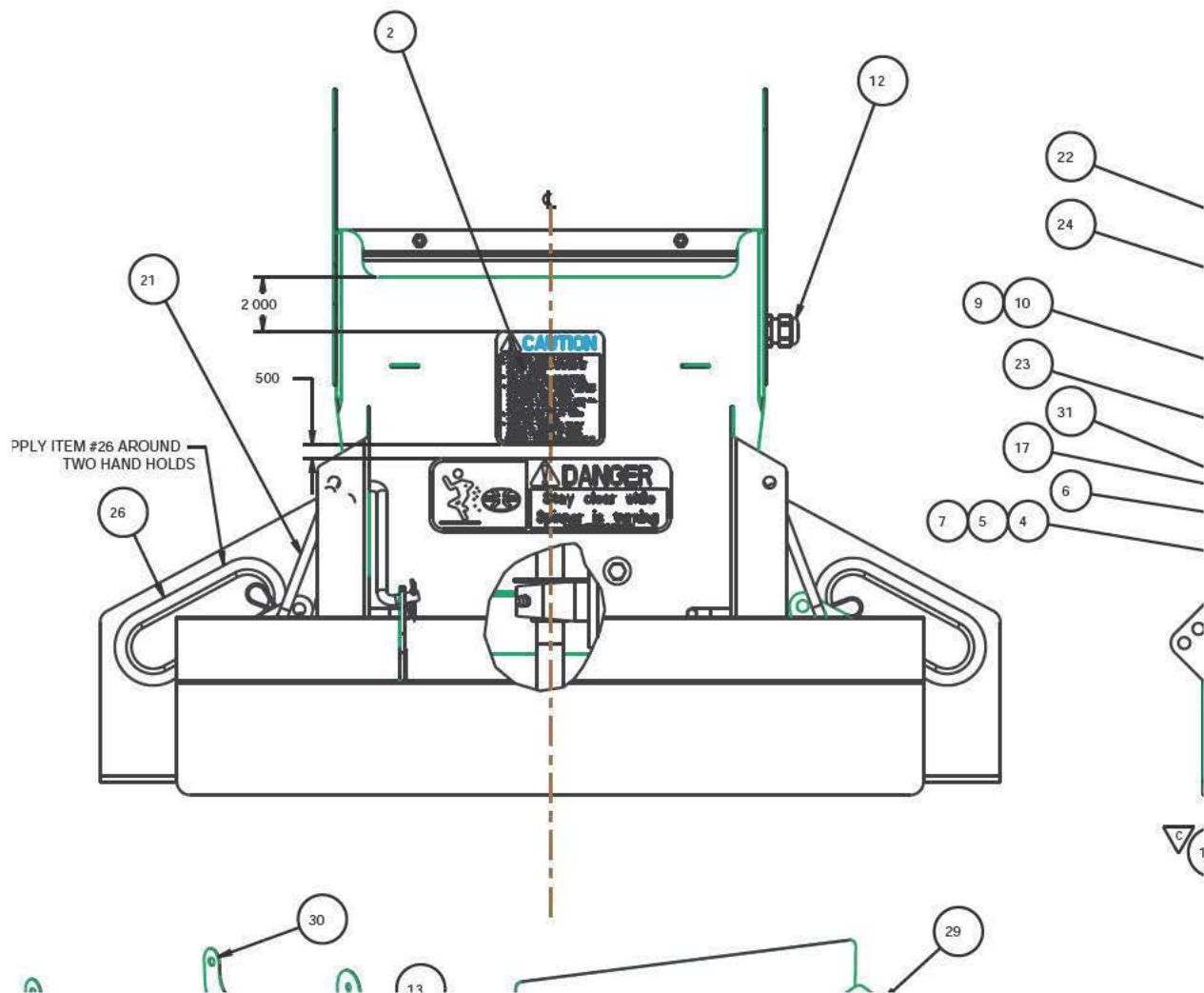

# INSTALLATION AND INSTRUCTIONAL MANUAL

## PV SERIES

### ELECTRIC PV MODEL

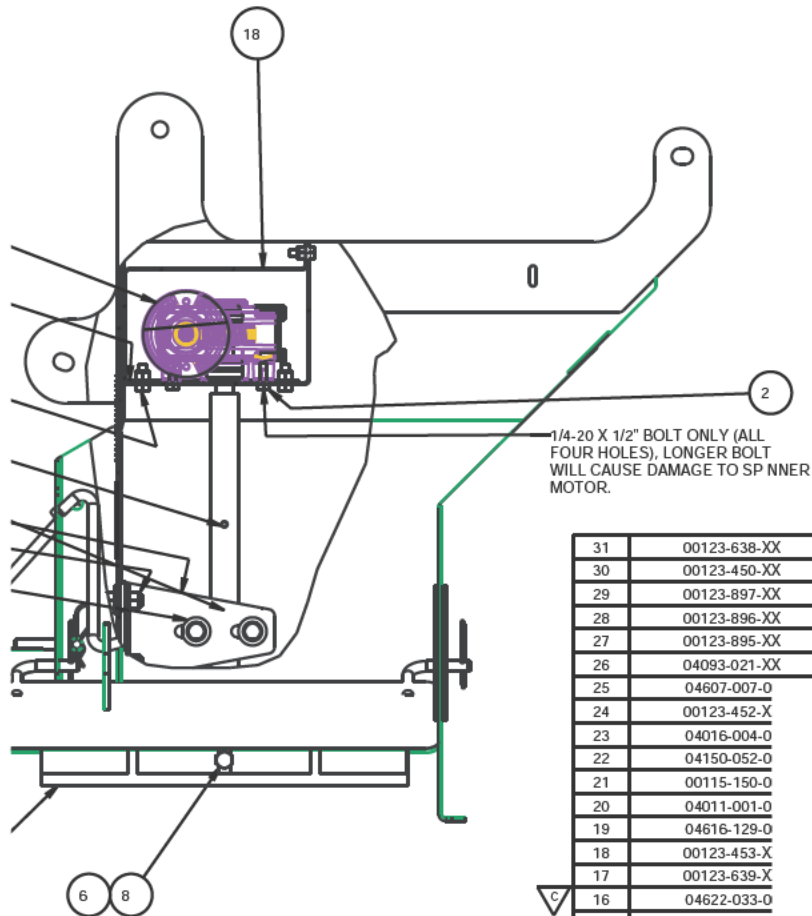

31	00123-638-XX	Y, PV SPIN SHAFT ELECT	1
30	00123-450-XX	WELD, SPIN PV SU ELECT	1
29	00123-897-XX	WELD, BAFFLE RH	1
28	00123-896-XX	WELD, BAFFLE LH	1
27	00123-895-XX	WELD, BAFFLE REAR	1
26	04093-021-XX	VINYL TRIM	2
25	04607-007-0		
24	00123-452-X		
23	04016-004-0		
22	04150-052-0		
21	00115-150-0		
20	04011-001-0		
19	04616-129-0		
18	00123-453-X		
17	00123-639-X		
16	04622-033-0		
15	04049-044-0		
14	04049-416-0		
13	04049-045-0		
12	04611-059-0		
11	04638-093-0		
10	04003-002-2		
9	04003-804-2		

# INSTALLATION AND INSTRUCTIONAL MANUAL

## PV SERIES

### ELECTRIC PV MODEL

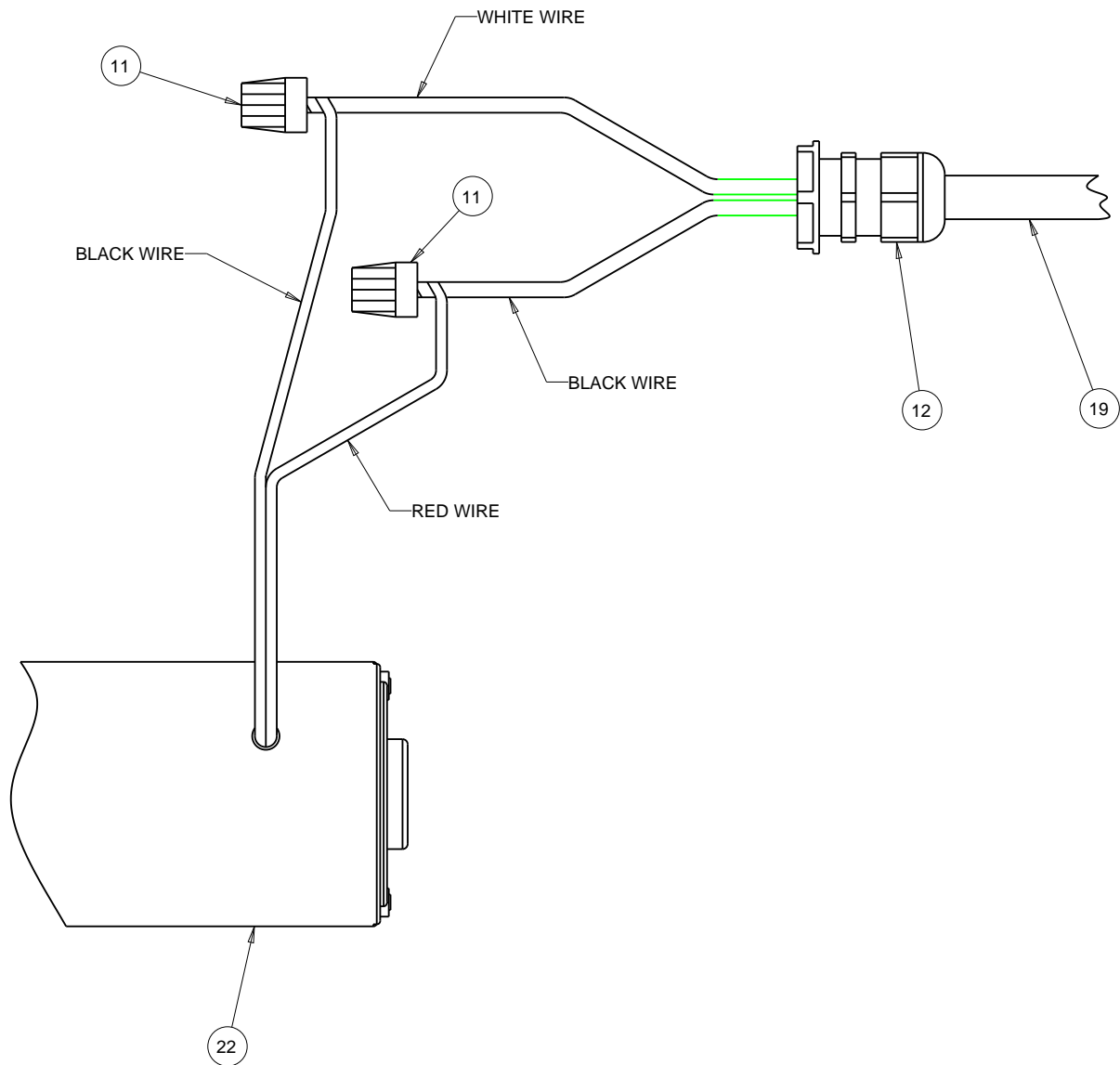

# INSTALLATION AND INSTRUCTIONAL MANUAL

## PV SERIES

### ELECTRIC PV MODEL

00123-456-06 Y, Spinner Pv Su Elect 16g S2

Item	Component	Description	Qty
1	00123-450-06	Weld, Spin Pv Su Elect 16g S2	1
2	04049-045-00	Decal, Caution	1
3	04049-044-00	Decal, Danger (Spinner)	1
4	04049-416-00	Decal, Swing Up Spinner	1
5	00123-452-06	Plate, Spin Motor Adapt 16g S2	1
6	04150-052-00	Motor, 12v Right Angle Spinner	1
7	00123-533-01	Weld, Spinner Shaft Cs	1
8	04622-094-00	Disc, Spinner 14" Ccw	1
9	04004-001-19	Lockwasher, 1/4" Med Split Ss	4
10	04003-001-11	Bolt, 1/4-20 X 3/4 Hh Ss	2
11	04003-002-23	Bolt, 5/16-18 X 3/4 Hh Ss	4
12	04003-806-13	Nut, 5/16-18 Ser Flange Ss	4
13	04016-004-01	Pin, 3/16" X 1" Roll	1
14	04003-001-17	Bolt, 1/4-20 X 1-1/4 Hh Ss	3
15	04004-002-24	Flatwasher, 1/4" S.A.E. Ss	3
16	04003-804-21	Locknut, 1/4-20 Nl Ss Sp	3
17	04003-806-15	Nut, 1/4-20 Ser Flange Ss	2
18	00123-453-06	Form, Spin Motor Cover 16g S2	1
19	04611-059-00	Bushing, Strain Relief	1
20	04616-129-00	Harness, Electric Motor	1
21	04638-093-00	Twister Db Plus Wire Nut	2
22	04003-001-34	Bolt, 1/4-20 X 1/2 Hh Std Ss	4
23	04093-021-00	Trim, Vinyl	1.25
24	04607-007-00	Tie, Nylon 14" Std.	2



# INSTALLATION AND INSTRUCTIONAL MANUAL

## PV SERIES

### ELECTRIC PV MODEL

#### A, Lift Rear Forklift Pv Cs

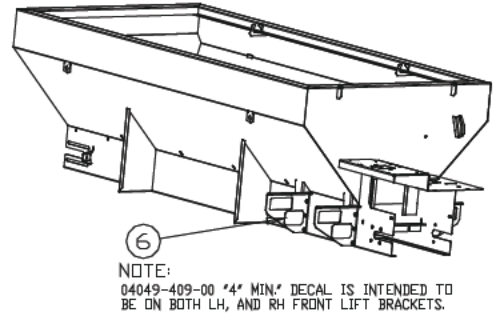
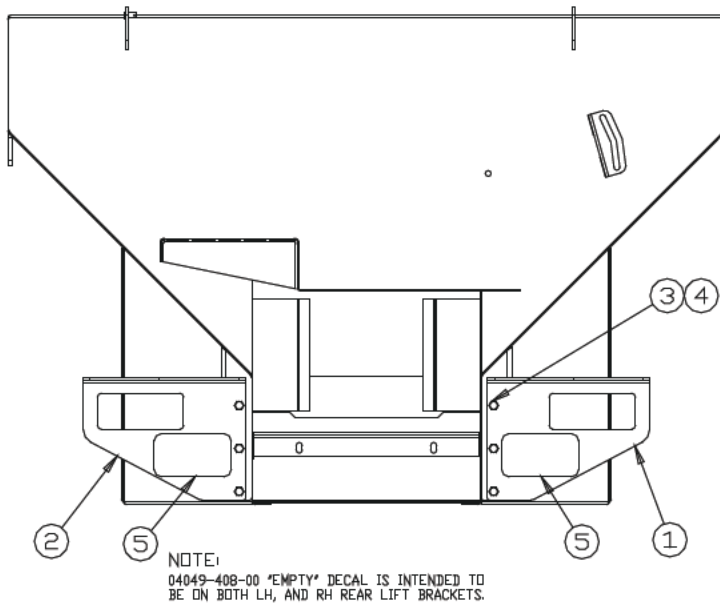

		00122-181-01 A, Lift Rear Forklift Pv Cs	
Item	Component	Description	Qty
1	00122-175-01	Brkt, Fork Rh Cs	2
2	00122-178-01	Brkt, Fork Lh 7g Cs	2
3	04003-003-20	Bolt, 3/8-16 X 1 Hh Ss	12
4	04003-806-12	Nut, 3/8-16 Ser Flange Ss	12
5	04049-408-00	Decal, Caution Unloaded	2
6	04049-409-00	Decal, Caution 4" Min	2

ELECTRIC PV MODEL  
04623-008-00  
Control, Motor Dual Elec





# INSTALLATION AND INSTRUCTIONAL MANUAL

## PV SERIES

### PV PARTS LISTING TABLE

#### PV HOPPERS

ITEM	PART NUMBER	DESCRIPTION	QTY
See BM	00115-156-40	WELD, PV358 50" HOPPER 14GA CS	1
	00115-156-32	WELD, PV358 50" HOPPER 14GA S2	1
	00115-156-25	WELD, PV358 50" HOPPER 14GA S3 HYD	1
	00115-156-41	WELD, PV359 50" HOPPER 14GA CS 9 FT	1
	00115-156-45	WELD, PV359 50" HOPPER 14GA S2	1
	00115-156-42	WELD, PV3510 50" HOPPER 14GA CS	1
	00115-156-46	WELD, PV3510 50" HOPPER 14 GA S2	1
	00115-156-66	WELD, PV, 358 50" HOPPER 16 GA S2 DM(ELEC)	1

#### PV DRAG CHAINS

ITEM	PART NUMBER	DESCRIPTION	QTY
See BM	04043-016-00	WE;D, DRAG CHAIN 8 FOOT	1
	04043-032-00	WELD, DRAG CHAIN 9 FOOT	1
	04043-030-00	WELD, DRAG CHAIN 10 FOOT	1

#### PV CHAIN SHIELDS

ITEM	PART NUMBER	DESCRIPTION	QTY
See BM	00119-603-04	CHAINSHIELD, PV 8" 14GA CS	2
	00119-603-03	CHAINSHIELD, PV 8" 14GA S2	2
	00119-603-01	CHAINSHIELD, PV 8' 14GA S3	2
	00119-604-02	CHAINSHIELDS, PV 9' 14GA CS	2
	00119-604-01	CHAINSHIELDS, PV 9' 14GA S2	2
	00119-605-02	CHAINSHIELD, PV 10' 14GA CS	2
	00119-605-01	CHAINSHIELD, PV 10' 14GA S2	2
	00119-603-07	CHAINSHIELD, PV 8' 16 GA S2 (ELEC)	2

#### PV INVERTED "VEES"

ITEM	PART NUMBER	DESCRIPTION	QTY
See BM	00119-891-00	INVERTED VEE, 8 FOOT PV	1
	00115-112-01	INVERTED VEE, 9 FOOT PV	1
	00115-113-01	INVERTED VEE 10 FOOT PV	1

CS=CARBON STEEL, S2=201 STAINLESS STEEL, S3=304 STAINLESS STEEL

Unless specified in ( ) parenthesis, parts are operational in all models of same length.

# INSTALLATION AND INSTRUCTIONAL MANUAL

## PV SERIES

### PV PARTS LISTING TABLE CONTINUED

#### PV FLOOR

ITEM	PART NUMBER	DESCRIPTION	QTY
See BM	00122-054-01	FORM, FLOOR, 8' PV 14GA CS	1
	00122-054-02	FORM, FLOOR, 8' PV 14GA S2	1
	00122-055-01	FORM, FLOOR, 9' PV 14GA CS	1
	00122-055-02	FORM, FLOOR, 9' PV 14GA S2	1
	00122-056-01	FORM, FLOOR, 10' PV 14GACS	1
	00122-056-02	FORM, FLOOR, 10' PV 14GA S2	1
	00122-054-06	FORM, FLOOR 8' PV 16 GA S2 (ELEC)	1

#### PV SHROUD

ITEM	PART NUMBER	DESCRIPTION	QTY
See BM	00119-587-01	WELD, SHROUD, PV 14GA CS	1
	00119-587-02	WELD, SHROUD, PV 14GA S2	1
	00119-587-03	WELD, SHROUD, PV 14GA S3	1

#### PV SPINNER ASSEMBLIES

ITEM	PART NUMBER	DESCRIPTION	QTY
See BM	00002-296-27	P, ASSY, PV SPNR, INTMD, 14GA CS	1
	00002-296-15	P, ASSY, PV SPNR, INTMD, 14GA CS (HYD)	1
	00002-296-22	P, ASSY, PV SPNR, INTMD, 14GA S2	1
	00002-296-23	P, ASSY, PV SPNR, INTMD, , 14GA S2 (HYD)	1
	00002-296-30	P, ASSY, PV SPNR, EXT, 14GA S2 (HYD)	1
	00002-296-32	P,ASSY, PV SPNR, EXT, 14GA S3 (HYD)	1
	00002-296-19	P, ASSY, PV SPNR, INTMD, 14GA S3	1
	00123-456-06	Y, SPINNER PV SU 16 GA S2 (ELEC)	1

#### PV SCREENS

ITEM	PART NUMBER	DESCRIPTION	QTY
See BM	00119-852-08	SCREEN, 8 FOOT PV	1
	00119-852-01	SCREEN, 9 FOOT PV	1
	00119-852-02	SCREEN, 10 FOOT PV	1
	00123-306-08	SCREEN, PV 358 WELDED (ELEC)	1

CS=CARBON STEEL, S2=201 STAINLESS STEEL, S3=304 STAINLESS STEEL

Unless specified in ( ) parenthesis, parts are operational in all models of same length.

# INSTALLATION AND INSTRUCTIONAL MANUAL

## PV SERIES

### SUPERIOR GEARBOX ASSEMBLY

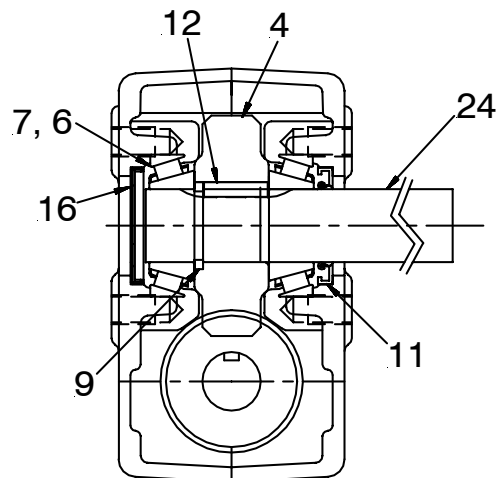
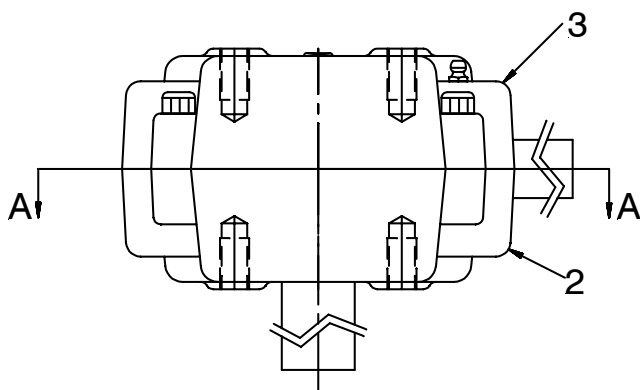
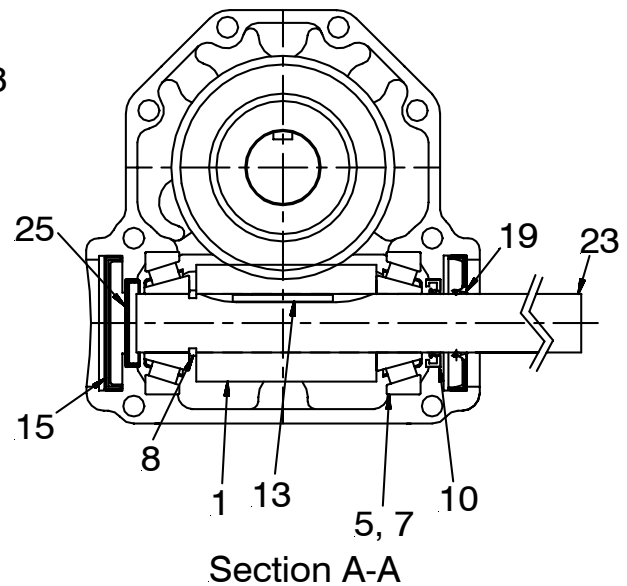
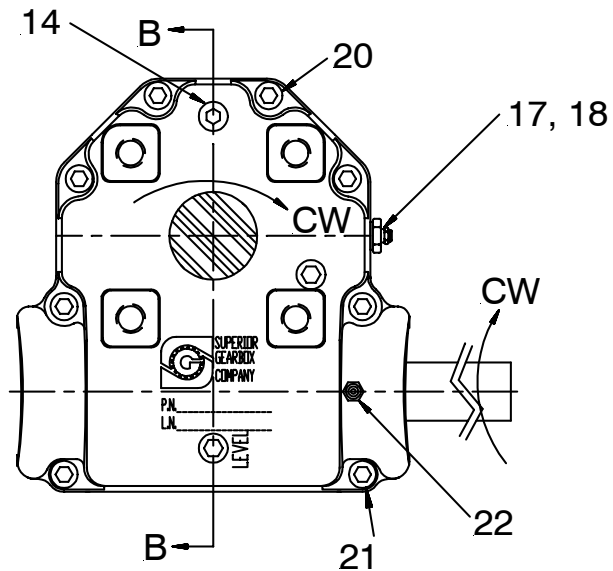

#### Notes:

1. Gear Ratio is: 20:1
2. Torque 3/8-16 Capscrews (20, 21) to 35-40 ft. lbs.

# INSTALLATION AND INSTRUCTIONAL MANUAL

## PV SERIES

### PARTS LIST FOR SUPERIOR GEARBOX ASSEMBLY

62902 (04132-117-00)

After 11/4/02

ITEM	PART NUMBER	QTY.	DESCRIPTION
1	04132-113-01	1	Gear, Worm, LH 20:1
2	04132-113-02	1	Casting, Machined
3	04132-113-03	1	Casting, Machined Thru
4	04132-113-04	1	Gear, Worm 20:1 LH 1/4 Keyway
5	04132-113-05	2	Bearing, Cone TMKN # 15101
6	04132-113-06	2	Bearing, Cone TMKN # 15126
7	04132-113-07	4	Bearing, Cup TMKN # 15245
8	04132-113-08	1	Retaining Ring, Ext. 1.000 Shaft
9	04132-113-09	1	Retaining Ring, Ext 1.250 Shaft
10	04132-113-10	1	Seal, 1.000
11	04132-113-11	1	Seal, 1.250
12	04132-113-12	1	Key, 1/4 x 1/4, 1.080
13	04132-113-13	1	Key, 1/4 x 1/4, 1.580
14	04132-113-14	4	Plug, 1/4-18 NPT SCHD W/3M
15	04132-113-15	1	End Cap, CP-2.312
16	04132-113-16	1	End Cap, CP-2.000
17	04132-113-17	1	Bushing, 1/4 NPT x 1/8 NPT
18	04132-113-18	1	Plug, Vent 5 PSI
19	04132-113-19	1	Seal, 1.000
20	04132-113-20	4	Socket Head Cap Screw, 5/16"-18 x 1.50
21	04132-113-21	4	Socket Head Cap Screw, 5/16"-18 x 1.75
22	04132-113-22	1	Zerk, Grease
23	04132-117-23	1	Shaft, Input
24	04132-117-24	1	Shaft, Output
25	04132-113-25	1	End Cap, CP-1.500
26	04132-113-26	20	Lube / EP 85W140

## SHORT SPINNER ASSEMBLY

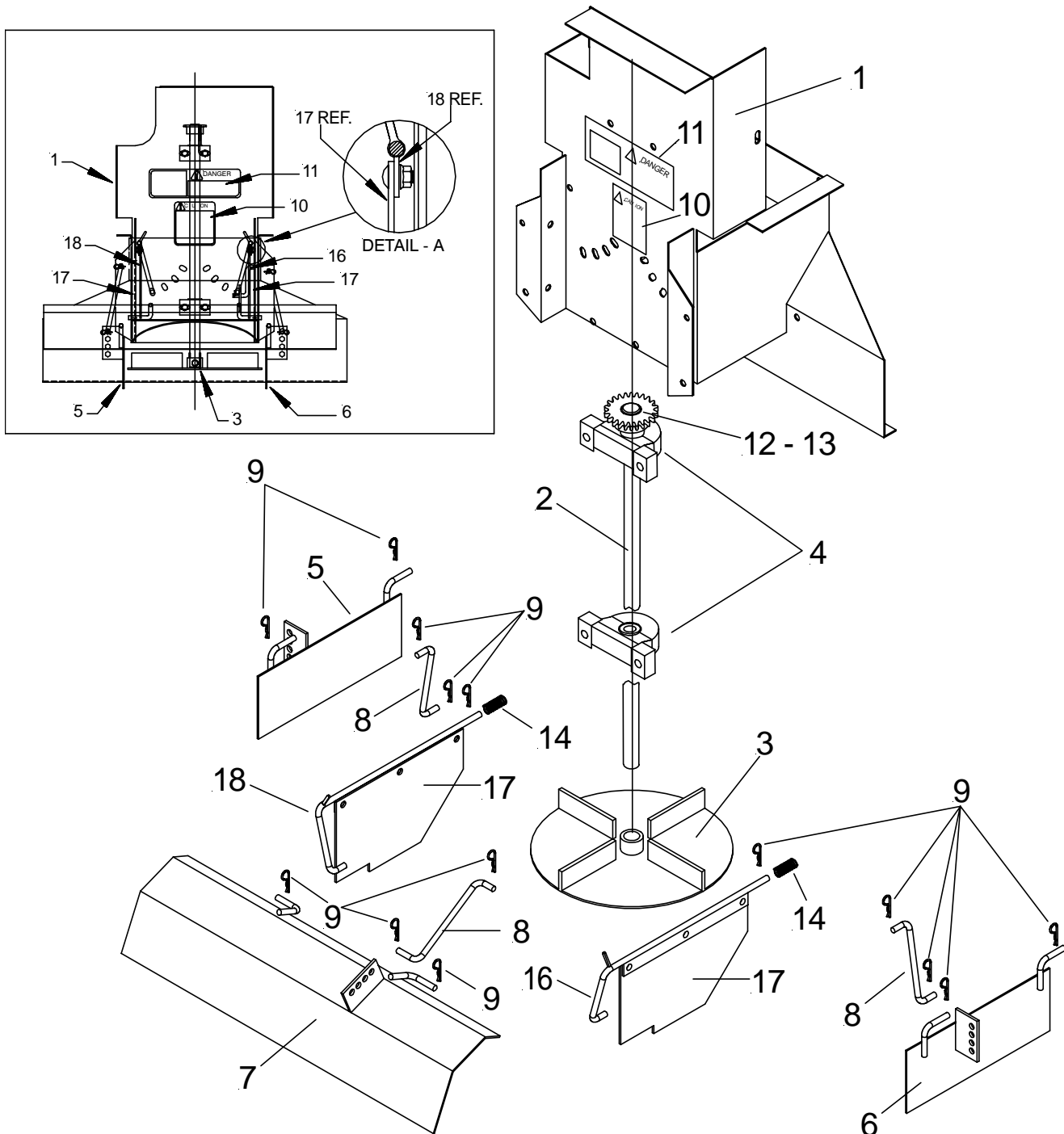



# INSTALLATION AND INSTRUCTIONAL MANUAL

## PV SERIES

### PARTS LIST FOR SPINNER ASSEMBLY SHORT - PARTS ONLY

(ORIGINAL VERSION OF STANDARD)

#### PARTS LIST

ITEM	PART. NO.	QTY.	DESCRIPTION
	00002-296-01	1	Short (Steel) Spinner Assy.
	00002-296-05	1	Short (Steel) W/Poly Disc.
	00002-296-02	1	Short (304SS) Spinner Assy.
1	00115-576-01	1	• Weld, Spinner Frame (Carbon Steel)
	00115-576-02	1	• Weld, Spinner Frame (304 Stainless Steel)
2	00104-804-00	1	• Shaft, Spinner
3	00104-849-00	1	• Weld, Spinner Disc
	04622-033-00	1	• Disc, Poly Spinner
4	04080-079-00	2	• Bearing
4b	04080-011-00	2	• Bearing 1" (Old Style Hopper)
N/S	00104-956-00	2	• Bearing Bracket, Weldment (Old Style)
5	00104-811-00	1	• Weld, L. H. Baffle (Carbon Steel)
	00104-811-01	1	• Weld, L. H. Baffle (304 Stainless Steel)
6	00104-810-00	1	• Weld, R. H. Baffle (Carbon Steel)
	00104-810-01	1	• Weld, R. H. Baffle (304 Stainless Steel)
7	00104-835-00	1	• Weld, Rear Baffle (Carbon Steel)
	00104-835-01	1	• Weld, Rear Baffle (304 Stainless Steel)
8	00115-150-00	3	• Link Bar, S3
9	04011-001-01	12	• Hairpin Keeper
10	04049-045-00	1	• Decal, Caution
11	04049-044-00	1	• Decal, Danger
12	04031-007-00	1	• Key, 1/4" Sq. x 1"
13	04041-085-00	1	• Sprocket Drive 41 B 13
13b	04041-086-00	1	• Sprocket Drive 41 B 19 (Old Style Hopper)
14	04091-028-00	2	• Spring, Compression
15	00115-165-00	1	• Hardware Bag
16	00115-545-01	1	• Weld, R. H. Handle (Carbon Steel)
	00115-545-02	1	• Weld, R. H. Handle (304 Stainless Steel)
17	00115-579-01	2	• Plate, Baffle (Carbon Steel)
	00115-579-02	2	• Plate, Baffle (304 Stainless Steel)
18	00115-580-01	1	• Weld, L. H. Handle (Carbon Steel)
	00115-580-02	1	• Weld, L. H. Handle (304 Stainless Steel)
<b>PARTS LIST FOR HYDRAULIC MOTOR DRIVEN UNITS</b>			
	PART NUMBER	QTY.	DESCRIPTION
	00002-296-03	1	Standard Hydraulic (Steel) Spinner Assy.
	00002-296-04	1	Standard Hydraulic (304SS) Spinner Assy.
	00115-721-01	1	• Weld, Spinner Frame (Carbon Steel)
	00115-721-02	1	• Weld, Spinner Frame (304 Stainless Steel)
	04101-119-00	1	• Motor, Hydraulic
	00106-490-00	1	• Weld, Shaft
	00115-722-01	1	• Bracket, Motor Mount (Carbon Steel)
	00115-722-02	1	• Bracket, Motor Mount (304 Stainless Steel)
	00107-080-00	2	• Bushing
	00107-080-01	2	• Bushing, (304 Stainless Steel)

# INSTALLATION AND INSTRUCTIONAL MANUAL

## PV SERIES

### INTERMEDIATE - STANDARD SPINNER ASSEMBLY

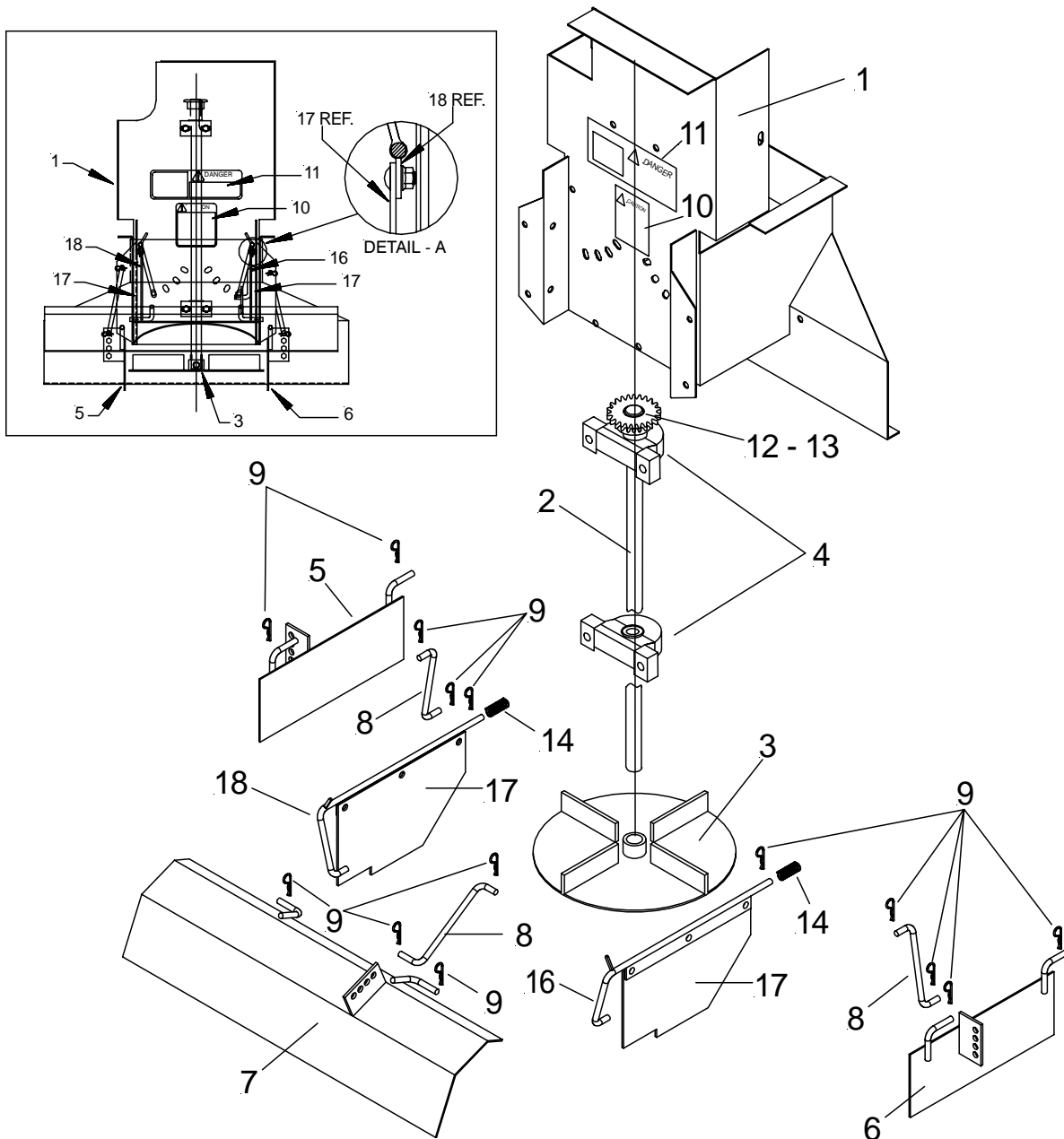

# INSTALLATION AND INSTRUCTIONAL MANUAL

## PV SERIES

### PARTS LIST FOR EXTENDED SPINNER ASSEMBLY INTERMEDIATE - STANDARD (NEW)

#### PARTS LIST

ITEM	PART. NO.		QTY.	DESCRIPTION
		00002-296-13	1	Standard (Steel) W/Poly Disc.
		00002-296-14	1	Standard (304SS) Spinner Assy.
1		00119-091-01	1	• Weld, Spinner Frame (Carbon Steel)
		00119-091-02	1	• Weld, Spinner Frame (304 Stainless Steel)
2		00119-083-00	1	• Shaft, Spinner
3		00104-849-00	1	• Weld, Spinner Disc
		04622-033-00	1	• Disc, Poly Spinner
4		04080-079-00	2	• Bearing
4b		04080-011-00	2	• Bearing 1" (Old Style Hopper)
N/S		00104-956-00	2	• Bearing Bracket, Weldment (Old Style)
5		00104-811-00	1	• Weld, L. H. Baffle (Carbon Steel)
		00104-811-01	1	• Weld, L. H. Baffle (304 Stainless Steel)
6		00104-810-00	1	• Weld, R. H. Baffle (Carbon Steel)
		00104-810-01	1	• Weld, R. H. Baffle (304 Stainless Steel)
7		00104-835-00	1	• Weld, Rear Baffle (Carbon Steel)
		00104-835-01	1	• Weld, Rear Baffle (304 Stainless Steel)
8		00115-150-00	3	• Link Bar, S3
9		04011-001-01	12	• Hairpin Keeper
10		04049-045-00	1	• Decal, Caution
11		04049-044-00	1	• Decal, Danger
12		04031-007-00	1	• Key, 1/4" Sq. x 1"
13		04041-085-00	1	• Sprocket Drive 41 B 13
13b		04041-086-00	1	• Sprocket Drive 41 B 19 (Old Style Hopper)
14		04091-028-00	2	• Spring, Compression
15		00115-165-00	1	• Hardware Bag
16		00115-545-01	1	• Weld, R. H. Handle (Carbon Steel)
		00115-545-02	1	• Weld, R. H. Handle (304 Stainless Steel)
17		00115-579-01	2	• Plate, Baffle (Carbon Steel)
		00115-579-02	2	• Plate, Baffle (304 Stainless Steel)
18		00115-580-01	1	• Weld, L. H. Handle (Carbon Steel)
		00115-580-02	1	• Weld, L. H. Handle (304 Stainless Steel)
<b>PARTS LIST FOR HYDRAULIC MOTOR DRIVEN UNITS</b>				
ITEM	PART. NO.		QTY.	DESCRIPTION
		00002-296-15	1	Extended Hydraulic (Steel) Spinner Assy.
		00002-296-16	1	Extended Hydraulic (304SS) Spinner Assy.
		00119-092-01	1	• Weld, Spinner Frame (Carbon Steel)
		00119-092-02	1	• Weld, Spinner Frame (304 Stainless Steel)
		04101-119-00	1	• Motor, Hydraulic
		00119-085-00	1	• Weld, Shaft
		00115-722-01	1	• Bracket, Motor Mount (Carbon Steel)
		00115-722-02	1	• Bracket, Motor Mount (304 Stainless Steel)
		00107-080-00	2	• Bushing
		00107-080-01	2	• Bushing, (304 Stainless Steel)

# INSTALLATION AND INSTRUCTIONAL MANUAL

## PV SERIES

### EXTENDED SPINNER ASSEMBLY

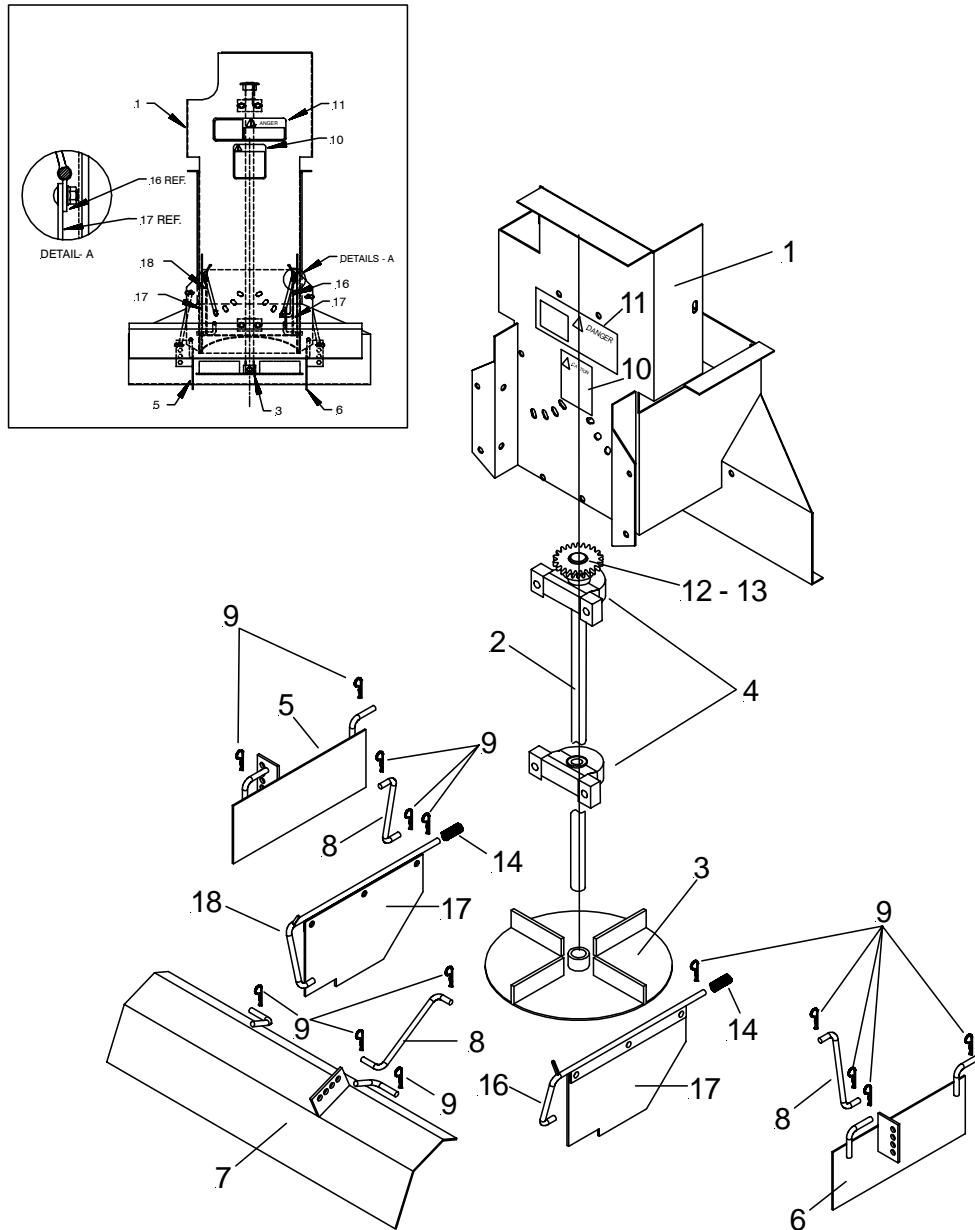

# INSTALLATION AND INSTRUCTIONAL MANUAL

## PV SERIES

### PARTS LIST FOR EXTENDED SPINNER ASSEMBLY EXTENDED - PARTS ONLY

#### PARTS LIST

ITEM	PART. NO.		QTY.	DESCRIPTION
		00002-296-02	1	Extended (Steel) Spinner Assy.
		00002-296-10	1	Extended (Steel) W/Poly Disc.
		00002-296-07	1	Extended (304SS) Spinner Assy.
1		00115-658-01	1	• Weld, Spinner Frame (Carbon Steel)
		00115-658-02	1	• Weld, Spinner Frame (304 Stainless Steel)
2		00104-833-00	1	• Shaft, Spinner
3		00104-849-00	1	• Weld, Spinner Disc
		04622-033-00	1	• Disc, Poly Spinner
4		04080-079-00	2	• Bearing
4b		04080-011-00	2	• Bearing 1" (Old Style Hopper)
N/S		00104-956-00	2	• Bearing Bracket, Weldment (Old Style)
5		00104-811-00	1	• Weld, L. H. Baffle (Carbon Steel)
		00104-811-01	1	• Weld, L. H. Baffle (304 Stainless Steel)
6		00104-810-00	1	• Weld, R. H. Baffle (Carbon Steel)
		00104-810-01	1	• Weld, R. H. Baffle (304 Stainless Steel)
7		00104-835-00	1	• Weld, Rear Baffle (Carbon Steel)
		00104-835-01	1	• Weld, Rear Baffle (304 Stainless Steel)
8		00115-150-00	3	• Link Bar, S3
9		04011-001-01	12	• Hairpin Keeper
10		04049-045-00	1	• Decal, Caution
11		04049-044-00	1	• Decal, Danger
12		04031-007-00	1	• Key, 1/4" Sq. x 1"
13		04041-085-00	1	• Sprocket Drive 41 B 13
13b		04041-086-00	1	• Sprocket Drive 41 B 19 (Old Style Hopper)
14		04091-028-00	2	• Spring, Compression
15		00115-165-00	1	• Hardware Bag
16		00115-545-01	1	• Weld, R. H. Handle (Carbon Steel)
		00115-545-02	1	• Weld, R. H. Handle (304 Stainless Steel)
17		00115-579-01	2	• Plate, Baffle (Carbon Steel)
		00115-579-02	2	• Plate, Baffle (304 Stainless Steel)
18		00115-580-01	1	• Weld, L. H. Handle (Carbon Steel)
		00115-580-02	1	• Weld, L. H. Handle (304 Stainless Steel)
<b>PARTS LIST FOR HYDRAULIC MOTOR DRIVEN UNITS</b>				
ITEM	PART. NO.		QTY.	DESCRIPTION
		00002-296-08	1	Extended Hydraulic (Steel) Spinner Assy.
		00002-296-09	1	Extended Hydraulic (304SS) Spinner Assy.
		00115-720-01	1	• Weld, Spinner Frame (Carbon Steel)
		00115-720-02	1	• Weld, Spinner Frame (304 Stainless Steel)
		04101-119-00	1	• Motor, Hydraulic
		00111-283-00	1	• Weld, Shaft
		00115-722-01	1	• Bracket, Motor Mount (Carbon Steel)
		00115-722-02	1	• Bracket, Motor Mount (304 Stainless Steel)
		00107-080-00	2	• Bushing
		00107-080-01	2	• Bushing, (304 Stainless Steel)

# INSTALLATION AND INSTRUCTIONAL MANUAL

## PV SERIES

### NAME PLATE INFORMATION

- When ordering parts or requesting information or assistance, always include the information listed below.
- The Model Number and Serial Number for the Spreader are shown on the name plate.
- The space below is provided as a convenient place to record these numbers; just fill in the blanks.

MODEL NUMBER \_\_\_\_\_

SERIAL NUMBER \_\_\_\_\_

DATE PURCHASED \_\_\_\_\_

DEALER PURCHASED FROM \_\_\_\_\_

DEALER'S SERVICE

DEPARTMENT PHONE NUMBER \_\_\_\_\_

### EXPLANATION OF SERIAL NUMBER DECAL

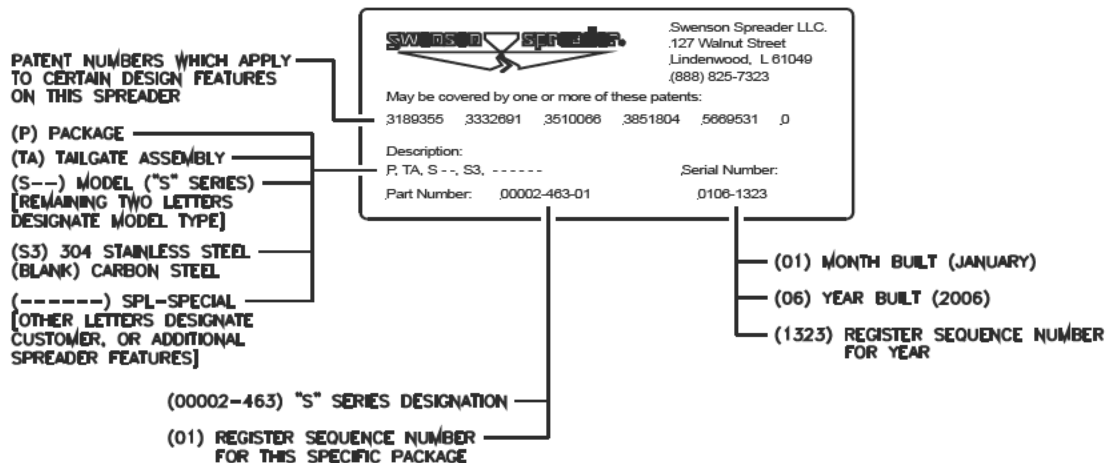

S:\00111\00111-389-00RTJPD

CALL YOUR AUTHORIZED SWENSON SPREADER DEALER FOR PARTS AND SERVICE  
SWENSON SPREADER (815) 393-4455  
TOLL FREE (888) 825-7323  
FAX (866) 310-0300

email: [swensonsales@swensonspreader.com](mailto:swensonsales@swensonspreader.com)

NOTICE: INSTRUCTIONAL MATERIAL AND PARTS LISTS INCLUDED IN THIS MANUAL  
ARE SUBJECT TO CHANGE WITHOUT NOTICE.

# INSTALLATION AND INSTRUCTIONAL MANUAL

## PV SERIES



Dealers have the responsibility of calling to the attention of their customers the following warranty prior to acceptance of an order from that customer for any SWENSON® product.

## WARRANTY

### WHAT THIS WARRANTY COVERS

Swenson Spreader LLC (hereinafter "Swenson") is committed to assuring Customer satisfaction with the Spreader (hereinafter "Product"). Swenson warrants to the original owner (hereinafter "Purchaser") of the Product to be free from defects in material and workmanship for the following term: Swenson warrants ALL PARTS AND ASSEMBLIES to be free from defects in material and workmanship for a period of one year from the date of purchase. Installation of the Product must be in accordance with Swenson's instructions. This warranty extends to the Purchaser and may not be assigned without the prior written approval of Swenson; except a distributor may assign this warranty to the first titled owner of the Product.

If a Product has a defect in material or workmanship covered by the warranty, Swenson will (at our option) either replace or repair said part. Swenson's has sole discretion as to repair of defects covered by this warranty, or replacement of the Product. Swenson's responsibilities as described herein shall not exceed the amount of the purchase of the Product.

### WHAT THIS WARRANTY DOES NOT COVER

Swenson's warranty does not extend to Product which have been misused, abused, improperly installed, repaired with non-genuine Swenson parts, improperly cared for, if materials such as lava rock or cinders are used, or for which payment has not been made. The warranty is void if repairs or alterations to the Product are made by unauthorized persons, or the Product serial numbers have been altered or defaced.

All gasoline engines and hydraulic pumps are warranted by their manufacturer and not by Swenson Spreader LLC. Electrical or hydraulic components are not to be disassembled without the express written permission of Swenson Spreader LLC.

THERE ARE NO WARRANTIES, EXPRESS OR IMPLIED, WHICH EXTEND BEYOND THE DESCRIPTION ON THE FACE HEREOF. THERE IS NO IMPLIED WARRANTY OF MERCHANTABILITY OR FITNESS FOR A PARTICULAR PURPOSE. SWENSON'S MAXIMUM OBLIGATION AND LIABILITY UNDER THIS WARRANTY SHALL BE LIMITED TO AN AMOUNT EQUAL TO THE PRESENT PURCHASE PRICE FOR THE SWENSON PRODUCT. SWENSON SHALL NOT BE LIABLE FOR ANY LOSS OR DAMAGE, WHETHER DIRECT OR INDIRECT, INCIDENTAL, CONSEQUENTIAL OR OTHERWISE ARISING OUT OF BREACH OF THIS WRITTEN WARRANTY OR ANY IMPLIED WARRANTY. Some states do not allow limitations on how long an implied warranty will last or the exclusion or limitation of incidental or consequential damages.

Defective parts returned to Swenson Spreader LLC must be accompanied by the following information:

RG#	_____
Spreader Model	_____
Serial Number	_____
Date Installed	_____
Where Purchased	_____

Purchaser accepts these terms and warranty limitations unless product is returned within fifteen days for full refund of purchase price.

Effective 4/15/05

**INSTALLATION AND INSTRUCTIONAL MANUAL**  
**PV SERIES**



**SWENSON SPREADER LLC**  
**P.O. BOX 127**  
**LINDENWOOD, ILLINOIS 61049-0127**

**PHONE: (815)393-4455**  
**TOLL FREE: (888)825-7323**  
**SALES & SERVICE FAX: (866)310-0300**

**email: [swensonsales@swensonspreader.com](mailto:swensonsales@swensonspreader.com)**  
**website: [www.swensonspreader.com](http://www.swensonspreader.com)**

**IMPORTANT**  
**INFORMATION**  
**ENCLOSED**