

INSTALLATION and OPERATING INSTRUCTION MANUAL

V-BOX MATERIAL SPREADERS LPV SERIES

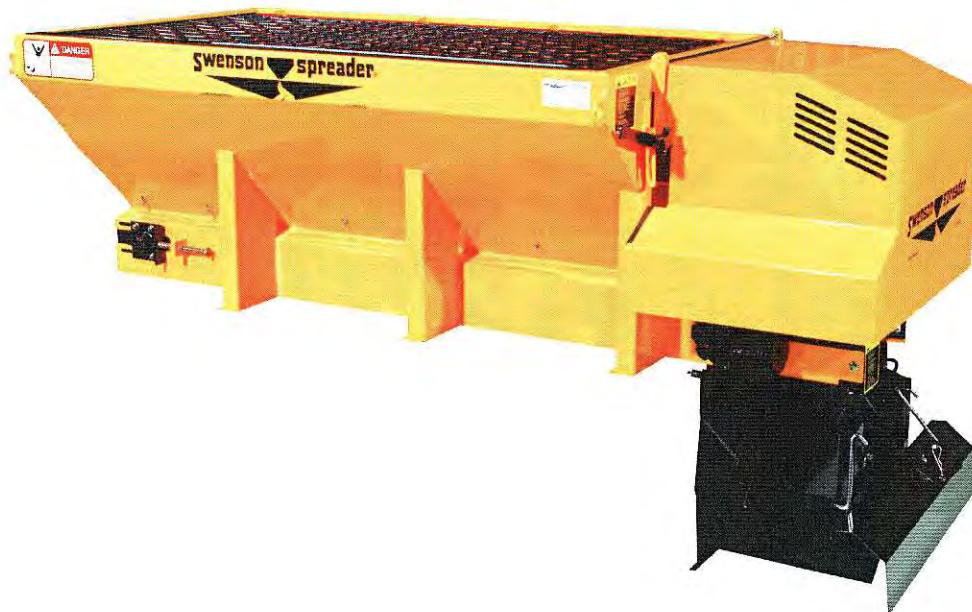

INDEX

SAFETY ALERT	2
INSTALLATION & ASSEMBLY INSTRUCTIONS	3 - 5
ELECTRIC WIRING	6 - 7
LOADING	8
SPREADER OPERATION	9 - 10
SPREADER MAINTENANCE	11
SPREADER PARTS LISTS & EXPLODED VIEWS	12 - 25
NAME PLATE INFORMATION	26
WARRANTY INFORMATION	27



THE BEST SAFETY DEVICE IS A CAREFUL OPERATOR!

SAFETY ALERT SYMBOL



THIS SYMBOL MEANS **ATTENTION!**
BECOME ALERT!
YOUR SAFETY IS INVOLVED!

PLEASE READ AND UNDERSTAND COMPLETELY BEFORE DOING!

SAFE EQUIPMENT INSTALLERS and OPERATORS:



TURN OFF ALL POWER BEFORE PERFORMING ANY SERVICE OPERATIONS

- FOLLOW RECOMMENDED OPERATING PROCEDURES.
- KEEP EQUIPMENT IN SAFE OPERATING CONDITION AT ALL TIMES.
- RECOGNIZE AND AVOID HAZARDS WHILE OPERATING, SERVICING AND MAINTAINING EQUIPMENT.



CAUTION

1. KEEP ALL SHIELDS IN PLACE.
2. MAKE CERTAIN EVERYONE IS CLEAR BEFORE STARTING MACHINE OR MOVING VEHICLE.
3. KEEP HANDS, FEET, AND CLOTHING AWAY FROM ALL POWER DRIVEN PARTS.
4. DISENGAGE PTO, SHUT OFF HYDRAULIC VALVE, AND SET PARKING BRAKE BEFORE LEAVING OPERATORS POSITION. MAKE SURE ALL MOVEMENT HAS STOPPED BEFORE SERVICING, UNCLOGGING, OR CLEANING MACHINE.
5. USE FLASHING LIGHTS WHEN OPERATING MACHINE.
6. MAKE SURE MACHINE IS SOLIDLY SUPPORTED WHEN IT IS BEING MOUNTED, DISMOUNTED, OR STORED.

IF DEFACED - ORDER PART NO. 04049 045 00

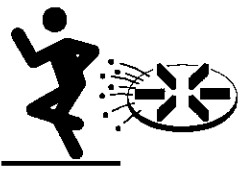





DANGER

Stay clear while spinner is turning

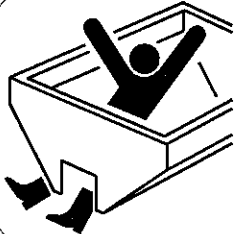
IF DEFACED - ORDER PART NO. 04049 044 00





DANGER

Turn power off before servicing or cleaning

IF DEFACED - ORDER PART NO. 04049 182 00

NOTICE: INSTRUCTIONAL MATERIAL AND PARTS LISTS INCLUDED IN THIS MANUAL ARE SUBJECT TO CHANGE WITHOUT NOTICE.

INSTALLATION AND ASSEMBLY INSTRUCTIONS

INSTALLATION INSTRUCTIONS:

The LPV Spreader can be mounted and stored as a single unit. The LPV Spreader will mount on most 1/2-ton thru heavy-duty pickup trucks.



CAUTION!

READ ALL OF THE INSTALLATION INSTRUCTIONS BEFORE STARTING.



CAUTION!

BEFORE STARTING, VERIFY THAT THIS MOUNTING METHOD IS ACCEPTABLE TO THE VEHICLE MANUFACTURER.



WARNING!

BEFORE BEGINNING ANY INSTALLATION ON THIS UNIT, DISCONNECT THE VEHICLE'S NEGATIVE BATTERY CABLE(S).



WARNING!

THE SPREADER UNIT MUST BE SECURELY FASTENED TO THE VEHICLE. FAILURE TO PROPERLY RESTRAIN THE UNIT COULD PERMIT THE UNIT TO BREAK FREE FROM THE TRUCK AND CREATE A POTENTIAL FOR A LIFE THREATENING ACCIDENT.

The spreader is designed to sit flat on the bed of the truck, supported by the longitudinals/sides. **DO NOT SUPPORT THE SPREADER BY THE BODY JACKS ALONE! UNIT IS NOT DESIGNED FOR CHASSIS MOUNT APPLICATIONS!**

DO NOT OVERLOAD THE VEHICLE

It is possible to overload the vehicle by improperly mounting or overloading the spreader. This could result in dangerous stability and braking problems. Always consult and follow the truck manufacturer's instructions.

SPREADER INSTALLATION:

1. Place the spreader in the rear of the truck with the motor to the rear of the truck. Center the spreader (side to side) in the truck.
2. Position the spreader in the truck, just short of making contact with the rearmost part of the truck bed, bumper, pintle hook etc (Approx 18"). Bolt the unit to the truck using a minimum of four (4) 1/2" Grade 5 bolts and washers and locknuts.
3. Attach the hold down at each corner of the hopper as shown on page 5. Locate and drill four .531 (17/32") diameter holes for eyebolts in the truck bed. Straps must be positioned at opposing angles so that the spreader cannot slide forward or rearward. Assemble ratchet/strap to eye bolts. Tighten hold downs evenly. Do not over tighten, damage will result to the spreader or the truck.

Note: If truck is equipped with sufficient tie downs, they may be used in place of eyebolt.

SPINNER INSTALLATION:



CAUTION!

INSURE THAT THE SPREADER CANNOT TIP WHEN THE SPINNER ASSEMBLY IS ATTACHED.

4. Raise engine shroud, position spinner assembly so that front is on the rear longitudinals. lift backplate to mate-up with bottom of engine mounting plate and sides of longitudinals, attach with provided hardware.
5. Attach spinner disc to spinner shaft with bolt and nylon locknut provided. Attach spinner baffles to spinner frame using flatwashers and cotter pins provided.
6. Install roller chain between gearbox and spinner shaft. Align Sprockets on gearbox and spinner shaft with each other. Adjust roller chain tension by loosening all 4 spinner shaft bearing bolts on the rear panel and adjusting position of spinner shaft assembly (do not adjust too tight), re-tighten all 4 spinner shaft bearing bolts (spinner shaft must be straight up and down).

INSTALLATION AND ASSEMBLY INSTRUCTIONS

CENTER LIFT

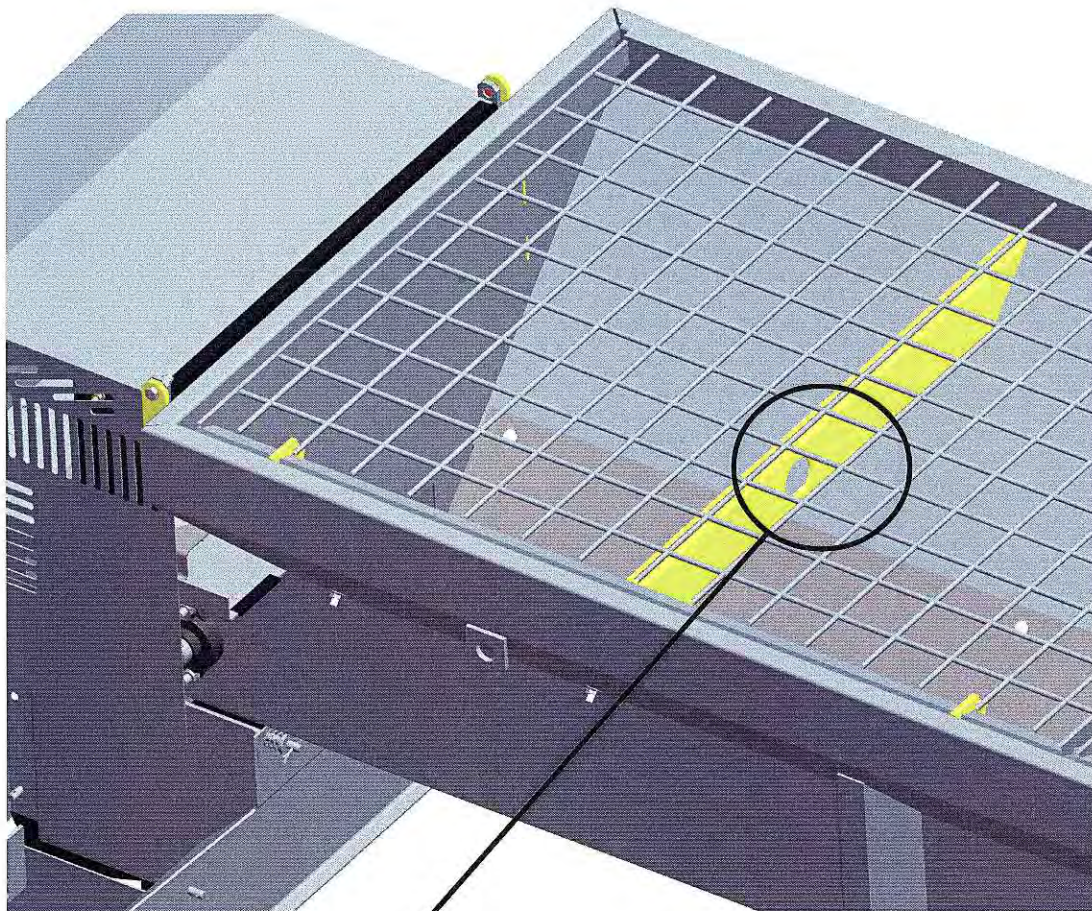

Place lift hook in hole

1. Center lift hook should be used for lifting spreader to install or remove from truck.
2. Do not lift spreader with material in hopper.



WARNING!

**ALWAYS USE SUFFICIENTLY RATED CHAIN
WITH SAFETY HOOKS WHEN LIFTING
SPREADER.**

INSTALLATION AND ASSEMBLY INSTRUCTIONS

(00002-306-00)



PARTS LIST HOLD DOWN KIT (OPTIONAL)

<u>Item</u>	<u>Part Number</u>	<u>Qty.</u>	<u>Description</u>
1	04068-038-00	4	Ratchet/Strap (Optional)
N/S	04048-504-02	4	Bolt, 1/2" Eye
N/S	04003-804-06	4	Locknut, 1/2-13 Nylon Insert ZP
N/S	04003-801-11	4	Nut, 12-13 Hex ZP
N/S	04004-002-16	8	Flatwasher, 3/4" U.S.S. ZP

N/S = NOT SHOWN

NOTE: If truck is equipped with sufficient tie downs, they may be used in place of eyebolt.

INSTALLATION INSTRUCTIONS

WIRING ELECTRIC DRIVE SPREADERS



WARNING!

USE SAFETY GLASSES OR OTHER FACE PROTECTION AGAINST POSSIBLE BATTERY EXPLOSION. DO NOT SMOKE AND AVOID OTHER SOURCES OF IGNITION.



WARNING!

BEFORE BEGINNING ANY INSTALLATION ON THIS UNIT, DISCONNECT THE VEHICLES NEGATIVE BATTERY CABLE(S).

POWER REQUIREMENTS:

MINIMUM:

Trucks Mfg's Snow Plow Package With Hi-Amp (135 amp) Alternator

RECOMMENDED:

Dual Batteries or Dual Alternators.

NOTE:

Use dielectric grease on all electrical connections.

Keep all wires away from sharp, hot or moving parts.

SPREADER WIRING MOUNTING:

1. In engine compartment of truck, find a suitable mounting location for the circuit breaker/relay panel (area should be dry and protected from road splash) within 14" of the main battery. Mount panel with self-tapping screws supplied.
2. Attach the 18" long battery cable to the circuit breaker terminal marked BAT. (**DO NOT ATTACH TO BATTERY AT THIS TIME**)
3. At rear of truck, locate the 22ft long truck side wiring harness from rear bumper (plug side to rear) and along the truck frame to the circuit breaker/relay panel in the engine compartment. (Harness is long enough for most compact thru regular full size standard cab/8ft long bed pick-up trucks. For extended and crew cab the optional 5ft extension wiring harness is required.)
4. Attach Black (shorter) cable of the truck side wiring harness to a clean location on the trucks frame. Connect Red (longer) cable to the circuit breaker/relay panel. Secure all wiring with wire ties provided. Excess cable must be coiled up and secured.

5. Connect spreader side wiring cable to electric motor. The electric motor is a one directional design, energizing either terminal, motor will turn CW when viewed from the top.

SPREADER CONTROL MOUNTING:



WARNING!

CONSULT VEHICLE MANUFACTURER FOR ACCEPTABLE MOUNTING LOCATIONS.

THE CONTROL SWITCH COULD INTERFERE WITH THE AIR BAG(S) AND THE OTHER FUNCTIONS OF THE OCCUPANT PROTECTIVE SYSTEMS, SUCH AS KNEE BOLSTERS!

6. Select a suitable location in the cab of the truck to mount the spreader control switch. Drill 1/2" diameter mounting hole for switch. (**DO NOT MOUNT SWITCH AT THIS TIME**)
7. Route 14ga black wire from switch location thru grommated wire exit in cab's firewall to the circuit breaker/relay panel. Cut wire to size and attach terminals. Connect to switch and relay.
8. Using 14ga white wire, cut (2) ground wires to size and attach terminals, (1st) from switch location to ground, (2nd) from relay to ground. Connect wires.
9. Using remaining 14ga black wire, cut power wire to size and attach terminals from switch location to trucks fuse panel. Assemble switch and switch guard in mounting hole. Connect wires to switch and a **KEY OPERATED** circuit on fuse panel. (**DO NOT USE A CIRCUIT THAT IS USED FOR AN OCCUPANT SAFETY SYSTEM**)
10. With all switches in **OFF** position, connect the negative battery cable(s) to battery. Plug cable from spreader into socket mounted on truck.
11. Close shroud, spreader is now ready for test run.

NOTE: SUPPLIED TERMINALS ARE HEAT SEALABLE



WARNING!

NEVER OPERATE MACHINE WITH ENGINE SHROUD REMOVED. NEVER CLIMB INTO THE HOPPER WHILE IT IS OPERATING OR CAPABLE OF BEING OPERATED. SERIOUS INJURY OR DEATH MIGHT OCCUR.

LOADING

This manual covers vehicles which have been recommended for carrying the hopper spreader. Please see your local dealer for proper vehicle applications.



WARNING!

OVERLOADING COULD RESULT IN AN ACCIDENT OR DAMAGE. DO NOT EXCEED GVWR OR GAWR AS FOUND ON THE DRIVER-SIDE CORNERPOST OF VEHICLE.



CAUTION!

READ AND ADHERE TO MANUFACTURER'S ICE CONTROL PACKAGE LABELING INCLUDING MATERIAL SAFETY DATA SHEET REQUIREMENTS.

DETERMINING VEHICLE PAYLOAD

1. Install spreader and optional equipment according to the instructions.
2. Install or attach any other equipment that will be on the vehicle while the spreader will be in use (step bumper, trailer hitch, snowplows, etc.). Fill gas tanks.
3. Obtain the Gross Vehicle Weight Rating (GVWR), Front Gross Axle Weight Rating (FGAWR), and Rear Gross Axle Weight Rating (RGAWR) from the certification label located inside the driver-side door jam.
4. With the occupants in the truck for normal spreader operation, weigh the vehicle to obtain gross vehicle weight (GVW).
5. Subtract the GVW from the GVWR to determine the available material payload.
6. Obtain the weight per cubic yard (lb./cu. yd.) of the desired material. Divide the weight into the payload to determine the maximum volume of material that can be carried.
7. Compare the maximum volume to determine the maximum height of the material in the hopper spreader.
8. Fill hopper with the material to the calculated height. Reweigh vehicle with occupants and verify the GVW, Front Gross Axle Weight, and Rear Gross Axle Weight are less than the vehicle's ratings.
9. Repeat steps 7 and 8 for each type of material.

Material Weights (Reference Only)

Material	Density (lb. per cubic yd.)
Salt - Dry	2,025
Coarse Sand - Dry	2,700
Course Sand - Wet	3,375

SPREADER OPERATION

- A. Start the trucks engine and engage the electric motor. The amount of material spread will depend on feedgate opening. Increasing feedgate height will increase amount of material being spread. Decreasing feedgate height will decrease amount of material being spread.
- B. Spread pattern depends on baffle settings and spread width is 4ft-20ft.
 - 1. Internal baffle adjustments will move the spread pattern to the right or left.
 - 2. External baffle adjustments will block spreading to the rear, right or left side.



WARNING!

ALWAYS STAND AT A SAFE DISTANCE AWAY FROM THE SPINNER WHILE OPERATING. ALWAYS WEAR EYE PROTECTION WHEN OUTSIDE OF THE TRUCK CAB WHILE SPREADER IS RUNNING.



CAUTION!

DO NOT LEAVE UNUSED MATERIAL IN HOPPER.

- 3. Material could freeze causing the unit to not function correctly. Hopper should be emptied and cleaned after each use.

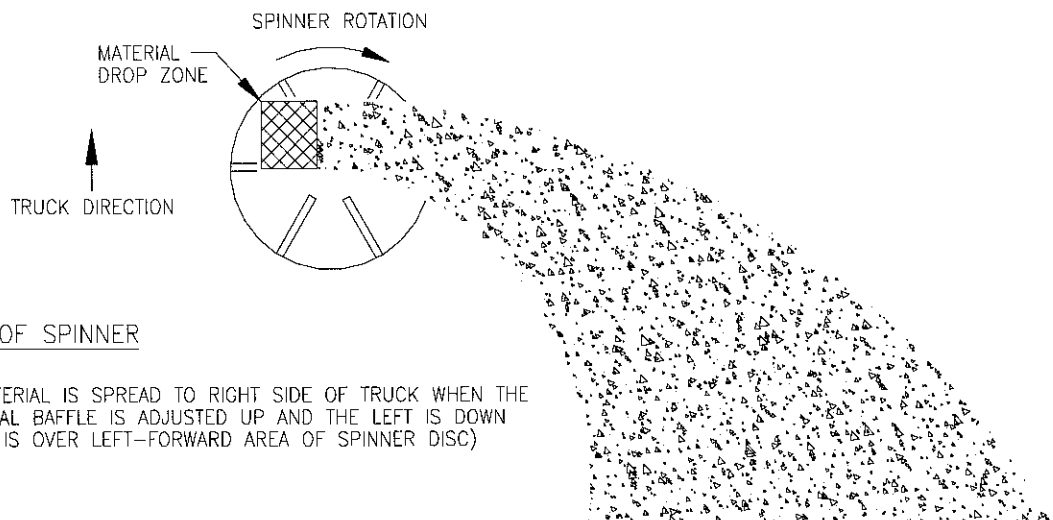

TOP VIEW OF SPINNER

BULK OF MATERIAL IS SPREAD TO RIGHT SIDE OF TRUCK WHEN THE RIGHT INTERNAL BAFFLE IS ADJUSTED UP AND THE LEFT IS DOWN (DROP ZONE IS OVER LEFT-FORWARD AREA OF SPINNER DISC)

SPREADER OPERATION

(Continued)

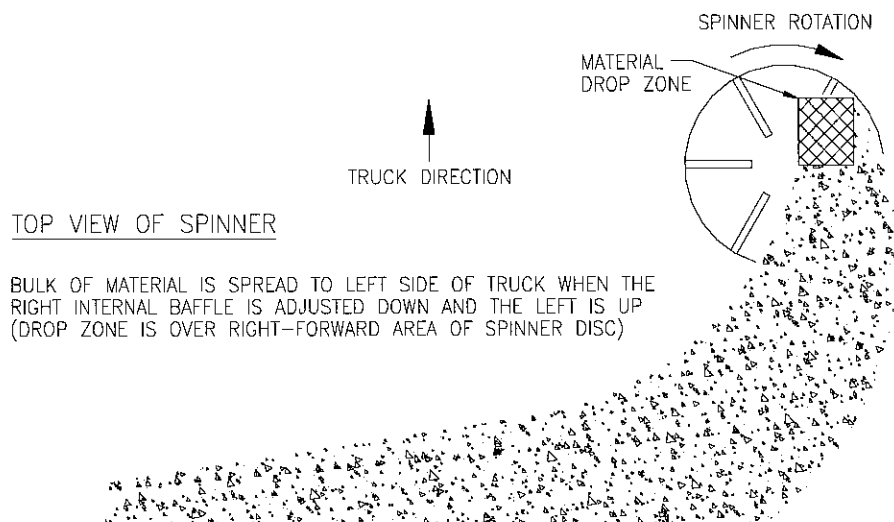
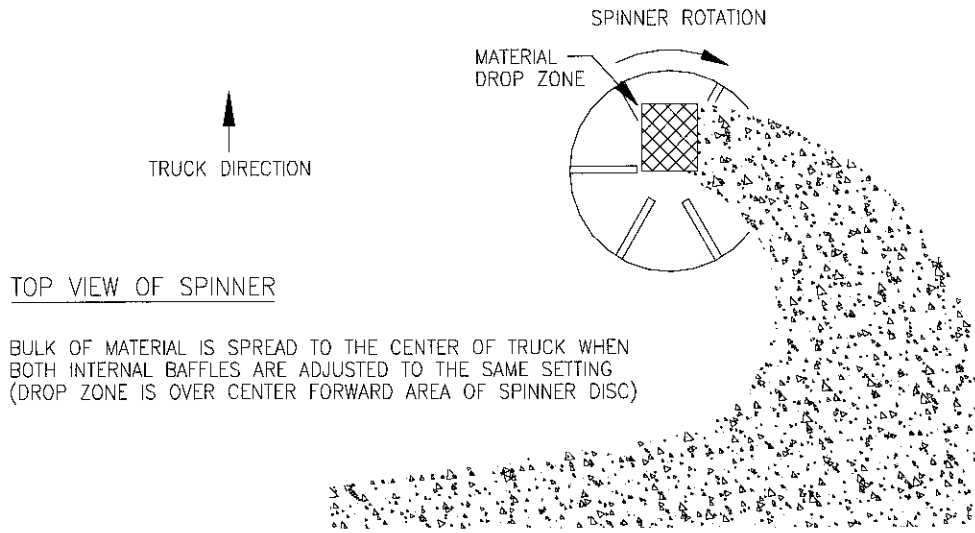

MAINTENANCE



WARNING!

DO NOT ATTEMPT TO LIFT SPREADER BY THE CENTER LIFT OR CORNER LIFT HOOKS WITH MATERIAL IN THE SPREADER.



WARNING!

BEFORE BEGINNING ANY MAINTENANCE ON SPREADER, DISCONNECT SPREADER BATTERY LEADS.

1. Grease idler bearings on idler shaft take-up assembly, outboard bearing on gearbox output shaft, and spinner bearings every ten hours of operation.
2. Grease input shaft bearing on gearbox every fifty hours of operation. **CAUTION!** Over greasing may cause seal damage. The gearbox must be filled to oil level plug with SAE 90 gear type lubricant. Keep breather plug clean.
3. Drag chain slack on V-boxes should be checked periodically and taken up if distance between center line of front sprocket and point where chain contacts lower flange on longitudinal is less than twenty (15) inches. **CAUTION!** Over tightening conveyor chain can cause serious drive train problems. Above distance must not exceed thirty-five (30) inches.
4. If the spreader is equipped with a gasoline engine, it should be maintained per engine manufacturer's instruction. (Instructions and parts book is enclosed.
5. V-belt/Chain tension must be maintained. The V-belt/Chain can be tightened by loosening motor hold-down bolts and sliding motor as required. Make sure the spinner shaft is straight up and down before retightening. Oil drive chains before each use.
7. Spreader should be emptied and cleaned after each use. Material could freeze causing the unit to not function correctly.
8. If chain becomes stuck or "frozen" to the floor to the point where the drive system cannot pull the load, never attempt to free chain using a pipe wrench or any other tool on the output shaft. The gearbox is designed to accept torque from input shaft only. Trying to turn output shaft will strip the gears, thus voiding the warranty.
9. To minimize problems and extend the life of the drive system, the following is highly recommended.
 - a. Before starting unit, make sure the drag chain is free (not stuck or "frozen" to the floor). If the drag chain is stuck, this can cause the drive system to burn up.

CAUTION! Overtightening may damage gearbox.

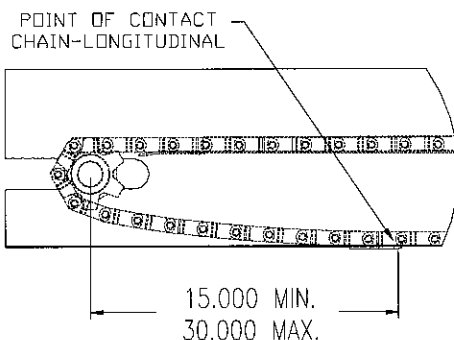

DETAIL - CHAIN TENSION

OFF-SEASON STORAGE:

1. Grease all bearings, oil drag chain and roller chains.
2. Remove spreader from truck, spinner may remain attached if stored on stands other wise remove spinner also (**DO NOT STORE SPREADER ON THE GROUND WITH SPINNER ATTACHED**).

PARTS LIST FOR HOPPER

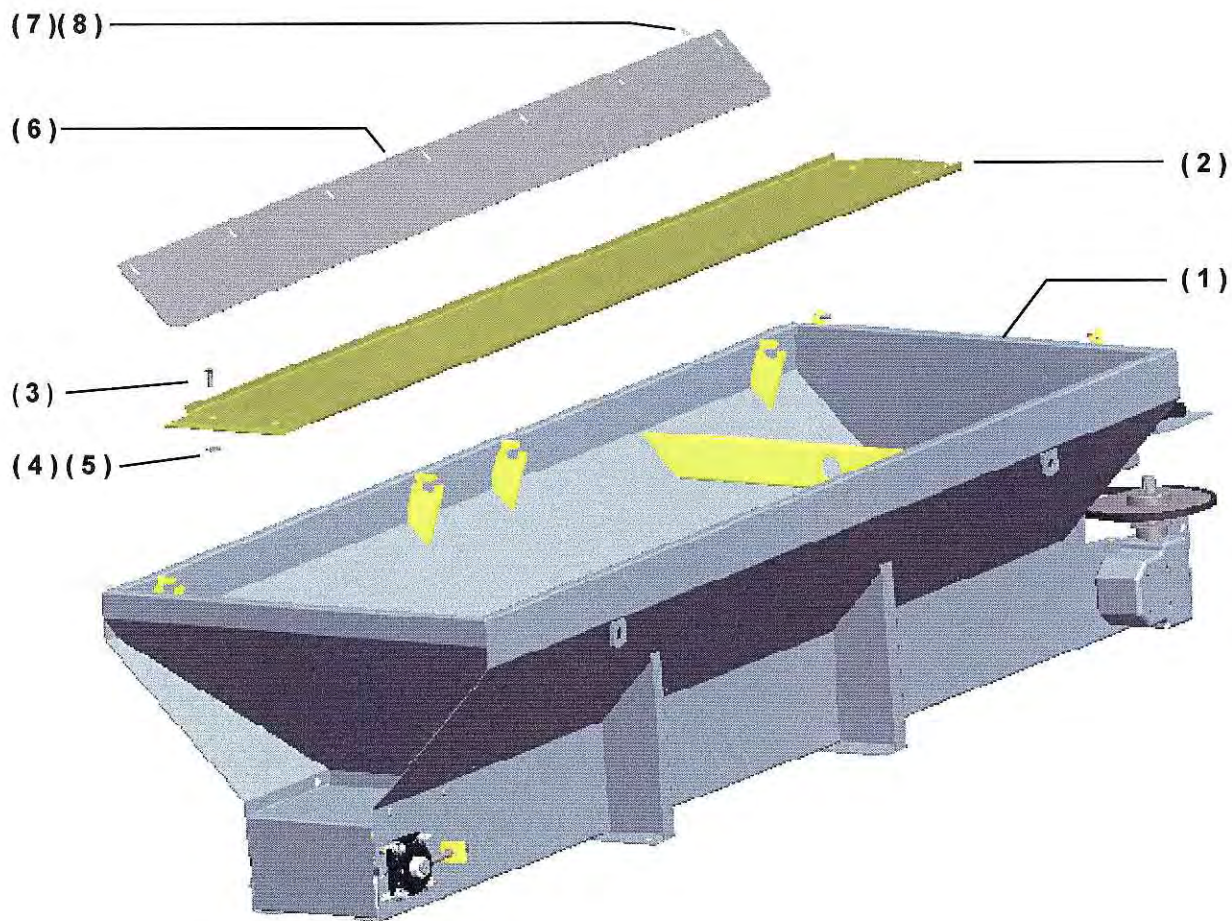

<u>Item</u>	<u>Part Number</u>	<u>Qty.</u>	<u>Description</u>
1	00117-392-05	1	Weld, Hopper, 5ft
	00117-392-06	1	Weid, Hopper, 6ft
	00117-392-07	1	Weld, Hopper, 7ft
	00117-392-08	1	Weld, Hopper, 8ft
2	00118-319-05	1	Forming, Floor, 5ft
	00118-319-06	1	Forming, Floor, 6ft
	00118-319-07	1	Forming, Floor, 7ft
	00118-319-08	1	Forming, Floor, 8ft
3	04003-018-05	4	Screw, 3/8-16 x 1-1/4 SlT Fl Hd SS
4	04004-002-20	4	Flatwasher, 3/8, SS
5	04003-804-08	4	Locknut, 3/8-16 Nly Ins SS
6	00118-320-05	1	Chainshield, 5ft SS
	00118-320-06	1	Chainshield, 6ft SS
	00118-320-07	1	Chainshield, 7ft SS
	00118-320-08	1	Chainshield, 8ft SS
7	04003-032-06	A/R	Bolt, 5/16-18 x 3/4 Carriage SS
8	04003-806-13	A/R	Nut, 5/16-18 Ser Flange SS
N/S	04043-054-00	1	Weld, Dragchain, 5ft LPV
	04043-054-01	1	Weld, Dragchain, 6ft LPV
	04043-054-02	1	Weld, Dragchain, 7ft LPV
	04043-054-03	1	Weld, Dragchain, 8ft LPV
N/S	04043-036-00	2	Pin, Connector (Dragchain)
N/S	04043-037-00	2	Pin, Cotter (Dragchain)

PARTS LIST FOR HOPPER (STAINLESS STEEL)

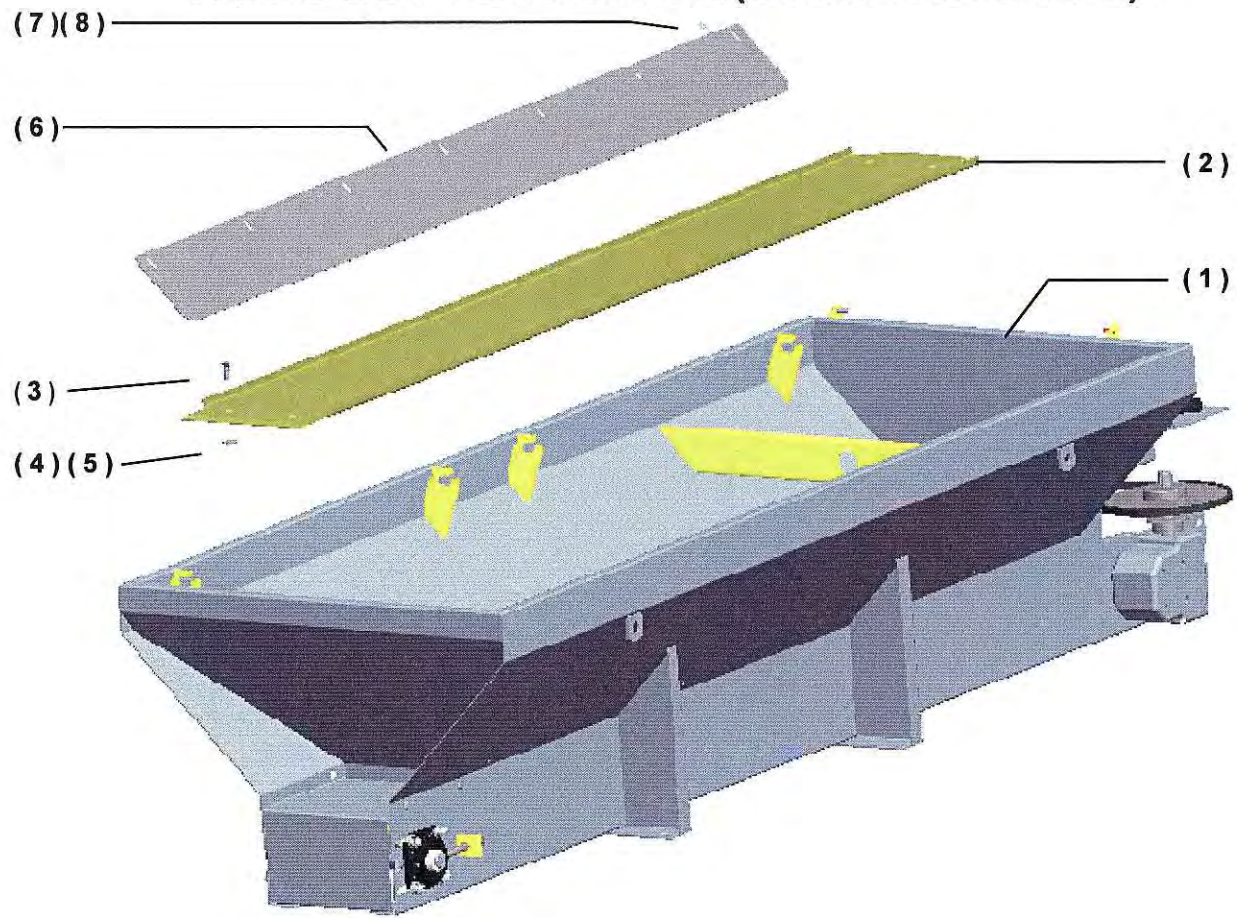

<u>Item</u>	<u>Part Number</u>	<u>Qty.</u>	<u>Description</u>
1	00117-392-15	1	Weld, Hopper, 5ft SS
	00117-392-16	1	Weid, Hopper, 6ft SS
	00117-392-17	1	Weld, Hopper, 7ft SS
	00117-392-18	1	Weld, Hopper, 8ft SS
2	00118-319-15	1	Forming, Floor, 5ft SS
	00118-319-16	1	Forming, Floor, 6ft SS
	00118-319-17	1	Forming, Floor, 7ft SS
	00118-319-18	1	Forming, Floor, 8ft SS
3	04003-018-05	4	Screw, 3/8-16 x 1-1/4 Slit Fl Hd SS
4	04004-002-20	4	Flatwasher, 3/8, SS
5	04003-804-08	4	Locknut, 3/8-16 Nly Ins SS
6	00118-320-05	1	Chainshield, 5ft SS
	00118-320-06	1	Chainshield, 6ft SS
	00118-320-07	1	Chainshield, 7ft SS
	00118-320-08	1	Chainshield, 8ft SS
7	04003-032-06	A/R	Bolt, 5/16-18 x 3/4 Carriage SS
8	04003-806-13	A/R	Nut, 5/16-18 Ser Flange SS
N/S	04043-054-00	1	Weld, Dragchain, 5ft LPV
	04043-054-01	1	Weld, Dragchain, 6ft LPV
	04043-054-02	1	Weld, Dragchain, 7ft LPV
	04043-054-03	1	Weld, Dragchain, 8ft LPV
N/S	04043-036-00	2	Pin, Connector (Dragchain)
N/S	04043-037-00	2	Pin, Cotter (Dragchain)

PARTS LIST FOR FRONT IDLER

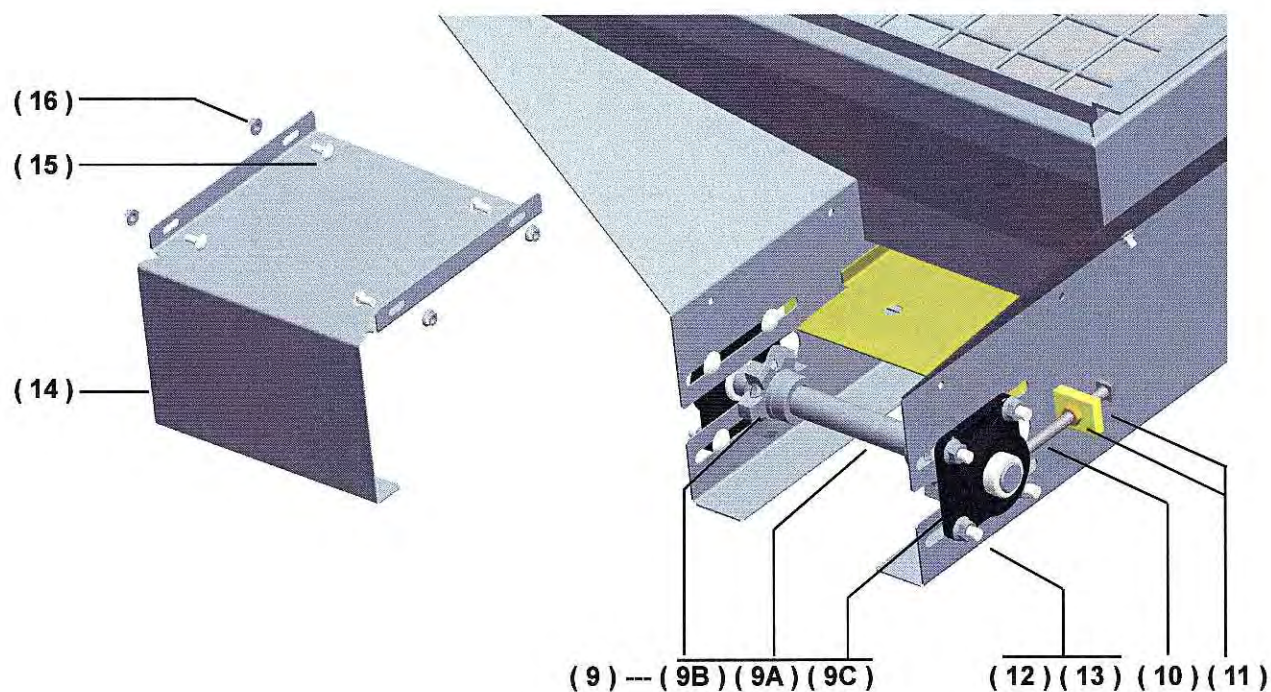

<u>Item</u>	<u>Part Number</u>	<u>Qty.</u>	<u>Description</u>
9	00118-321-00	1	Assy, Idler Shaft
9A	00118-322-00	1	Weld, Idler Shaft
9B	06022-007-00	1	Sprocket
9C	04080-003-00	2	Bearing, 1-1/4
10	04006-004-01	2	Setscrew, 1/2-13 x 5 Sq Hd
	00106-366-00	2	Bolt, 1/2-13 x 6 SS
11	04003-802-05	4	Nut, 1/2-13 Hex Jam
	04003-802-09	4	Nut, 1/2-13 Hex Jam, SS
12	04003-034-06	8	Bolt, 1/2-13 x 1-1/2 Car, Sht Nk
	04003-034-15	8	Bolt, 1/2-13 x 1-1/2 Car, Sht Nk, SS
13	04003-806-03	8	Nut, 1/2-13 Ser Flange
14	00117-400-00	1	Forming, Conveyor Guard, SS
15	04003-032-06	4	Bolt, 5-16 x 3/4 Carriage, SS
16	04003-806-13	4	Nut, 5-16 Ser Flange SS

PARTS LIST FOR CHAIN WIPER

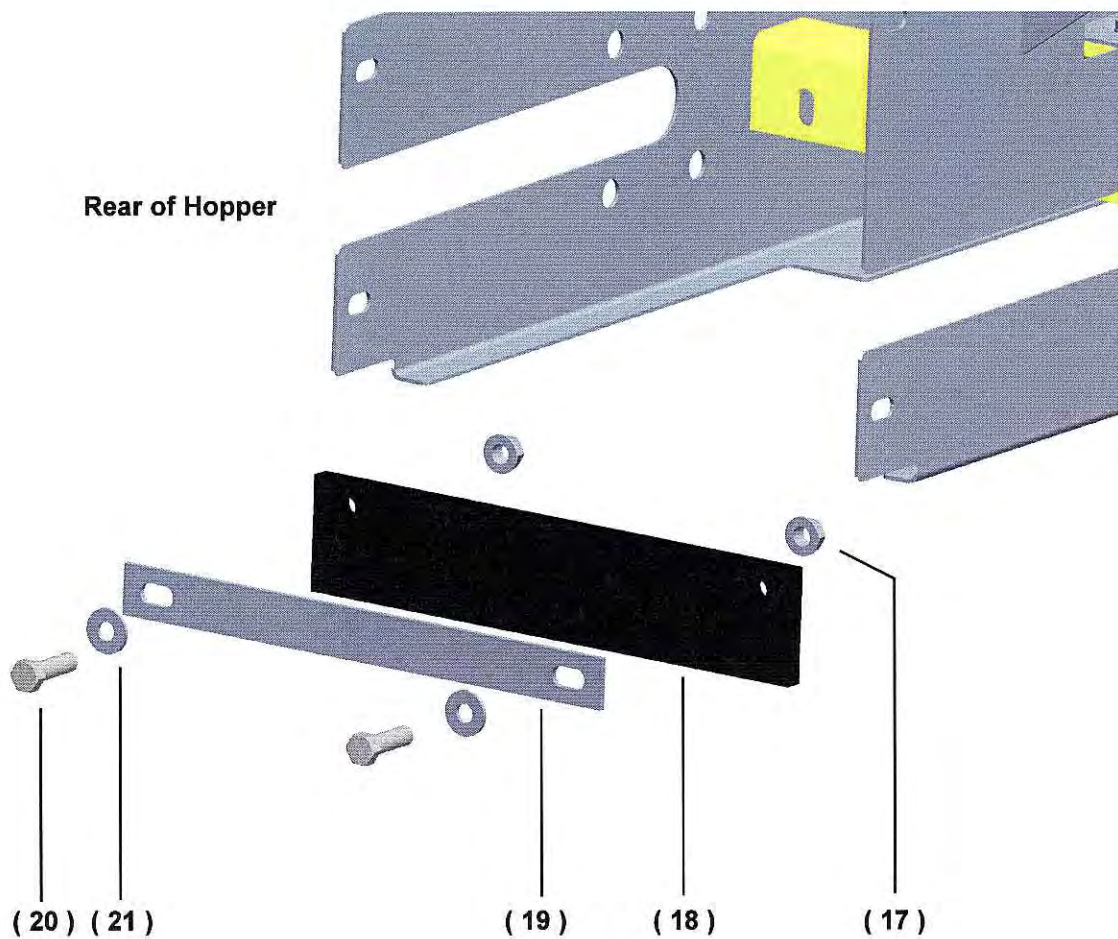

<u>Item</u>	<u>Part Number</u>	<u>Qty.</u>	<u>Description</u>
17	04003-806-02	2	Nut, 3/8-16 Ser Flange
	04003-806-12	2	Nut, 3/8-16 Ser Flange, SS
18	04076-120-00	1	Wiper, Chain
19	00117-305-01	1	Bar, Chain Wiper
	00117-305-02	1	Bar, Chain Wiper, SS
20	04003-003-04	2	Bolt, 3/8-16 x 1-1/4 HH
	04003-003-26	2	Bolt, 3/8-16 x 1-1/4 HH SS
21	04004-002-08	2	Flatwasher, 3/8
	04004-002-20	2	Flatwasher, 3/8 SS

PARTS LIST FOR GEARBOX ASSEMBLY

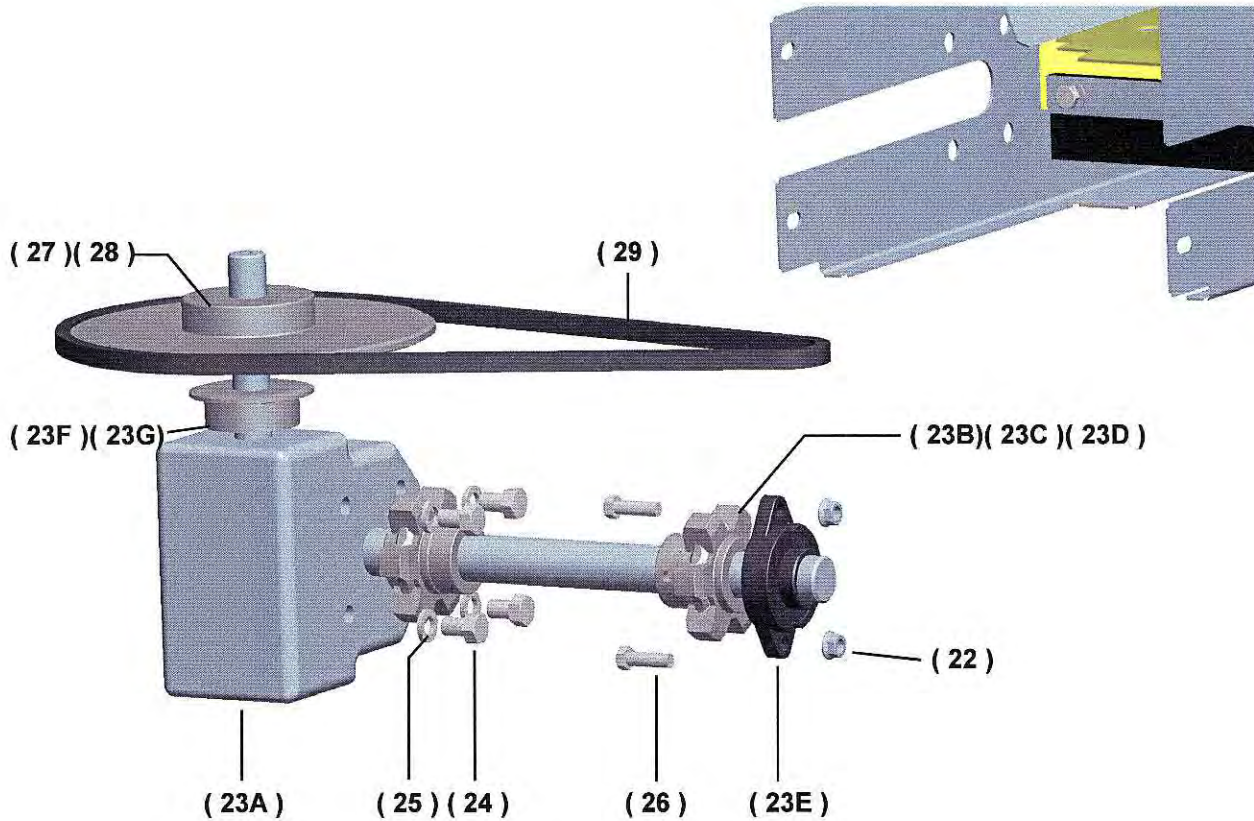

<u>Item</u>	<u>Part Number</u>	<u>Qty.</u>	<u>Description</u>
22	04003-806-02	2	Nut, 3/8-16 Ser Flange
	04003-806-12	2	Nut, 3/8-16 Ser Flange, SS
23	00118-327-00	1	Assy, Gearbox (W/Sprockets & Bearing)
23A	04132-113-00	1	Gearbox, 20:1
23B	06022-008-00	2	Sprocket, 6T, Keyed
23C	04031-010-00	2	Key, 1/4Sq x 2
23D	04007-009-01	4	Setscrew, 3/8-16 x 1/4 Al Hd
23E	04080-005-00	1	Bearing, 1-1/4
23F	04041-086-00	1	Sprocket, 41B19
23G	04031-007-00	1	Key, 1/4Sq x 1
24	04003-005-14	4	Bolt, 1/2-13 x 3/4 HH
	04003-005-56	4	Bolt, 1/2-13 x 3/4 HH, SS
25	04004-001-09	4	Lockwasher, 1/2 Med Split
	04004-001-16	4	Lockwasher, 1/2 Med Split, SS
26	04003-003-04	2	Bolt, 3/8-16 x 1-1/4 HH
	04003-003-26	2	Bolt, 3/8-16 x 1-1/4 HH, SS
27	04041-121-00	1	Sprocket, 40B60
28	04031-008-00	1	Key, 1/4Sq x 1-1/4
29	04046-020-03	1	Chain, Roller W/Co nnecto r Link

PARTS LIST FOR REAR SPROCKET SHIELDS

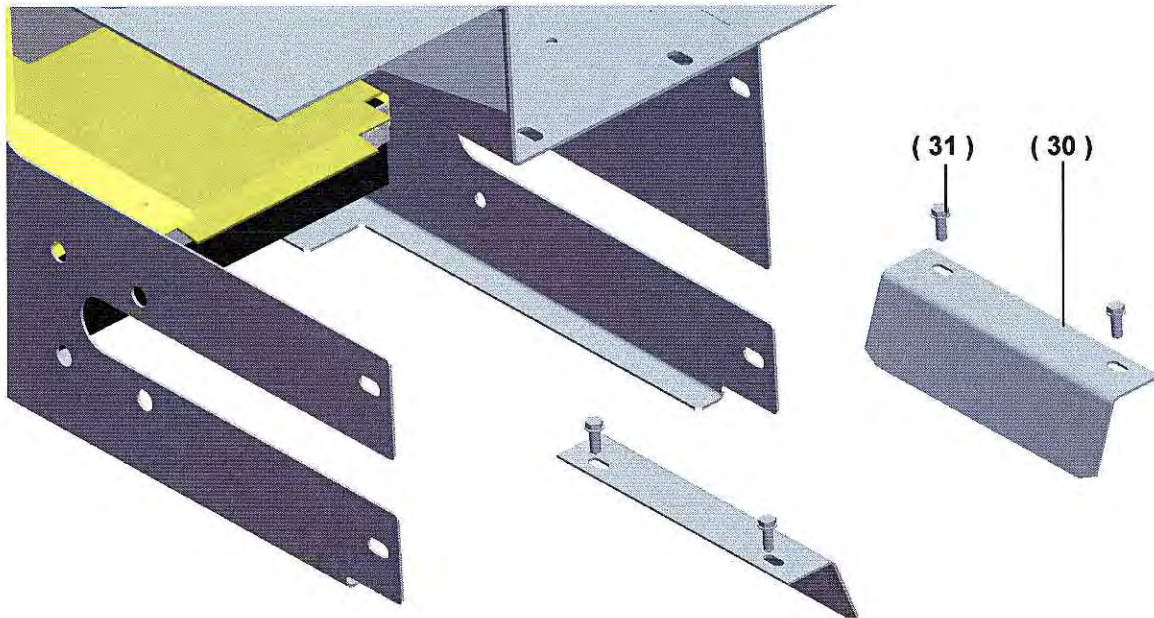

<u>Item</u>	<u>Part Number</u>	<u>Qty.</u>	<u>Description</u>
30	00117-352-01	2	Shield, Sprocket
	00117-352-02	2	Shield, Sprocket SS
31	04002-066-05	4	Screw, 1/4-20 x 3/4 HWH Tek/3 SS

PARTS LIST FOR FEEDGATE

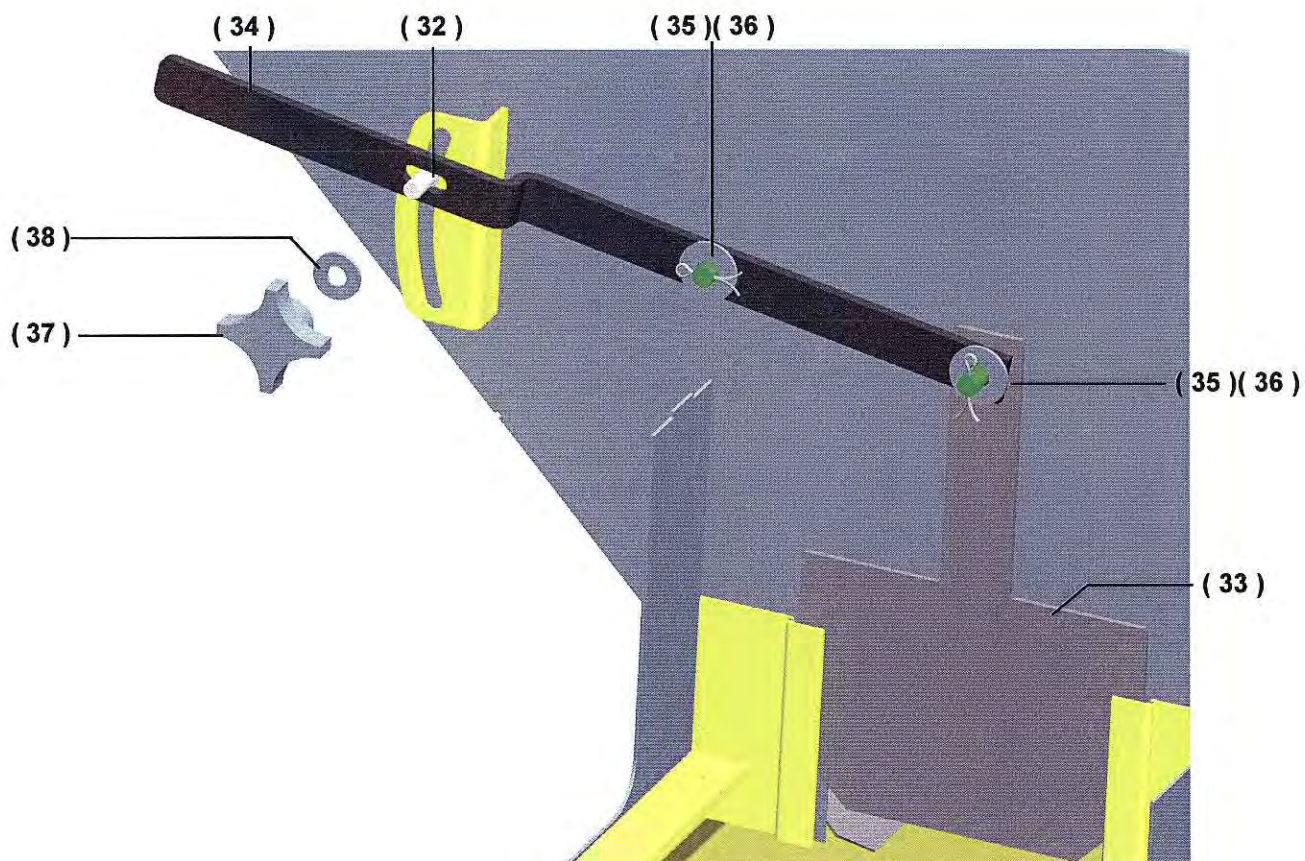

<u>Item</u>	<u>Part Number</u>	<u>Qty.</u>	<u>Description</u>
32	04003-033-02	1	Bolt, 3/8-16 x 1 Carriage
	04003-033-03	1	Bolt, 3/8-16 x 1 Carriage, SS
33	00117-308-01	1	Weld, Feedgate
	00117-308-02	1	Weld, Feedgate SS
34	00117-309-01	1	Handle, Feedgate
	00117-309-02	1	Handle, Feedgate SS
35	04010-002-02	2	Pin, 3/32 x 1 Cotter SS
36	04004-002-32	2	Flatwasher, 7/16 SS
37	04624-001-01	1	Knob, Hand
38	04004-002-20	1	Flatwahrer, 3/8 SS

PARTS LIST FOR ELECTRIC MOTOR

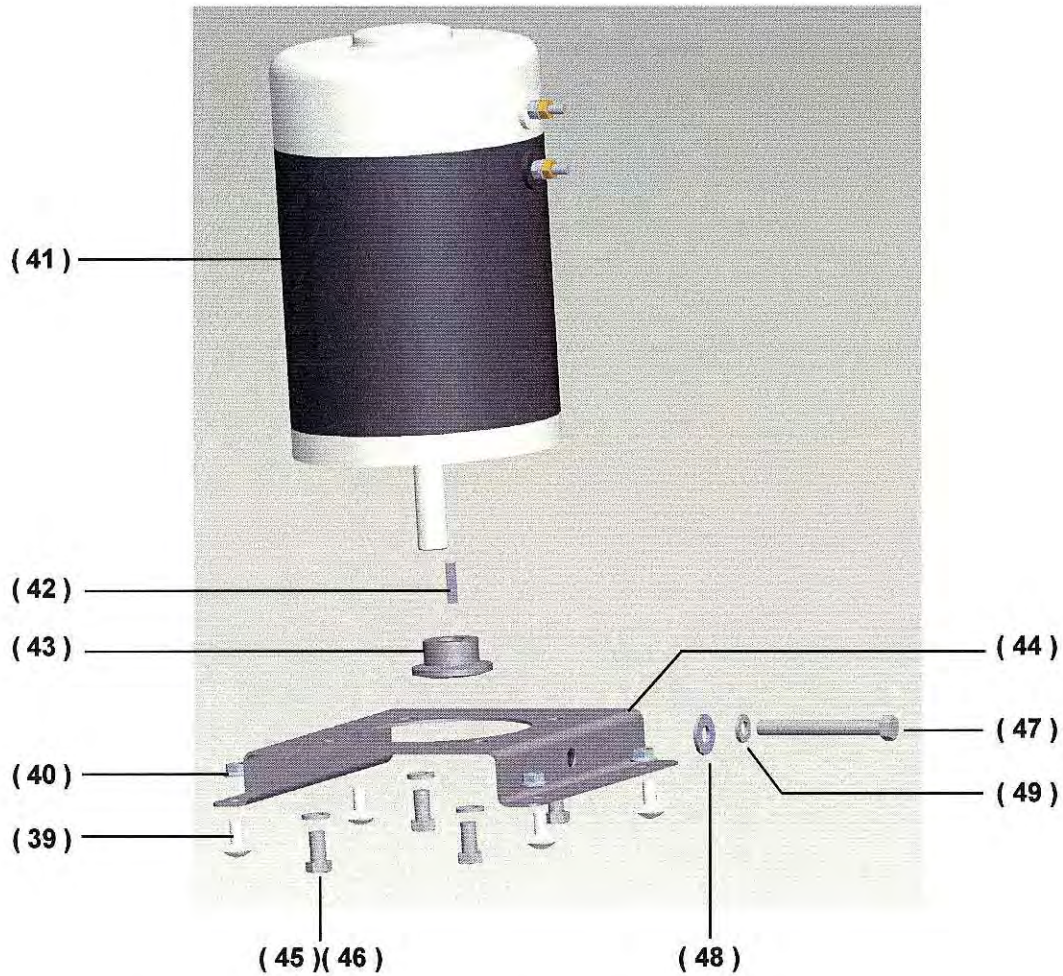

<u>Item</u>	<u>Part Number</u>	<u>Qty.</u>	<u>Description</u>
39	04003-032-06	4	Bolt, 5/16-18 x 3/4 Car SS
40	04003-806-13	4	Nut, 5/16-18 Ser Flange SS
41	04150-047-00	1	Motor, Electric
42	04031-009-00	1	Key, 3/16Sq x 1
43	04041-120-00	1	Sprocket, 40B11
44	00118-777-01	1	Weld, Motor Mounting Plate
	00118-777-02	1	Weld, Motor Mounting Plate SS
45	04003-003-01	4	Bolt, 3/8-16 x 3/4 HH
	04003-003-24	4	Bolt, 3/8-16 x 3/4 HH, SS
46	04004-001-07	4	Lockwasher, 3/8 Med Split
	04004-001-14	4	Lockwasher, 3/8 Med Split, SS
47	04003-003-63	1	Bolt, 3/8-16 x 3-1/2 HH SS
48	04004-002-20	1	Flatwasher, 3/8 SS
49	04004-001-14	1	Lockwasher, 3/8 Med Split SS

PARTS LIST FOR SHROUD

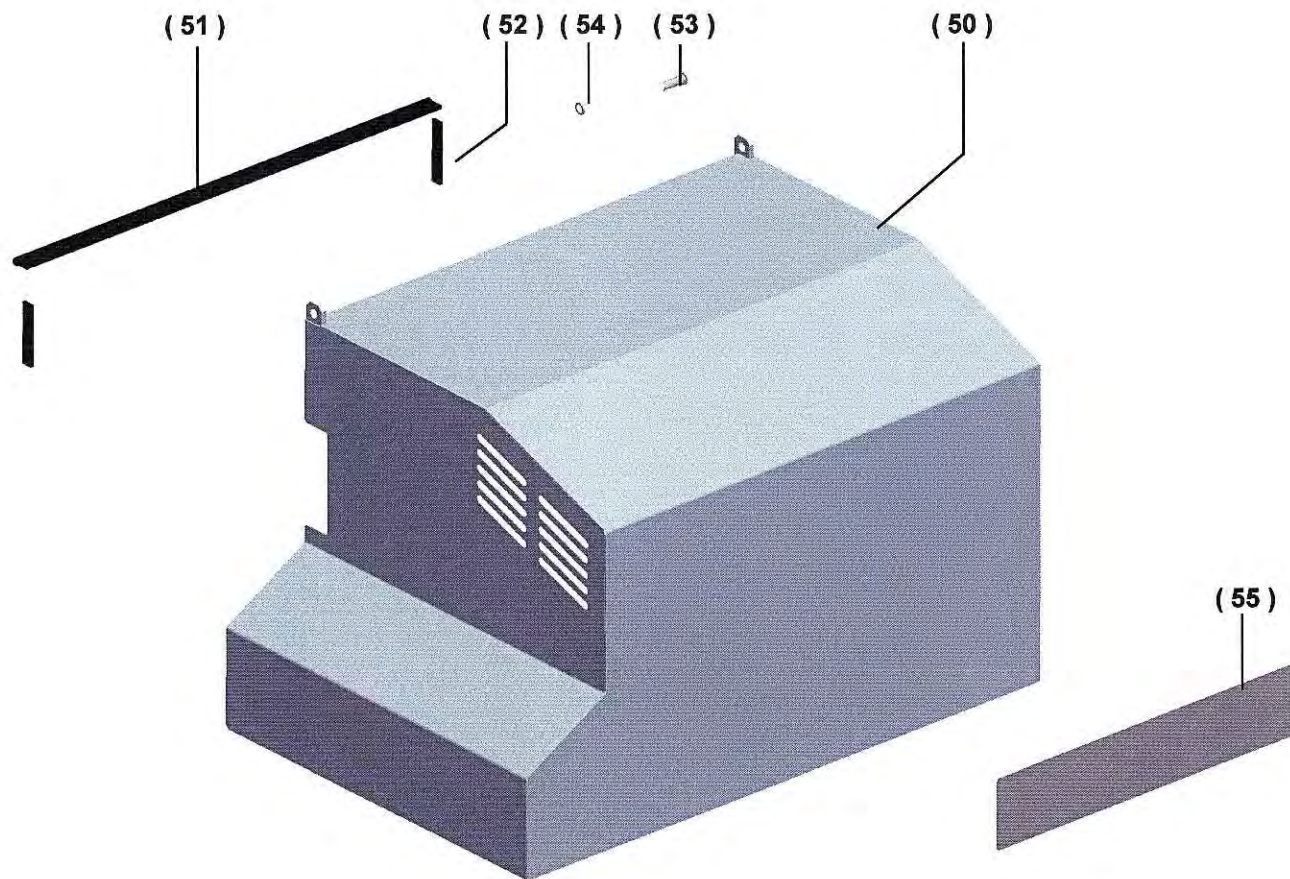

<u>Item</u>	<u>Part Number</u>	<u>Qty.</u>	<u>Description</u>
50	00117-312-01	1	Weld, Shroud
	00117-312-02	1	Weld, Shroud, SS
51	04093-031-00	1	Trim, Seal
52	04093-021-00	A/R	Trim
53	04003-003-26	1	Bolt, 3/8-16 x 1-1/4 HH, SS
54	04003-804-08	1	Locknut, 3/8-16 Nylon Insert, SS
55	04049-002-00	1	Decal, Logo

A/R = AS REQUIRED

PARTS LIST FOR SPINNER ASSEMBLY

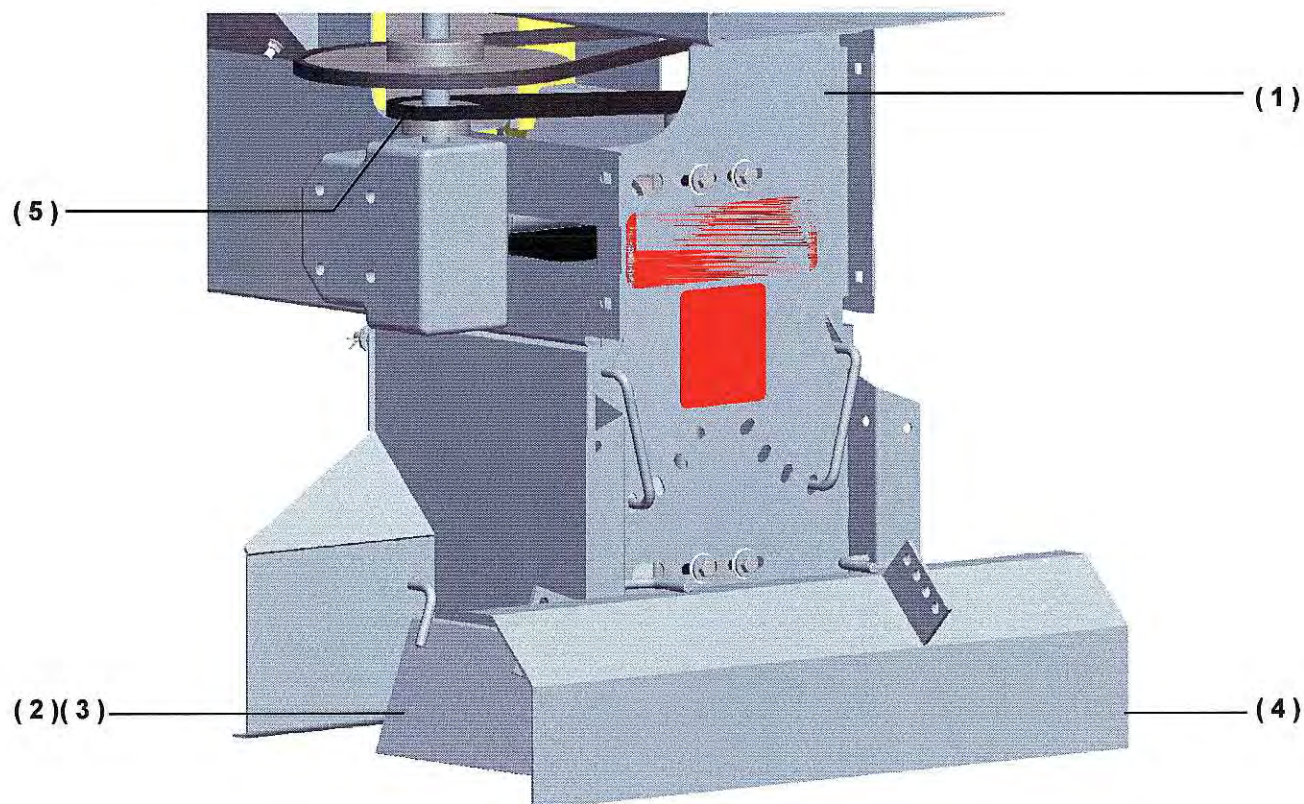

<u>Item</u>	<u>Part Number</u>	<u>Qty.</u>	<u>Description</u>
1	00117-316-01	1	Weld, Spinner Frame
	00117-316-02	1	Weld, Spinner Frame SS
2	00104-810-00	1	Weld, Baffle RH
	00104-810-01	1	Weld, Baffle RH SS
3	00104-811-00	1	Weld, Baffle LH
	00104-811-01	1	Weld, Baffle LH SS
4	00104-835-00	1	Weld, Baffle Rear
	00104-835-01	1	Weld, Baffle Rear SS
5	04046-016-07	1	Chain, Roller
N/S	04003-003-20	6	Bolt, 3/8-16 x 1 HH SS
N/S	04003-806-12	6	Nut, 3/8-16 Ser. Flange SS
N/S	00115-150-00	3	Bar, Link (Baffle) SS
N/S	04011-001-01	9	Keeper, Hairpin Small
N/S	04011-001-05	9	Keeper, Hairpin Small, SS

PARTS LIST FOR SPINNER SHAFT

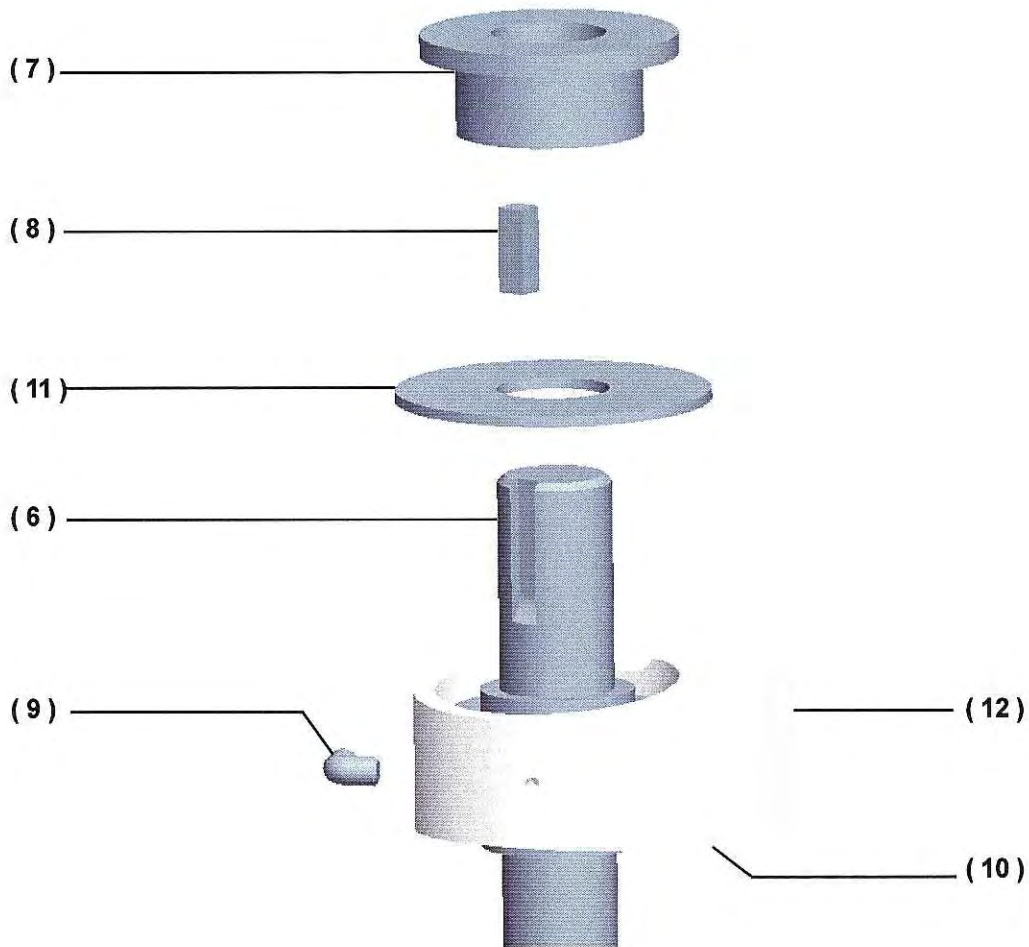

<u>Item</u>	<u>Part Number</u>	<u>Qty.</u>	<u>Description</u>
6	00117-340-00	1	Shaft, Spinner LPV
7	04041-085-00	1	Sprocket, 41B13
8	04031-026-00	1	Key, 1/4Sq x 3/4
9	04015-007-00	1	Fitting, Zerk 90 Deg.
10	04080-079-00	2	Bearing
11	04004-008-01	2	Washer, Flat, Rubber
12	00117-314-03	2	Block, Spacer, Bearing

PARTS LIST FOR SPINNER SHAFT

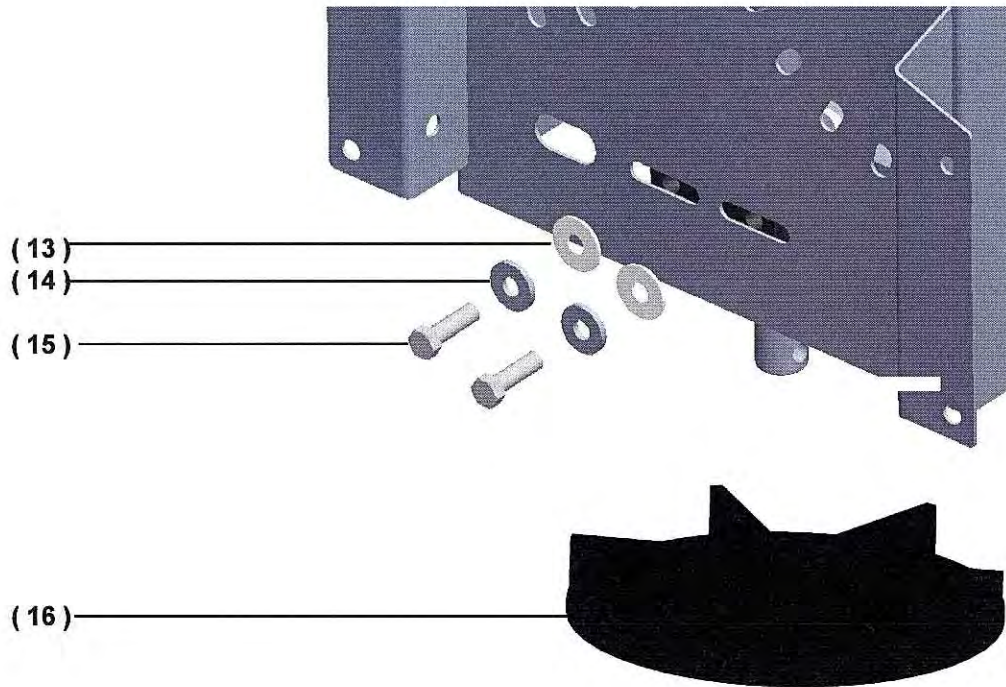

<u>Item</u>	<u>Part Number</u>	<u>Qty.</u>	<u>Description</u>
13	04004-004-02	4	Lockwasher, 3/8 Int/Ext TH SS
14	04004-002-08	4	Flatwasher, 3/8
	04004-002-20	4	Flatwasher, 3/8 SS
15	04003-003-04	4	Bolt, 3/8 x 1-1/4 HH
	04003-003-26	4	Bolt, 3/8-16 x 1-1/4 HH SS
16	04622-033-00	1	Disc, Poly Spinner 13"
N/S	04003-003-21	1	Bolt, 3/8-16 x 2-1/2 HH SS
N/S	04003-804-08	1	Nut, 3/8-16 Nylon Lock, SS

N/S = Not Shown

PARTS LIST FOR INTERNAL BAFFLE

SPINNER FRONT

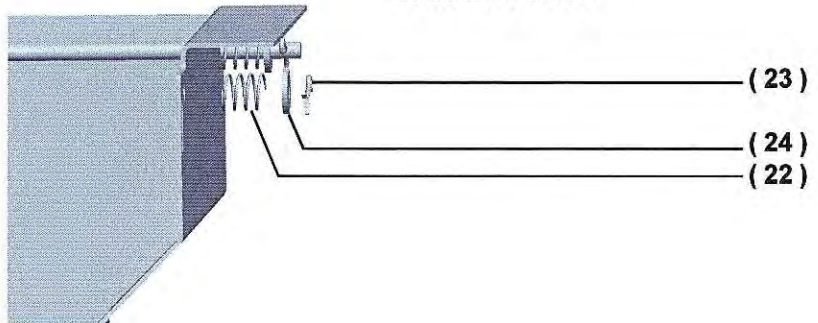

SPINNER REAR

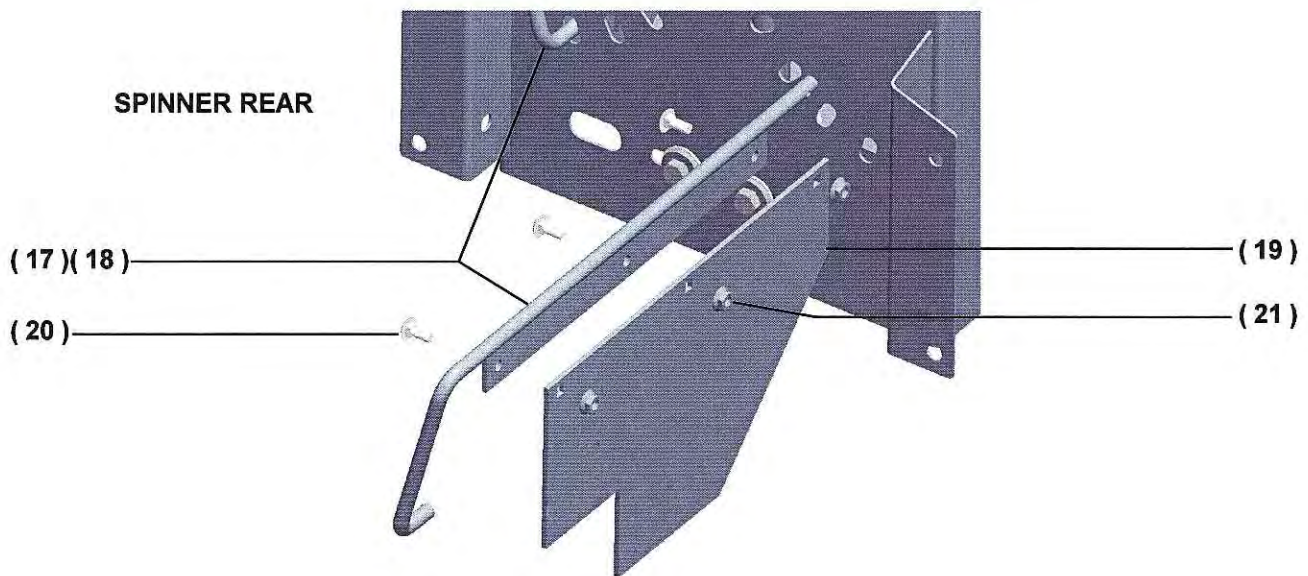

<u>Item</u>	<u>Part Number</u>	<u>Qty.</u>	<u>Description</u>
17	00115-580-01	1	Weld, Handle LH
	00115-580-02	1	Weld, Handle LH SS
18	00115-545-01	1	Weld, Handle RH
	00115-545-02	1	Weld, Handle RH SS
19	00117-315-01	2	Plate, Baffle
	00117-315-02	2	Plate, Baffle SS
20	04003-031-07	6	Bolt, 1/4-20 x 5/8 Carriage SS
21	04003-806-15	6	Nut, 1/4-20 Ser. Flange SS
22	04091-028-00	2	Spring, Compression
23	04010-016-01	2	Pin, 1/8 x 1 Cotter SS
24	04004-002-08	2	Flatwasher, 3/8
N/S	00001-774-00	1	K, V & PV Safety Decal

N/S = Not Shown

PARTS LIST FOR SCREEN

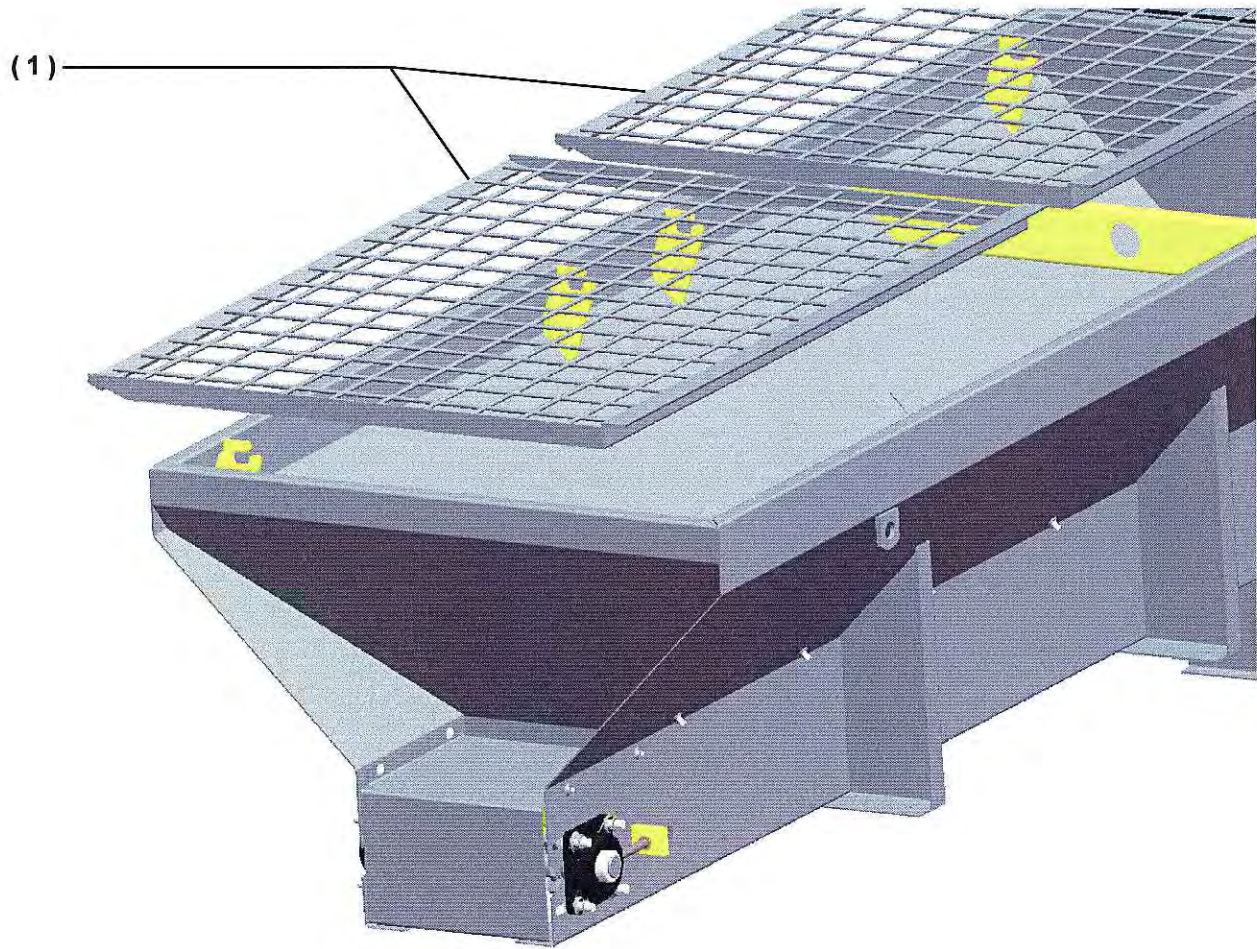

<u>Item</u>	<u>Part Number</u>	<u>Qty.</u>	<u>Description</u>
1	00117-361-01	A/R	Weld, Screen, 3 ft.
	00117-361-02	A/R	Weld, Screen, 4 ft.
	00117-361-03	A/R	Weld, Screen, 5 ft.

A/R = As Required

NAME PLATE INFORMATION

- ☐ When ordering parts or requesting information or assistance, always include the information listed below.
- ☐ The Model Number and Serial Number for the Spreader is shown on the name plate.
- ☐ The space below is provided as a convenient place to record these numbers; just fill in the blanks.

MODEL NUMBER _____

SERIAL NUMBER _____

DATE PURCHASED _____

PURCHASED FROM _____

DEALER'S SERVICE DEPARTMENT PHONE NUMBER _____

EXPLANATION OF SERIAL NUMBER DECAL

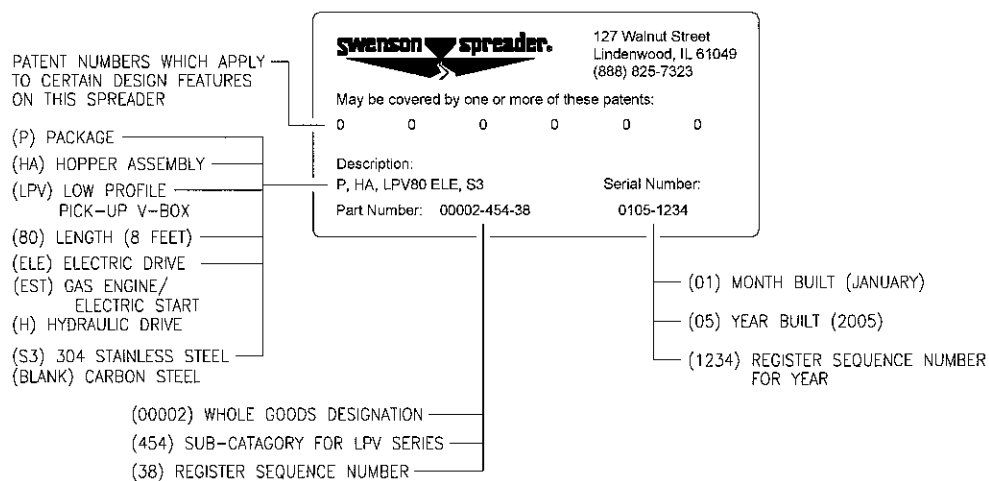

Z:\00111\00111-389-00RTJPD

CALL YOUR AUTHORIZED SWENSON SPREADER DEALER FOR PARTS AND SERVICE

SWENSON SPREADER (815) 393-4455

TOLL FREE (888) 825-7323

FAX (866) 310-0300

email: swensonsales@swensonspreader.com



Effective 5/1/99

Dealers have the responsibility of calling to the attention of their customers the following warranty prior to acceptance of an order from that customer for any SWENSON® product.

WARRANTY

SWENSON warrants to the original purchaser for use that, if any part of the product proves to be defective in material or workmanship within one year from the date of original installation, and is returned to SWENSON within 30 days after such defect is discovered, SWENSON will (at our option) either replace or repair said part. This warranty does not apply to damage resulting from misuse, neglect, accident or improper installation or maintenance. Said part will not be considered defective if it substantially fulfills the performance specifications. THE FOREGOING WARRANTY IS EXCLUSIVE AND IN LIEU OF ALL OTHER WARRANTIES OF MERCHANTABILITY, FITNESS FOR PURPOSE AND OF ANY OTHER TYPE, WHETHER EXPRESS OR IMPLIED. SWENSON® neither assumes nor authorizes anyone to assume for it any other obligation or liability in connection with said part and will not be liable for consequential damages.

All gasoline engines and hydraulic pumps are warranted by their manufacturer and not by Swenson Spreader LLC. Electrical or hydraulic components are not to be disassembled without the express written permission of Swenson Spreader LLC. Defective parts returned to Swenson Spreader LLC must be accompanied by the following information: spreader model, serial number, date installed and dealer from whom purchased.

Purchaser accepts these terms and warranty limitations unless the product is returned within fifteen days for full refund of purchase price.



SWENSON SPREADER LLC
P.O. BOX 127
LINDENWOOD, ILLINOIS 61049-0127

PHONE: (815)393-4455
TOLL FREE: (888)825-7323
SALES & SERVICE FAX: (866)310-0300

email: swensonsales@swensonspreader.com
website: www.swensonspreader.com

**IMPORTANT
INFORMATION
ENCLOSED**

